

# Nugget 500 Series Valves

5/2 and 5/3 directional control spool valves

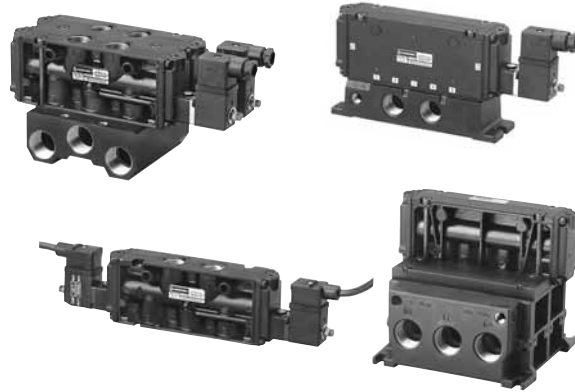

Long lasting spool design

High flow compact valves

Four mounting styles: inline, fixed length manifolds, single subbase, or subbase valves attached to manifolding subbases

Wide range of operators available

Two functional types: available in 5/2, and 5/3 configurations

## Technical Data

Medium:

Filtered, lubricated or non-lubricated, compressed air or vacuum

Operation:

Spool valve air pilot actuated

Mounting:

Inline, fixed length manifold, single subbase, and manifolding subbase

Port Sizes:

3/8", 1/2", or 3/4", ISO G or PTF

Operating Pressure:

Maximum 150 psig (10.3 bar).

Flow Characteristics:

| Port         | Cv  | l/min | scfm |
|--------------|-----|-------|------|
| 3/8" Inline  | 4.0 | 4250  | 150  |
| 1/2" Inline  | 5.0 | 5150  | 180  |
| 3/4" Inline  | 5.6 | 6000  | 210  |
| 1/2" Subbase | 4.7 | 5300  | 190  |

Operating Temperature

Solenoid Operated Valves:

-20° to 120°F (-29° to 50°C)

Air Operated Valves:

-20° to 160°F (-29° to 71°C)

\*Consult our Technical Service for use below 36°F (2°C)

Materials

Valve Body: Aluminum

Spool: Aluminum

Elastomers: Nitrile

Solenoid Operator Base: PPS plastic

Operator Housing: Zinc

Speed Control Materials

Body: Zinc

Adjusting Screw: Brass

Elastomers: Nitrile

Subbase Materials

Fixed Length Manifolds: Aluminum

Single and Manifolding Subbase: Aluminum

End Plate: Zinc

Elastomers: Nitrile

## Inline Valves

| Part Number    | Description     | Type | Port Size | Pilot Pressure psig (bar) | Weight lbs. (kg) | Repair Kit |
|----------------|-----------------|------|-----------|---------------------------|------------------|------------|
| MN01CGA35-AJJA | Single Solenoid | 5/2  | 1/2" PTF  | 40 - 150 (2.8 - 10.3)     | 1.42 (.65)       | 54677-50   |
| MN02CGA35-AKJA | Single Solenoid | 5/2  | 1/2" PTF  | 40 - 150 (2.8 - 10.3)     | 1.42 (.65)       | 54677-51   |
| MN01CGA25-AJJA | Double Solenoid | 5/2  | 1/2" PTF  | 20 - 150 (1.4 - 10.3)     | 1.71 (.78)       | 54677-50   |
| MN02CGA25-AJJA | Double Solenoid | 5/2  | 1/2" PTF  | 20 - 150 (1.4 - 10.3)     | 1.71 (.78)       | 54677-51   |
| MN01CGA25-BJJA | Double Solenoid | 5/2  | 1/2" PTF  | 30 - 150 (2.1 - 10.3)     | 1.99 (.90)       | 54677-50   |
| MN02CGA25-BJJA | Double Solenoid | 5/2  | 1/2" PTF  | 30 - 150 (2.1 - 10.3)     | 1.99 (.90)       | 54677-51   |
| MN03CGA25-FJJA | Double Solenoid | 5/3  | 1/2" PTF  | 40 - 150 (2.8 - 10.3)     | 1.99 (.90)       | 54677-52   |
| MN04CGA25-FJJA | Double Solenoid | 5/3  | 1/2" PTF  | 40 - 150 (2.8 - 10.3)     | 1.99 (.90)       | 54677-53   |
| MN05CGA25-FJJA | Double Solenoid | 5/3  | 1/2" PTF  | 20 - 150 (1.4 - 10.3)     | 1.99 (.90)       | 54677-54   |
| MN06CGA25-FJJA | Double Solenoid | 5/3  | 1/2" PTF  | 20 - 150 (1.4 - 10.3)     | 1.99 (.90)       | 54677-55   |
| MN01CGA33-A000 | Single Air      | 5/2  | 1/2" PTF  | 40 - 150 (2.8 - 10.3)     | 1.16 (.53)       | 54677-50   |
| MN02CGA33-A000 | Single Air      | 5/2  | 1/2" PTF  | 40 - 150 (2.8 - 10.3)     | 1.16 (.53)       | 54677-51   |
| MN01CGA23-A000 | Double Air      | 5/2  | 1/2" PTF  | 20 - 150 (1.4 - 10.3)     | 1.16 (.53)       | 54677-50   |
| MN02CGA23-A000 | Double Air      | 5/2  | 1/2" PTF  | 20 - 150 (1.4 - 10.3)     | 1.16 (.53)       | 54677-51   |
| MN01CGA23-B000 | Double Air      | 5/2  | 1/2" PTF  | 30 - 150 (2.1 - 10.3)     | 1.42 (.65)       | 54677-50   |
| MN02CGA23-B000 | Double Air      | 5/2  | 1/2" PTF  | 30 - 150 (2.1 - 10.3)     | 1.42 (.65)       | 54677-51   |
| MN03CGA23-F000 | Double Air      | 5/3  | 1/2" PTF  | 40 - 150 (2.8 - 10.3)     | 1.42 (.65)       | 54677-52   |
| MN04CGA23-F000 | Double Air      | 5/3  | 1/2" PTF  | 40 - 150 (2.8 - 10.3)     | 1.42 (.65)       | 54677-53   |
| MN05CGA23-F000 | Double Air      | 5/3  | 1/2" PTF  | 20 - 150 (1.4 - 10.3)     | 1.42 (.65)       | 54677-54   |

## Valves with Manifolding Subbases

| Part Number    | Description     | Type | Port Size | Pilot Pressure psig (bar) | Weight lbs. (kg) | Repair Kit |
|----------------|-----------------|------|-----------|---------------------------|------------------|------------|
| MN01GGA35-AJJA | Single Solenoid | 5/2  | 1/2" PTF  | 40 - 150 (2.8 - 10.3)     | 2.37 (1.08)      | 54677-50   |
| MN02GGA35-AKJA | Single Solenoid | 5/2  | 1/2" PTF  | 40 - 150 (2.8 - 10.3)     | 2.37 (1.08)      | 54677-51   |
| MN01GGA25-AJJA | Double Solenoid | 5/2  | 1/2" PTF  | 20 - 150 (1.4 - 10.3)     | 2.64 (1.20)      | 54677-50   |
| MN02GGA25-AJJA | Double Solenoid | 5/2  | 1/2" PTF  | 20 - 150 (1.4 - 10.3)     | 2.64 (1.20)      | 54677-51   |
| MN01GGA25-BJJA | Double Solenoid | 5/2  | 1/2" PTF  | 30 - 150 (2.1 - 10.3)     | 2.94 (1.34)      | 54677-50   |
| MN02GGA25-BJJA | Double Solenoid | 5/2  | 1/2" PTF  | 30 - 150 (2.1 - 10.3)     | 2.94 (1.34)      | 54677-51   |
| MN03GGA25-FJJA | Double Solenoid | 5/3  | 1/2" PTF  | 40 - 150 (2.8 - 10.3)     | 2.94 (1.34)      | 54677-52   |
| MN04GGA25-FJJA | Double Solenoid | 5/3  | 1/2" PTF  | 40 - 150 (2.8 - 10.3)     | 2.94 (1.34)      | 54677-53   |
| MN05GGA25-FJJA | Double Solenoid | 5/3  | 1/2" PTF  | 20 - 150 (1.4 - 10.3)     | 2.94 (1.34)      | 54677-54   |
| MN06GGA25-FJJA | Double Solenoid | 5/3  | 1/2" PTF  | 20 - 150 (1.4 - 10.3)     | 2.94 (1.34)      | 54677-55   |
| MN01GGA33-A000 | Single Air      | 5/2  | 1/2" PTF  | 40 - 150 (2.8 - 10.3)     | 2.09 (.95)       | 54677-50   |
| MN02GGA33-A000 | Single Air      | 5/2  | 1/2" PTF  | 40 - 150 (2.8 - 10.3)     | 2.09 (.95)       | 54677-51   |
| MN01GGA23-A000 | Double Air      | 5/2  | 1/2" PTF  | 20 - 150 (1.4 - 10.3)     | 2.09 (.95)       | 54677-50   |
| MN02GGA23-A000 | Double Air      | 5/2  | 1/2" PTF  | 20 - 150 (1.4 - 10.3)     | 2.09 (.95)       | 54677-51   |
| MN01GGA23-B000 | Double Air      | 5/2  | 1/2" PTF  | 30 - 150 (2.1 - 10.3)     | 2.37 (1.08)      | 54677-50   |
| MN02GGA23-B000 | Double Air      | 5/2  | 1/2" PTF  | 30 - 150 (2.1 - 10.3)     | 2.37 (1.08)      | 54677-51   |
| MN03GGA23-F000 | Double Air      | 5/3  | 1/2" PTF  | 40 - 150 (2.8 - 10.3)     | 2.37 (1.08)      | 54677-52   |
| MN04GGA23-F000 | Double Air      | 5/3  | 1/2" PTF  | 40 - 150 (2.8 - 10.3)     | 2.37 (1.08)      | 54677-53   |
| MN05GGA23-F000 | Double Air      | 5/3  | 1/2" PTF  | 20 - 150 (1.4 - 10.3)     | 2.37 (1.08)      | 54677-54   |
| MN06GGA23-F000 | Double Air      | 5/3  | 1/2" PTF  | 20 - 150 (1.4 - 10.3)     | 2.37 (1.08)      | 54677-55   |

# Nugget 500 Series Valves

5/2 and 5/3 directional control spool valves

## Valves on a Single Subbase

| Part Number    | Description     | Type | Port Size | Pilot Pressure psig (bar) | Weight lbs. (kg) | Repair Kit |
|----------------|-----------------|------|-----------|---------------------------|------------------|------------|
| MN01EGA35-AJJA | Single Solenoid | 5/2  | 1/2" PTF  | 40 - 150 (2.8 - 10.3)     | 2.08 (.95)       | 54677-50   |
| MN02EGA35-AKJA | Single Solenoid | 5/2  | 1/2" PTF  | 40 - 150 (2.8 - 10.3)     | 2.08 (.95)       | 54677-51   |
| MN01EGA25-AJJA | Double Solenoid | 5/2  | 1/2" PTF  | 20 - 150 (1.4 - 10.3)     | 2.33 (1.06)      | 54677-50   |
| MN02EGA25-AJJA | Double Solenoid | 5/2  | 1/2" PTF  | 20 - 150 (1.4 - 10.3)     | 2.33 (1.06)      | 54677-51   |
| MN01EGA25-BJJA | Double Solenoid | 5/2  | 1/2" PTF  | 30 - 150 (2.1 - 10.3)     | 2.62 (1.19)      | 54677-50   |
| MN02EGA25-BJJA | Double Solenoid | 5/2  | 1/2" PTF  | 30 - 150 (2.1 - 10.3)     | 2.62 (1.19)      | 54677-51   |
| MN03EGA25-FJJA | Double Solenoid | 5/3  | 1/2" PTF  | 40 - 150 (2.8 - 10.3)     | 2.62 (1.19)      | 54677-52   |
| MN04EGA25-FJJA | Double Solenoid | 5/3  | 1/2" PTF  | 40 - 150 (2.8 - 10.3)     | 2.62 (1.19)      | 54677-53   |
| MN05EGA25-FJJA | Double Solenoid | 5/3  | 1/2" PTF  | 20 - 150 (1.4 - 10.3)     | 2.62 (1.19)      | 54677-54   |
| MN06EGA25-FJJA | Double Solenoid | 5/3  | 1/2" PTF  | 20 - 150 (1.4 - 10.3)     | 2.62 (1.19)      | 54677-55   |
| MN01EGA33-A000 | Single Air      | 5/2  | 1/2" PTF  | 40 - 150 (2.8 - 10.3)     | 1.81 (.82)       | 54677-50   |
| MN02EGA33-A000 | Single Air      | 5/2  | 1/2" PTF  | 40 - 150 (2.8 - 10.3)     | 1.81 (.82)       | 54677-51   |
| MN01EGA23-A000 | Double Air      | 5/2  | 1/2" PTF  | 20 - 150 (1.4 - 10.3)     | 1.81 (.82)       | 54677-50   |
| MN02EGA23-A000 | Double Air      | 5/2  | 1/2" PTF  | 20 - 150 (1.4 - 10.3)     | 1.81 (.82)       | 54677-51   |
| MN01EGA23-B000 | Double Air      | 5/2  | 1/2" PTF  | 30 - 150 (2.1 - 10.3)     | 2.09 (.95)       | 54677-50   |
| MN02EGA23-B000 | Double Air      | 5/2  | 1/2" PTF  | 30 - 150 (2.1 - 10.3)     | 2.09 (.95)       | 54677-51   |
| MN03EGA23-F000 | Double Air      | 5/3  | 1/2" PTF  | 40 - 150 (2.8 - 10.3)     | 2.09 (.95)       | 54677-52   |
| MN04EGA23-F000 | Double Air      | 5/3  | 1/2" PTF  | 40 - 150 (2.8 - 10.3)     | 2.09 (.95)       | 54677-53   |
| MN05EGA23-F000 | Double Air      | 5/3  | 1/2" PTF  | 20 - 150 (1.4 - 10.3)     | 2.09 (.95)       | 54677-54   |
| MN06EGA23-F000 | Double Air      | 5/3  | 1/2" PTF  | 20 - 150 (1.4 - 10.3)     | 2.09 (.95)       | 54677-55   |

### Inline Valve Dimensions

Dimensions in inches (mm)

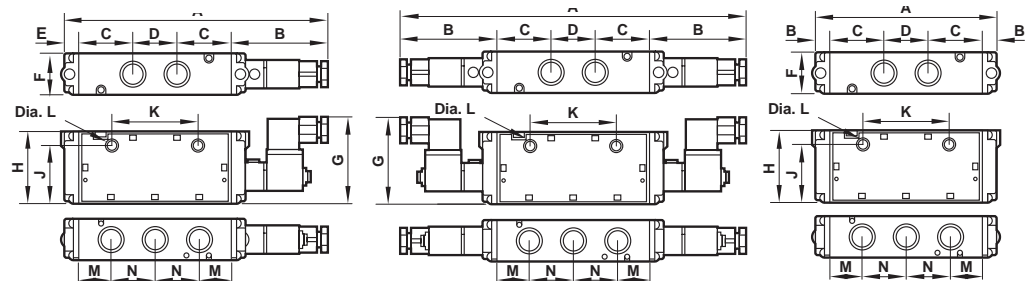

Note: 4 mm hex key drive required for mounting screw removal/replacement

| Valve  | A           | B          | C         | D         | E         | F         | G         | H         | J         | K         | L        | M         | N         |
|--|-------------|------------|-----------|-----------|-----------|-----------|-----------|-----------|-----------|-----------|----------|-----------|-----------|
| Solenoid Pilot Operator —<br>5/2 Nondetent Single Solenoid*                    | 9.46 (240)  | 3.53 (90)  | 1.91 (49) | 1.48 (38) | 0.63 (16) | 1.44(37)  | 2.71 (69) | 2.44 (62) | 1.94 (49) | 3.00 (76) | 0.27 (7) | 1.17 (30) | 1.48 (38) |
| Double Solenoid  | 12.36 (314) | 3.53 (90)  | 1.91 (49) | 1.48 (38) | —         | 1.44 (37) | 2.71 (69) | 2.44 (62) | 1.94 (49) | 3.00 (76) | 0.27 (7) | 1.17 (30) | 1.48 (38) |
| Solenoid Pilot Operator — 5/2 Detent or<br>5/3 Spring Centered Double Solenoid | 13.30 (338) | 4.00 (102) | 1.91 (49) | 1.48 (38) | —         | 1.44 (37) | 2.71 (69) | 2.44 (62) | 1.94 (49) | 3.00 (76) | 0.27 (7) | 1.17 (30) | 1.48 (38) |
| Air Pilot Operator —<br>5/2 Nondetent Single Air*                              | 6.56 (167)  | 0.63 (16)  | 1.91 (49) | 1.48 (38) | 0.63 (16) | 1.44 (37) | —         | 2.44 (62) | 1.94 (49) | 3.00 (76) | 0.27 (7) | 1.17 (30) | 1.48 (38) |
| Double Air   | 6.56 (7)    | 0.63 (16)  | 1.91 (49) | 1.48 (38) | —         | 1.44 (37) | —         | 2.44 (62) | 1.94 (49) | 3.00 (76) | 0.27 (7) | 1.17 (30) | 1.48 (38) |
| Air Pilot Operator — 5/2 Detent or<br>5/3 Spring Centered Double Air           | 7.50 (191)  | 1.10 (28)  | 1.91 (49) | 1.48 (38) | —         | 1.44 (37) | —         | 2.44 (62) | 1.94 (49) | 3.00 (76) | 0.27 (7) | 1.17 (30) | 1.48 (38) |

\*With air-assisted spring return, spring return or integral air return

# Nugget 500 Series Valves

5/2 and 5/3 directional control spool valves

| Fixed length blanking Kit | Single & manifolding subbase blanking kit | Dual sandwich speed control kit | Intermediate supply/exhaust block | End plate kit |
|---------------------------|---|---------------------------------|-----------------------------------|---------------|
|---------------------------|---|---------------------------------|-----------------------------------|---------------|

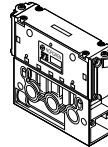
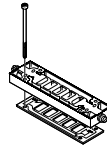
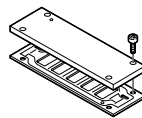
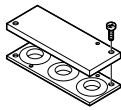

|          |          |          |                     |          |
|----------|----------|----------|---------------------|----------|
| 54689-50 | 54689-51 | 13336-60 | 1/2" PTF 54693-50   | 13338-50 |
|          |          |          | 1/2" ISO G 54693-51 |          |

| Single subbase for subbase valve | Manifolding subbase for subbase valve | Isolating plug kit |
|----------------------------------|---------------------------------------|--------------------|
|----------------------------------|---------------------------------------|--------------------|

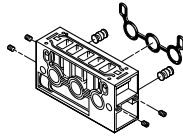
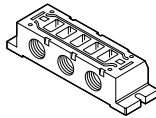

|                    |                    |          |
|--------------------|--------------------|----------|
| 3/8 PTF 13340-70   | 3/8 PTF 13335-50   | 54676-50 |
| 3/8 ISO G 13340-70 | 3/8 ISO G 13335-51 |          |
| 1/2 PTF 13340-72   | 1/2 PTF 13335-52   |          |
| 1/2 ISO G 13340-73 | 1/2 ISO G 13335-53 |          |

# Nugget 500 Series Valves

5/2 and 5/3 directional control spool valves

## Subbase Valve on Single Subbase Dimensions

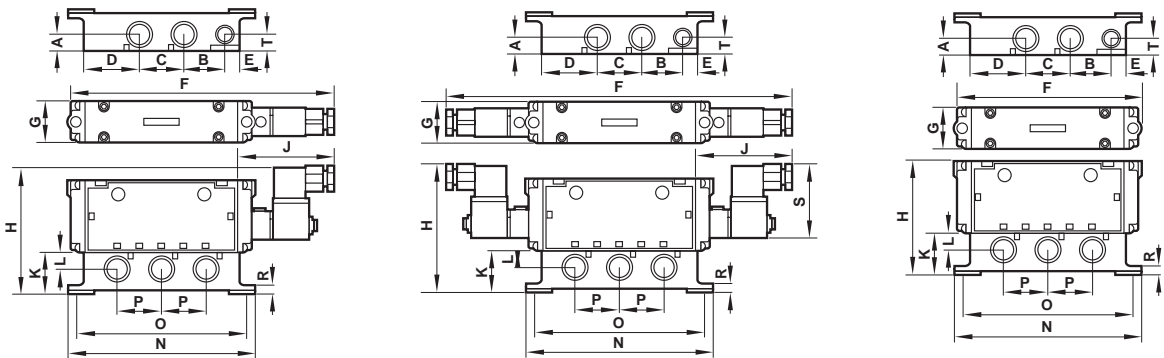

Note: 4 mm hex key drive required for mounting screws

| Valve  | A            | B            | C            | D            | E            | F              | G            | H             | J             | K            | L            | N              | O             | P            | R           | S            | T            |
|--|--------------|--------------|--------------|--------------|--------------|----------------|--------------|---------------|---------------|--------------|--------------|----------------|---------------|--------------|-------------|--------------|--------------|
| Solenoid Pilot Operator — 5/2<br>Nondetent Single Solenoid*                    | 0.63<br>(16) | 1.94<br>(49) | 1.48<br>(38) | 1.46<br>(37) | 0.48<br>(12) | 9.46<br>(240)  | 1.80<br>(46) | 4.15<br>(105) | 3.53<br>(90)  | 1.38<br>(35) | 0.63<br>(16) | 6.50<br>(1.65) | 6.05<br>(154) | 1.48<br>(38) | 0.25<br>(6) | 2.71<br>(69) | 0.63<br>(16) |
| Double Solenoid  | 0.63<br>(16) | 1.94<br>(49) | 1.48<br>(38) | 1.46<br>(37) | 0.48<br>(12) | 10.40<br>(264) | 1.80<br>(46) | 4.15<br>(105) | 4.00<br>(102) | 1.38<br>(35) | 0.63<br>(16) | 6.50<br>(1.65) | 6.05<br>(154) | 1.48<br>(38) | 0.25<br>(6) | 2.71<br>(69) | 0.63<br>(16) |
| Solenoid Pilot Operator — 5/2 Detent or<br>5/3 Spring Centered Double Solenoid | 0.63<br>(16) | 1.94<br>(49) | 1.48<br>(38) | 1.46<br>(37) | 0.48<br>(12) | 12.36<br>(314) | 1.80<br>(46) | 4.15<br>(105) | 3.53<br>(90)  | 1.38<br>(35) | 0.63<br>(16) | 6.50<br>(1.65) | 6.05<br>(154) | 1.48<br>(38) | 0.25<br>(6) | 2.71<br>(69) | 0.63<br>(16) |
| Air Pilot Operator — 5/2<br>Nondetent Single Air*                              | 0.63<br>(16) | 1.94<br>(49) | 1.48<br>(38) | 1.46<br>(37) | 0.48<br>(12) | 6.56<br>(167)  | 1.80<br>(46) | 3.89<br>(99)  | —             | 1.38<br>(35) | 0.63<br>(16) | 6.50<br>(1.65) | 6.05<br>(154) | 1.48<br>(38) | 0.25<br>(6) | —            | 0.63<br>(16) |
| Double Air   | 0.63<br>(16) | 1.94<br>(49) | 1.48<br>(38) | 1.46<br>(37) | 0.48<br>(12) | 6.56<br>(167)  | 1.80<br>(46) | 3.89<br>(99)  | —             | 1.38<br>(35) | 0.63<br>(16) | 6.50<br>(1.65) | 6.05<br>(154) | 1.48<br>(38) | 0.25<br>(6) | —            | 0.63<br>(16) |
| Air Pilot Operator — 5/2 Detent or<br>5/3 Spring Centered Double Air           | 0.63<br>(16) | 1.94<br>(49) | 1.48<br>(38) | 1.46<br>(37) | 0.48<br>(12) | 7.50<br>(191)  | 1.80<br>(46) | 3.89<br>(99)  | —             | 1.38<br>(35) | 0.63<br>(16) | 6.50<br>(1.65) | 6.05<br>(154) | 1.48<br>(38) | 0.25<br>(6) | —            | 0.63<br>(16) |

\*With air-assisted spring return, spring return or integral air return.

## Subbase Valves on Modular Manifold Dimensions

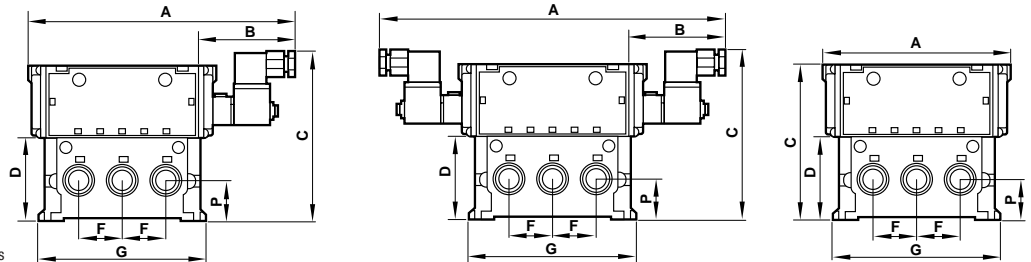

Note: 4 mm hex key drive required for mounting screws

## Manifold Subbase Assembly

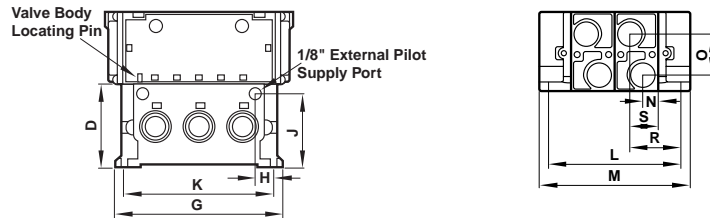

Dimensions in inches (mm)

| Valve  | A              | B             | C             | D            | F            | G             | H            | J            | K             | L**           | M**           | N            | O            | P            | R            | S            |
|--|----------------|---------------|---------------|--------------|--------------|---------------|--------------|--------------|---------------|---------------|---------------|--------------|--------------|--------------|--------------|--------------|
| Solenoid Pilot Operator — 5/2<br>Nondetent Single Solenoid*                    | 9.46<br>(240)  | 3.53<br>(90)  | 5.62<br>(143) | 2.85<br>(72) | 1.48<br>(38) | 5.76<br>(146) | 0.97<br>(25) | 2.48<br>(63) | 5.13<br>(130) | 4.58<br>(116) | 5.14<br>(131) | 0.53<br>(14) | 1.44<br>(37) | 1.35<br>(34) | 0.97<br>(25) | 1.82<br>(46) |
| Double Solenoid  | 12.36<br>(314) | 3.53<br>(90)  | 5.62<br>(143) | 2.85<br>(72) | 1.48<br>(38) | 5.76<br>(146) | 0.97<br>(25) | 2.48<br>(63) | 5.13<br>(130) | 4.58<br>(116) | 5.14<br>(131) | 0.53<br>(14) | 1.44<br>(37) | 1.35<br>(34) | 0.97<br>(25) | 1.82<br>(46) |
| Solenoid Pilot Operator — 5/2 Detent or 5/3<br>Spring Centered Double Solenoid | 13.30<br>(338) | 4.00<br>(102) | 5.62<br>(143) | 2.85<br>(72) | 1.48<br>(38) | 5.76<br>(146) | 0.97<br>(25) | 2.48<br>(63) | 5.13<br>(130) | 4.58<br>(116) | 5.14<br>(131) | 0.53<br>(14) | 1.44<br>(37) | 1.35<br>(34) | 0.97<br>(25) | 1.82<br>(46) |
| Air Pilot Operator — 5/2<br>Nondetent Single Air*                              | 6.56<br>(167)  | —             | 5.36<br>(136) | 2.85<br>(72) | 1.48<br>(38) | 5.76<br>(146) | 0.97<br>(25) | 2.48<br>(63) | 5.13<br>(130) | 4.58<br>(116) | 5.14<br>(131) | 0.53<br>(14) | 1.44<br>(37) | 1.35<br>(34) | 0.97<br>(25) | 1.82<br>(46) |
| Double Air   | 6.56<br>(167)  | —             | 5.36<br>(136) | 2.85<br>(72) | 1.48<br>(38) | 5.76<br>(146) | 0.97<br>(25) | 2.48<br>(63) | 5.13<br>(130) | 4.58<br>(116) | 5.14<br>(131) | 0.53<br>(14) | 1.44<br>(37) | 1.35<br>(34) | 0.97<br>(25) | 1.82<br>(46) |
| Air Pilot Operator — 5/2 Detent or<br>5/3 Spring Centered Double Air           | 7.50<br>(191)  | —             | 5.36<br>(136) | 2.85<br>(72) | 1.48<br>(38) | 5.76<br>(146) | 0.97<br>(25) | 2.48<br>(63) | 5.13<br>(130) | 4.58<br>(116) | 5.14<br>(131) | 0.53<br>(14) | 1.44<br>(37) | 1.35<br>(34) | 0.97<br>(25) | 1.82<br>(46) |

\*With air-assisted spring return, spring return or integral air return.

\*\*Dimensions shown are for two end plates and two manifold subbases. Add 1.50" (38 mm) for each additional manifold subbase.

# Nugget 500 Series Valves

## 5/2 and 5/3 directional control spool valves

Dimensions in inches (mm)

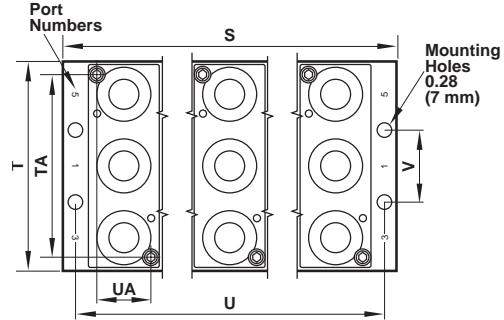
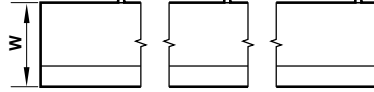
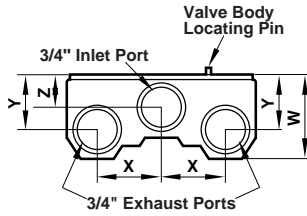

| Manifold Kits* |           | Fixed Length Manifold Kits and Dimensions |             |            |             |           |           |           |           |           |           |           |
|----------------|-----------|---|-------------|------------|-------------|-----------|-----------|-----------|-----------|-----------|-----------|-----------|
| Ports          |           | No. of Stations                           | S           | T          | U           | V         | W         | X         | Y         | Z         | TA        | UA        |
| 3/4 NPT        | 3/4 ISO G | 2   | 4.00 (102)  | 4.28 (109) | 3.50 (89)   | 1.50 (38) | 1.78 (45) | 1.48 (38) | 1.13 (29) | 0.65 (17) | 3.75 (95) | 1.12 (28) |
| 13342-60       | 13342-70  | 2   | 4.00 (102)  | 4.28 (109) | 3.50 (89)   | 1.50 (38) | 1.78 (45) | 1.48 (38) | 1.13 (29) | 0.65 (17) | 3.75 (95) | 1.12 (28) |
| 13342-61       | 13342-71  | 3   | 5.50 (140)  | 4.28 (109) | 5.00 (127)  | 1.50 (38) | 1.78 (45) | 1.48 (38) | 1.13 (29) | 0.65 (17) | 3.75 (95) | 1.12 (28) |
| 13342-62       | 13342-72  | 4   | 7.00 (178)  | 4.28 (109) | 6.50 (165)  | 1.50 (38) | 1.78 (45) | 1.48 (38) | 1.13 (29) | 0.65 (17) | 3.75 (95) | 1.12 (28) |
| 13342-63       | 13342-73  | 5   | 8.50 (216)  | 4.28 (109) | 8.00 (203)  | 1.50 (38) | 1.78 (45) | 1.48 (38) | 1.13 (29) | 0.65 (17) | 3.75 (95) | 1.12 (28) |
| 13342-64       | 13342-74  | 6   | 10.00 (254) | 4.28 (109) | 9.50 (241)  | 1.50 (38) | 1.78 (45) | 1.48 (38) | 1.13 (29) | 0.65 (17) | 3.75 (95) | 1.12 (28) |
| 13342-65       | 13342-75  | 8   | 13.00 (330) | 4.28 (109) | 12.50 (318) | 1.50 (38) | 1.78 (45) | 1.48 (38) | 1.13 (29) | 0.65 (17) | 3.75 (95) | 1.12 (28) |
| 13342-66       | 13342-76  | 10  | 16.00 (406) | 4.28 (109) | 15.50 (394) | 1.50 (38) | 1.78 (45) | 1.48 (38) | 1.13 (29) | 0.65 (17) | 3.75 (95) | 1.12 (28) |

\* Kits include manifolds, seals, and valve attaching hardware.

### Factory Installed Back Cover Plates for Valve Bodies

The Back Cover Plate ordered with the valve allows the valve to be used in wash-down environments such as food or medical processing. If a subbase valve is desired for wash-down environments, use only the single subbase.

For cover plate installed on an Inline Valve body specify with 54690-11 after the valve body number.

For cover plate installed on a Subbase Valve body specify with 54690-12 after the valve body number.

### Pneu-Fit Push-in Tube Fittings

Push-in tube fittings are an excellent way to save valve connection time and simplify component replacement. See Norgren Fittings catalog APC-101 for a complete selection of push-in tube fittings, flexible tubing, tubing markers, and tube mounts.

### Part Numbers for Replacement Solenoid Coils & Armature Bases

| Solenoid Coils:             |  |          |
|-----------------------------|--|----------|
| 24V/60Hz-24V/50Hz, 3.5W     |  | 54469-04 |
| 120V/60Hz-110V/50Hz, 3.5W   |  | 54469-03 |
| 6VDC, 2W                    |  | 54469-05 |
| 12VDC, 2W                   |  | 54469-01 |
| 24VDC, 2W                   |  | 54469-02 |
| 110VDC, 3.4W                |  | 54469-06 |
| 240V/60Hz-220V/50Hz, 7.5W   |  | 54452-07 |
| 120V/60Hz-110V/50Hz, 7.5W   |  | 54452-01 |
| 24V/60Hz-24V/50Hz, 7.5W     |  | 54452-05 |
| 12VDC, 7.5W                 |  | 54452-02 |
| 24VDC, 6W                   |  | 54452-03 |
| Solenoid Base and Armature: |  |          |
| Without Override            |  |          |
| 6 to 7.5 Watt               |  | 54462-01 |
| 2 to 3.5 Watt               |  | 54462-03 |
| With locking override       |  |          |
| 6 to 7.5 Watt               |  | 54462-02 |
| 2 to 3.5 Watt               |  | 54462-04 |
| With non-locking override   |  |          |
| 6 to 7.5 Watt               |  | 54462-09 |
| 2 to 3.5 Watt               |  | 54462-10 |

### Part Numbers for Replacement Connectors

|  |          |
|--|----------|
| Cable grip connector   | 54934-01 |
| Cable grip connector with indicator light                              |          |
| 110/120 VAC/DC   | 54934-02 |
| 24 VAC/DC  | 54934-08 |
| 1/2" NPT conduit   | 54934-05 |
| Molded 5-ft cable connector 0-220 VAC/DC                               | 54934-21 |
| Molded 5-ft cable connector with indicator light and surge suppression |          |
| 24 VAC/DC  | 54934-30 |
| 110 VAC/DC   | 54934-35 |
| 240 VAC/DC   | 54934-37 |

### Part Numbers for Repair Parts & Kits

|                                |          |
|--------------------------------|----------|
| Metal coil retaining ring      | 54453-01 |
| Solenoid connector seal kit    | 54935-01 |
| Solenoid exhaust port diffuser | 54463-01 |
| Solenoid exhaust port filter   |          |
| Ordered with valve             | 54463-50 |
| Ordered separately             | 54463-51 |

### Spool replacement kits:

|                                   |          |
|-----------------------------------|----------|
| Single pressure, 2-position       | 54677-50 |
| Dual pressure, 2-position         | 54677-51 |
| Single pressure, 3-position, APB* | 54677-52 |
| Dual pressure, 3-position, APB*   | 54677-53 |
| Single pressure, 3-position, COE* | 54677-54 |
| Dual pressure, 3-position, COE*   | 54677-55 |

\*In the center position

### Seal kits

|   |          |
|---|----------|
| Inline valves   | 54692-50 |
| Subbase valves  | 54692-51 |
| Inline valve to fixed length manifold                     | 54674-89 |
| Subbase valve to subbase                                  | 54672-89 |
| Manifolding subbase to end plates                         | 54673-89 |
| Manifold clamping pin (1) & set screws (2)                | 54574-50 |
| Mounting screws valve to fixed length manifold or subbase | 54580-60 |
| Mounting screws valve and speed control to subbase        | 54580-61 |

# Nugget 500 Series Valves

5/2 and 5/3 directional control spool valves

## Nugget 500 Product Deconfigurator

