

# Pneufit push-in fittings

## Metric

Ø 4 to 14 mm O/D tube

**Compact units featuring retained collets and positive tube anchorage.**

**Silicone free 'O'-ring seals.**

**Non-PTFE based thread sealant on all BSP taper threads.**

**Easy tube insertion for rapid assembly.**

**Internal hexagon on straight adaptors allows assembly in confined spaces.**

**Wide range of types available.**

**Reliable and corrosion resistant.**

### Specifications

Fluid: Compressed air, nitrogen, inert and non-combustible gases compatible with materials of construction. For other types of fluids or compressed gases, please consult factory.

Working Pressure: 750 mm Hg to 18 bar

(29.5" Hg vacuum to 260 psig)

Note: Flow Controls working pressures:

.3 to 10 bar (5 to 150 psig)

Working Temperature: -20° to 80°C (0° to 175°F)

Request viton® option on selected part numbers for extended temperature range : -20° to 180°C (0° to 350°F)

### Materials of Construction

Body, swivel fitting and collet:

Nickel plated brass

O-ring: Silicone free Nitrile

Sealing washer (parallel male threads): Silicon free nitrile

Tubing: Nylon 11 or Nylon 12, Polyurethane (95 durometer or above) and LDPE (Low Density Polyethylene).

Note: Lower durometer polyurethane may be used, however, an internal tube support is required to prevent internal collapse of the tube wall.

Thread Sealant: Precote 5 thread sealant is factory applied to the circumference of tapered male threads (ISO R).

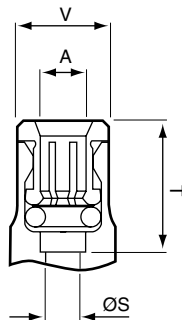

### Dimensions mm (in.)

A	S	T	V
O.D. Tube		Tubing Stop	
4 (5/32")	2.8 (.11)	14.0 (.55)	7.5 (.30)
5	3.4 (.13)	15.0 (.59)	10.0 (.39)
6	4.4 (.17)	15.5 (.61)	11.0 (.43)
8 (5/16")	6.0 (.24)	16.5 (.65)	13.0 (.51)
10	7.6 (.30)	21.0 (.83)	14.5 (.57)
12	9.6 (.38)	24.5 (.96)	18.0 (.71)
14	11.5 (.45)	24.5 (.96)	20.0 (.79)

### Recommended tightening torques

Thread Size	Tightening Torque Nm (ft lbs)	
	ISO R	ISO G*
M5	—	1 - 1.4 (.75 - 1.05)
1/8	6.9 - 8.8 (5.0 - 6.5)	7 - 9 (5.3 - 6.8)
1/4	11.8 - 13.7 (8.7 - 10.0)	9 - 12 (6.8 - 9.0)
3/8	21.6 - 23.5 (15.9 - 17.3)	34 - 38 (25.5 - 28.5)
1/2	27.4 - 29.4 (20.2 - 21.7)	41 - 47 (30.8 - 35.3)

\* Lower torques can be used to achieve a seal but these figures are recommended to provide some vibration resistance.

### Tube O.D.'s and Tube Tolerances

O.D. Tube	Nylon	Polyurethane
4 mm to 5 mm (5/32" to 3/16")	+0.05 mm (+0.002") -0.07 mm (-0.003")	±0.10 mm (±0.004")
6 mm to 14 mm (1/4" to 1/2")	+0.05 mm (+0.002") -0.10 mm (-0.004")	

LDPE -Tolerances specified in DIN 73378 or BS54-09/1:1976

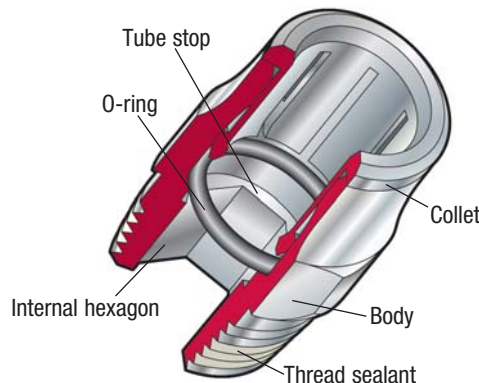

# Pneufit push-in fittings

Metric

Ø 4 to 14 mm O/D tube

## Pneufit Union



O/D Tube	Part Number
4	10 020 0400
5	10 020 0500
6	10 020 0600
8	10 020 0800
10	10 020 1000
12	10 020 1200
14	10 020 1400

## Pneufit Conversions Union (Inch tube to mm tube)



O/D Inch	O/D MM	Part Number
5/32	4	12 020 0200
3/16	5	12 037 0305
1/4	6	12 037 0406
5/16	8	12 020 0500
3/8	10	12 037 0610
1/2	12	12 037 0712

## Pneufit Double Male Union (Brass)



O/D Stem	Part Number
4	10 022 0400
5	10 022 0500
6	10 022 0600
8	10 022 0800
10	10 022 1000
12	10 022 1200
14	10 022 1400

Not suitable for use with Pneufit C

## Pneufit Tube End Expander/Reducer



O/D Tube	O/D Stem	Part Number
4	5	10 023 0504
4	6	10 023 0604
5	6	10 023 0605
4	8	10 023 0804
5	8	10 023 0805
6	8	10 023 0806
4	10	10 023 1004
5	10	10 023 1005
6	10	10 023 1006
8	10	10 023 1008
4	12	10 023 1204
5	12	10 023 1205
6	12	10 023 1206
8	12	10 023 1208
10	12	10 023 1210
6	14	10 023 1406
8	14	10 023 1408
10	14	10 023 1410
12	14	10 023 1412

Not suitable for use with Pneufit C



## Pneufit Bulkhead Union

O/D Tube	Metric Thread	Part Number
4	M10 x 1.0	12 029 0400
5	M12 x 1.0	12 029 0500
6	M14 x 1.0	12 029 0600
8	M16 x 1.5	12 029 0800
10	M20 x 1.5	12 029 1000
12	M24 x 1.5	12 029 1200
14	M24 x 1.5	12 029 1400

## Pneufit Union Elbow



O/D Tube	Part Number
4	10 040 0400
5	10 040 0500
6	10 040 0600
8	10 040 0800
10	10 040 1000
10	10 040 1200
14	10 040 1400

## Pneufit Union Tee



O/D Tube	Part Number
4	10 060 0400
5	10 060 0500
6	10 060 0600
8	10 060 0800
10	10 060 1000
12	10 060 1200
14	10 060 1400

## Pneufit Union "Y"



O/D Tube	O/D Tube	Part Number
4	4	12 082 0200
6	6	10 082 0600
8	8	12 082 0500
10	10	10 082 1000
6	4	10 082 0604
8	6	10 082 0806
10	8	10 082 1008

# Pneufit push-in fittings

## Metric

Ø 4 to 14 mm O/D tube



Pneumatic Male Adapter

O/D Tube	NPT Thread	Part Number
4	10-32	12 425 0210
4	1/8	12 425 0218
4	1/4	12 425 0228
5	1/8	10 425 0518
5	1/4	10 425 0528
6	10-32	10 425 0610
6	1/8	10 425 0618
6	1/4	10 425 0628
6	3/8	10 425 0638
8	1/8	12 425 0518
8	1/4	12 425 0528
8	3/8	12 425 0538
10	1/8	10 425 1018
10	1/4	10 425 1028
10	3/8	10 425 1038
10	1/2	10 425 1048
12	1/4	10 425 1228
12	3/8	10 425 1238
12	1/2	10 425 1248



Pneufit Male Adapter - Conversion (Inch O.D. Tube to ISO R [Male] Thread)

O/D Tube	ISO R Thread	Part Number
4	1/8	10 125 0418
4	1/4	10 125 0428
5	1/8	10 125 0518
5	1/4	10 125 0528
6	1/8	10 125 0618
6	1/4	10 125 0628
8	1/8	10 125 0818
8	1/4	10 125 0828
8	3/8	10 125 0838
8	1/2	10 125 0848
10	1/8	10 125 1018
10	1/4	10 125 1028
10	3/8	10 125 1038
10	1/2	10 125 1048
12	1/4	10 125 1228
12	3/8	10 125 1238
12	1/2	10 125 1248
14	3/8	10 125 1438
14	1/2	10 125 1448

Pneufit ISO G Male Adapter

O/D Tube	ISO G or Metric Thread	Part Number
4	M5 x .8	10 225 0405
4	1/8	10 225 0418
4	1/4	10 225 0428
5	M5 x .8	10 225 0505
5	1/8	10 225 0518
5	1/4	10 225 0528
6	M5 x .8	10 225 0605
6	1/8	10 225 0618
6	1/4	10 225 0628
8	1/8	10 225 0818
8	1/4	10 225 0828
8	3/8	10 225 0838
8	1/2	10 225 0848
10	1/8	10 225 1018
10	1/4	10 225 1028
10	3/8	10 225 1038
10	1/2	10 225 1048
12	1/4	10 225 1228
12	3/8	10 225 1238
12	1/2	10 225 1248
14	3/8	10 225 1438
14	1/2	10 225 1448

Pneufit ISO G Male Connector

Pneufit ISO R Stem Adapter

O/D Stem	ISO R Thread	Part Number
4	1/8	10 115 0418
4	1/4	10 115 0428
5	1/8	10 115 0518
5	1/4	10 115 0528
6	1/8	10 115 0618
6	1/4	10 115 0628
8	1/8	10 115 0818
8	1/4	10 115 0828
8	3/8	10 115 0838
10	1/4	10 115 1028
10	3/8	10 115 1038
10	1/2	10 115 1048
12	3/8	10 115 1238
12	1/2	10 115 1248
14	1/2	10 115 1448

Not suitable for use with Pneufit C

Pneufit ISO G Stem Adapter

O/D Stem	ISO G Thread	Part Number
4	1/8	10 215 0418
4	1/4	10 215 0428
5	1/8	10 215 0518
5	1/4	10 215 0528
6	1/8	10 215 0618
6	1/4	10 215 0628
8	1/8	10 215 0818
8	1/4	10 215 0828
8	3/8	10 215 0838
10	1/4	10 215 1028
10	3/8	10 215 1038
10	1/2	10 215 1048
12	3/8	10 215 1238
12	1/2	10 215 1248
14	1/2	10 215 1448

Not suitable for use with Pneufit C

Self Sealing (checked) Adapter (ISO R)

O/D Tube	ISO R Thread	Part Number
4	1/8	10 124 0418
6	1/8	10 124 0618
6	1/4	10 124 0628
8	1/4	10 124 0828



# Pneufit push-in fittings

Metric

Ø 4 to 14 mm O/D tube

## Pneufit Swivel Bulkhead Union Elbow



CAUTION: Swivel adapters are not suitable for use in continuously rotating or gyrating applications.

O/D Tube	Thread	Product Number
4	M12x1.0	10 049 0400
5	M12x1.0	10 049 0500
6	M14x1.5	10 049 0600
8	M16x1.5	10 049 0800
10	M22x1.5	10 049 1000
12	M24x1.5	10 049 1200
14	M26x1.5	10 049 1400

## Pneufit ISO R Male Fixed Elbow



O/D Tube	ISO R Thread	Part Number
4	1/8	10 145 0418
4	1/4	10 145 0428
5	1/8	10 145 0518
5	1/4	10 145 0528
6	1/8	10 145 0618
6	1/4	10 145 0628
8	1/8	10 145 0818
8	1/4	10 145 0828
8	3/8	10 145 0838
8	1/2	10 145 0848
10	1/8	10 145 1018
10	1/4	10 145 1028
10	3/8	10 145 1038
10	1/2	10 145 1048
12	1/4	10 145 1228
12	3/8	10 145 1238
12	1/2	10 145 1248

## Pneufit Stem Elbow



O/D Tube	O/D Stem	Part Number
4	4	10 043 0400
6	6	10 043 0600
8	8	10 043 0800

Not suitable for use with Pneufit C

## Pneufit ISO G Female Adapter



O/D Tube	ISO G or Metric Thread	Part Number
4	M5 x .8	10 226 0405
4	1/8	10 226 0418
4	1/4	10 226 0428
5	1/8	10 226 0518
5	1/4	10 226 0528
6	1/8	10 226 0618
6	1/4	10 226 0628
8	1/8	10 226 0818
8	1/4	10 226 0828
10	1/4	10 226 1028
10	3/8	10 226 1038
12	3/8	10 226 1238
12	1/2	10 226 1248

## Pneufit ISO G Swivel Male Elbow



CAUTION: Swivel adapters are not suitable for use in continuously rotating or gyrating applications.

O/D Tube	ISO G or Metric Thread	Part Number
4	M5 x .8	10 247 0405
4	1/8	10 247 0418
4	1/4	10 247 0428
5	M5 x .8	10 247 0505
5	1/8	10 247 0518
5	1/4	10 247 0528
6	M5 x .8	10 247 0605
6	1/8	10 247 0618
6	1/4	10 247 0628
8	1/8	10 247 0818
8	1/4	10 247 0828
8	3/8	10 247 0838
8	1/2	10 247 0848
10	1/8	10 247 1018
10	1/4	10 247 1028
10	3/8	10 247 1038
10	1/2	10 247 1048
12	1/4	10 247 1228
12	3/8	10 247 1238
12	1/2	10 247 1248
14	3/8	10 247 1438
14	1/2	10 247 1448

# Pneufit push-in fittings

## Metric

Ø 4 to 14 mm O/D tube



CAUTION: Swivel adapters are not suitable for use in continuously rotating or gyrating applications.

Pneufit ISO R Swivel Male Elbow

O/D Tube	ISO R Thread	Part Number
4	1/8	10 147 0418
4	1/4	10 147 0428
5	1/8	10 147 0518
5	1/4	10 147 0528
6	1/8	10 147 0618
6	1/4	10 147 0628
6	3/8	10 147 0638
8	1/8	10 147 0818]
8	1/4	10 147 0828]
8	3/8	10 147 0838
8	1/2	10 147 0848
10	1/8	10 147 1018
10	1/4	10 147 1028
10	3/8	10 147 1038
10	1/2	10 147 1048
12	1/4	10 147 1228
12	3/8	10 147 1238
12	1/2	10 147 1248
14	3/8	10 147 1438
14	1/2	10 147 1448

Pneufit ISO G Swivel Male Tee

A O/D Tube	B ISO G or Metric Thrd	Part Number
4	M5 x .8	10 267 0405
4	1/8	10 267 0418
5	M5 x .8	10 267 0505
5	1/8	10 267 0518
5	1/4	10 267 0528
6	M5 x .8	10 267 0605
6	1/8	10 267 0618
6	1/4	10 267 0628
8	1/8	10 267 0818
8	1/4	10 267 0828
10	1/4	10 267 1028
10	3/8	10 267 1038
12	1/4	10 267 1228
12	3/8	10 267 1238
14	3/8	10 267 1438
14	1/2	10 267 1448



Pneufit ISO R Swivel Male Tee

A O/D Tube	B ISO R Thrd	Part Number
4	1/8	10 167 0418
4	1/4	10 167 0428
5	1/8	10 167 0518
5	1/4	10 167 0528
6	1/8	10 167 0618
6	1/4	10 167 0628
8	1/8	10 167 0818
8	1/4	10 167 0828
8	3/8	10 167 0838
10	1/4	10 167 1028
10	3/8	10 167 1038
12	1/4	10 167 1228
12	3/8	10 167 1238
12	1/2	10 167 1248
14	3/8	10 167 1438
14	1/2	10 167 1448



CAUTION: Swivel adapters are not suitable for use in continuously rotating or gyrating applications.

Pneufit ISO R Swivel Male Side Tee

A O/D Tube	B ISO R Thrd	Part Number
4	1/8	10 168 0418
4	1/4	10 168 042
5	1/8	10 168 0518
5	1/4	10 168 0528
6	1/8	10 168 0618
6	1/4	10 168 0628
8	1/8	10 168 0818
8	1/4	10 168 0828
8	3/8	10 168 0838
10	1/4	10 168 1028
10	3/8	10 168 1038
12	1/4	10 168 1228
12	3/8	10 168 1238
12	1/2	10 168 1248
14	3/8	10 168 1438
14	1/2	10 168 1448



CAUTION: Swivel adapters are not suitable for use in continuously rotating or gyrating applications.

Pneufit ISO G Swivel Male Side Tee

A O/D Tube	B ISO G or Metric Thrd	Part Number
4	M5 x .8	10 268 0405
4	1/8	10 268 0418
5	1/8	10 268 0518
5	1/4	10 268 0528
6	1/8	10 268 0618
6	1/4	10 268 0628
8	1/8	10 268 0818
8	1/4	10 268 0828
10	1/4	10 268 1028
10	3/8	10 268 1038
12	1/4	10 268 1228
12	3/8	10 268 1238
14	3/8	10 268 1438
14	1/2	10 268 1448



CAUTION: Swivel adapters are not suitable for use in continuously rotating or gyrating applications.

Pneufit ISO G Swivel 45° Male Elbow

O/D Tube	ISO G Thread	Part Number
6	1/8	10 257 0618
6	1/4	10 257 0628
8	1/8	10 257 0818
8	1/4	10 257 0828



CAUTION: Swivel adapters are not suitable for use in continuously rotating or gyrating applications.



# Pneufit push-in fittings

Metric

Ø 4 to 14 mm O/D tube

Pneufit Single Stacking Banjo Bolt (Supplied complete w/sealing washers)



ISO G or Metric Thread	Part Number
M5 x .8	20 A00 0005
1/8	20 A00 0018
1/4	20 A00 0028
3/8	20 A00 0038
1/2	20 A00 0048



Pneufit ISO G Banjo Elbow

O/D Tube	ISO G or Metric Thread	Part Number
4	M5 x .8	10 A51 0405
4	1/8	10 A51 0418
5	M5 x .8	10 A51 0505
5	1/8	10 A51 0518
6	M5 x .8	10 A51 0605
6	1/8	10 A51 0618
6	1/4	10 A51 0628
8	1/8	10 A51 0818
8	1/4	10 A51 0828
8	3/8	10 A51 0838
10	1/4	10 A51 1028
10	3/8	10 A51 1038

Pneufit Triple Stacking Banjo Bolt



ISO G Thread	Part Number
1/8	20 C00 0018
1/4	20 C00 0028
3/8	20 C00 0038



Pneufit Double Stacking Banjo Bolt (Supplied complete w/sealing washers)

ISO G or Metric Thread	Part Number
M5 x .8	20 B00 0005
1/8	20 B00 0018
1/4	20 B00 0028
3/8	20 B00 0038
1/2	20 B00 0048

Pneufit Single Stacking Banjo Bolt w/ Top Port (ISO G) (Supplied complete w/sealing washers)



ISO G or Metric Thread	ISO G or Metric Top Port Thread	Part Number
M5 x .8	M5 x .8	20 D00 0505
1/4	M5 x .8	20 D00 0528
1/4	1/8	20 E00 1828
1/4	1/4	20 F00 2828
1/8	1/8	20 E00 1818
3/8	M5 x .8	20 D00 0538
3/8	1/8	20 E00 1838
3/8	3/8	20 G00 3838

Pneufit Elbow Body



A O/D Tube	Use With Banjo Bolt Size	Part Number
4	M5 x .8	10 051 0405
4	1/8	10 051 0418
5	M5 x .8	10 051 0505
5	1/8	10 051 0518
6	M5 x .8	10 051 0605
6	1/8	10 051 0618
6	1/4	10 051 0628
8	1/8	10 051 0818
8	1/4	10 051 0828
8	3/8	10 051 0838
10	1/4	10 051 1028
10	3/8	10 051 1038
12	3/8	10 051 1238
12	1/2	10 051 1248

Pneufit Tee Body



O/D Tube	Use With Banjo Bolt Size	Part Number
4	M5 x .8	10 071 0405
4	1/8	10 071 0418
5	M5 x .8	10 071 0505
5	1/8	10 071 0518
6	1/8	10 071 0618
6	1/4	10 071 0628
8	1/8	10 071 0818
8	1/4	10 071 0828

# Pneufit push-in fittings

Metric

Ø 4 to 14 mm O/D tube



Pneufit Barb Adapter

O/D Stem	Part Number
4	10 019 0403
4	10 019 0405
5	10 019 0505
6	10 019 0605
8	10 019 0806
8	10 019 0808
10	10 019 1006
10	10 019 1008
10	10 019 1010
12	10 019 1208
12	10 019 1210
12	10 019 1212
14	10 019 1412

Not suitable for use with Pneufit C



Pneufit Pressure Indicator

O/D Stem	Part Number
4	10 010 0400
6	10 010 0600
8	10 010 0800

Not suitable for use with Pneufit C



Manifold\* (O/D tube)

O/D Tube	O/D Tube	Product Number
8.0	4.0	12 OD6 0502
8.0	6.0	10 OD6 0806
10.0	6.0	10 OD6 1006
10.0	8.0	10 OD6 1008

\* Body material thermoplastic



Pneufit ISO G Hex Nipple (Supplied with sealing washers)

ISO G Thread	Part Number
1/8	16 020 1818
1/4	16 020 2828
3/8	16 020 3838
1/2	16 020 4848



Manifold\*

O/D Tube	O/D Tube	ISO R Thread	Product Number
8.0	4.0	1/4	10 1D6 0428
8.0	4.0	3/8	10 1D6 0438
8.0	6.0	1/4	10 1D6 0628
8.0	6.0	3/8	10 1D6 0638
10.0	8.0	3/8	10 1D6 0838
10.0	8.0	1/2	10 1D6 0848

\* Body material thermoplastic



Pneufit ISO R Hex Nipple

ISO R Thread	Part Number
1/8	15 020 1818
1/4	15 020 2828
3/8	15 020 3838
1/2	15 020 4848