

# 7 Hose Couplings and Accessories

## Hose Couplings and Accessories

	Page
Hose Coupling Selection Chart .....	7.1-7.2
Permanently Attached Hose Couplings .....	7.3-7.13
Metric, BSP and JIS Hose Couplings .....	7.14-7.22
Reusable Hose Couplings.....	7.23-7.25
Brass Hose Couplings .....	7.26
Adapters.....	7.27-7.28
Hose Coupling Assembly Tools .....	7.29-7.31
Hose Accessories .....	7.32-7.35

# Hose Coupling Selection Chart

Coupling Series	Permanent Coupling	Reusable Coupling	Hose Series and Dash Size Range*
<b>Zinc Plated Steel</b>			
3903	•		3630 (-03 to -12), 3R30, 3130, 37AL, 3750, 3800, 3840, 31GW, 3440 (-04 to -08), 31B0, 37B0, 30CT (-04 to -06)
390H	•		3630 (-16), 3R80, 3E80, 3440 (-12 to -16), 30CT (-08)
390N	•		3350, 3360
390V	•		3V10, 3VE0
7903	•		3630 (-03 to -12), 3R30, 3000, 3130, 3580, 37AL, 3750, 3800, 3840, 31GW, 3440 (-4 to -8), 31B0, 37B0, 30CT (-04 to -06)
790H	•		3630 (-16), 3R80, 3E80, 3440 (-12 to -16), 30CT (-08)
3901		•	3000
3902		•	37AL, 3750
390J		•	3R80, 3E80
7950, 7951		•	32GW, 34GW
<b>Stainless Steel</b>			
390A	•		3630 (-3 to -12), 3R30, 3000, 3130, 3580, 37AL, 3750, 31N0, 3800, 3840, 34PW (-4 to -8), 31B0, 37B0, 30CT (-03 to -06)
390L	•		3630 (-16), 3R80 (-3 to -16), 3E80 (-3 to -16), 3440, 34PW (-12 to -16), 34BA (-6), 30CT (-08)
3908		•	3000
390K		•	3R80, 3E80
390V (-C05)	•		3V10, 3VE0
3902 (-C05)		•	37AL, 3750
<b>Monel</b>			
390P	•		3630 (-3 to -12), 3R30, 3000, 3130, 3580, 31B0, 37B0, 37AL, 3750, 31N0, 3800, 3840, 30CT (-04 to -06)
390S	•		3630 (-16), 3R80, 3E80
390V (-A01)	•		3V10, 3VE0
<b>Brass</b>			
390C	•		3630 (-3 to -12)
3906	•		Made to Order for Many Hose Series
4401		•	4202

\* Dash Size = Hose I.D. in 16th of One Inch. Example: -3 = 3/16 Inch I.D. ,  
Where Hose Series Only is Listed, All Cataloged Dash Sizes Attach  
to Coupling Series.

# Hose Coupling End Connection Style Code Numbers

Code Number	Description	Page
100	Male Pipe, Rigid	7.3
140	Male Pipe, Swivel	7.5
200	Female Pipe, Rigid	7.7
240	Female Pipe, Swivel (NPSM)	7.8
270	Male Pipe, Swivel, 90° Elbow	7.8
400	O-Ring Face Seal, Straight	7.11
440	O-Ring Face Seal, 45° Elbow, Bent Tube	7.11
470	O-Ring Face Seal, 90° Elbow (Short), Bent Tube	7.12
500	JIC 37° Male Rigid	7.5
540	JIC 37° Female Swivel	7.6
600	JIC 37° Female Swivel, 45° Elbow, Bent Elbow	7.9
640	JIC 37° Female Swivel, 90° Short Elbow, Bent Elbow	7.10
670	O-Ring Face Seal, 90° Elbow (Long) Bent Tube	7.12
840	JIC 37° Female Swivel, 90° Long Elbow, Bent Tube	7.9
940	SAE 45° Male Rigid	7.4
A00	SAE 45° Female Swivel	7.7
B	Female Swivel, Male Cone with O-Ring ,BSP Thread	7.14
B-100	Female Swivel, O-Ring, 90° Elbow, BSP Thread	7.15
B-300	Female Swivel, O-Ring, 45° Elbow, BSP Thread	7.15
B-600	Female Swivel, O-Ring, Elbow bloc 90°, BSP Thread	7.16
BM	DIN 7642 Metric Bonjo	7.16
C40	SAE 45° Inverted Flare Male Swivel, 45° Elbow, Bent Tube	7.8
C70	SAE 45° Inverted Flare Male Swivel, 90° Elbow, Bent Tube	7.8
D00	Straight Thread, O-Ring, Male Rigid	7.4
J00	Stand Pipe J Series	7.12
J-XX0	Female Swivel, O-Ring, Metric Thread	7.17
J-XX1	Female Swivel, O-Ring, Elbow 90°, Metric Thread	7.17
J-XX3	Female Swivel, O-Ring, Elbow 45°, Metric Thread	7.18
K40	Ferulok-Flareless End (SAE Male Flareless, Rigid)	7.10
N00	Metric Stand Pipe N Series	7.19
N-100	Metric Stand Pipe, 90° Elbow	7.20
N-300	Metric Stand Pipe, 45° Elbow	7.20
Q	BSP Male Rigid	7.21
S	Metric Male Rigid (DIN 3901-3902)	7.22
V00	JIS (PF) Female Swivel, 60° Female Cone	7.22
V40	JIS (PF) Female Swivel, 60° Male Cone	7.22

Hose Coupling End Connection Style Code Numbers Are Used to Develop Coupling Series Part Numbers.

**Example:** The Male Pipe Steel Coupling Part Number for a 3/8 Inch I.D. Hose and 1/4 Inch Pipe is:

**3903-06104**

Steel Coupling Series \_\_\_\_\_  
Hose I.D. Dash Size \_\_\_\_\_  
Male Pipe, Rigid (Code Number 100) \_\_\_\_\_

Plus Pipe Dash Size 04 for 1/4 Inch Pipe

## Permanently Attached Hose Couplings

### Permanently Attached Hose Couplings

Hose I.D.	Pipe Size	Part Number		Bore I.D.	Overall Length A	Cut Off B	Hex C
		Coupling	Pusher 4599				
1/8	1/8	3903-02102	MP023	.074	1.343	3/4	1/2
1/8	1/4	3903-02104	MP026	.074	1.523	15/16	5/8
3/16	1/8	3903-03102	MP001	.109	1.880	1-1/16	9/16
3/16	1/4	3903-03104	MP004	.109	2.060	1-1/4	11/16
3/16	3/8	3903-03106	MP005	.109	2.154	1-3/8	3/4
1/4	1/8	3903-04102	MP002	.156	2.130	1-1/16	5/8
1/4	1/4	3903-04104	MP004	.156	2.310	1-1/4	11/16
1/4	3/8	3903-04106	MP005	.156	2.404	1-5/16	3/4
1/4	1/2	3903-04108	MP009	.156	2.656	1-9/16	15/16
5/16	1/4	3903-05104	MP004	.219	2.313	1-1/8	11/16
5/16	3/8	3903-05106	MP005	.219	2.407	1-1/4	3/4
3/8	1/4	3903-06104	MP005	.281	2.592	1-5/16	3/4
3/8	3/8	3903-06106	MP005	.281	2.592	1-5/16	3/4
3/8	1/2	3903-06108	MP009	.281	2.844	1-9/16	15/16
1/2	1/4	3903-08104	MP008	.391	2.775	1-9/32	7/8
1/2	3/8	3903-08106	MP008	.391	2.782	1-9/32	7/8
1/2	1/2	3903-08108	MP009	.391	3.031	1-1/2	15/16
1/2	3/4	3903-08112	MP011	.391	3.035	1-1/2	1-1/8
3/4	1/2	3903-12108	MP011	.500	3.222	1-7/16	1-1/8
3/4	3/4	3903-12112	MP011	.625	3.220	1-3/8	1-1/8
1	1	3903-16116	MP013	.812	3.969	1-5/8	1-3/8
3/16	1/8	390H-03102	MP001	.109	1.880	1-1/16	9/16
3/16	1/4	390H-03104	MP004	.109	2.060	1-1/4	11/16
3/16	3/8	390H-03106	MP005	.109	2.154	1-3/8	3/4
1/4	1/8	390H-04102	MP002	.156	2.130	1-1/16	5/8
1/4	1/4	390H-04104	MP004	.156	2.310	1-1/4	11/16
1/4	3/8	390H-04106	MP005	.156	2.404	1-5/16	3/4
1/4	1/2	390H-04108	MP009	.156	2.656	1-9/16	15/16
5/16	1/4	390H-05104	MP004	.219	2.313	1-1/16	11/16
3/8	1/4	390H-06104	MP005	.281	2.592	1-5/16	3/4
3/8	3/8	390H-06106	MP005	.281	2.592	1-5/16	3/4
3/8	1/2	390H-06108	MP009	.281	2.844	1-9/16	15/16
1/2	3/8	390H-08106	MP008	.391	2.782	1-1/4	7/8
1/2	1/2	390H-08108	MP009	.391	3.031	1-1/2	15/16
1/2	3/4	390H-08112	MP011	.391	3.094	1-1/2	1-1/8
5/8	1/2	390H-10108	MP011	.469	3.236	1-5/8	1-1/8
3/4	1/2	390H-12108	MP011	.500	3.281	1-3/8	1-1/8
3/4	3/4	390H-12112	MP011	.625	3.220	1-3/8	1-1/8
1	1	390H-16116	MP013	.812	3.969	1-5/8	1-3/8
3/16	1/8	390V-03102	MP001	.082	1.880	1-1/16	9/16
3/16	1/4	390V-03104	MP004	.082	2.122	1-1/4	11/16
3/16	3/8	390V-03106	MP005	.082	2.154	1-3/8	3/4
1/4	1/8	390V-04102	MP002	.140	2.130	1-1/16	5/8
1/4	1/4	390V-04104	MP004	.140	2.310	1-1/4	11/16
1/4	3/8	390V-04106	MP005	.140	2.404	1-5/16	3/4
3/8	1/4	390V-06104	MP005	.266	2.699	1-3/8	3/4
3/8	3/8	390V-06106	MP005	.266	2.699	1-3/8	3/4
3/8	1/2	390V-06108	MP009	.266	2.951	1-5/8	15/16
3/4	3/4	390N-12112	MP011	.625	3.298	1-11/16	1-1/8
1	1	390N-16116	MP013	.813	3.966	1-13/16	1-3/8

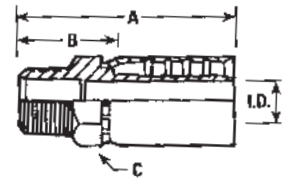

MALE PIPE RIGID

Couplings Are Manufactured From Plated Steel and Dimensions Are in Inches Unless Otherwise Specified

# Permanently Attached Hose Couplings

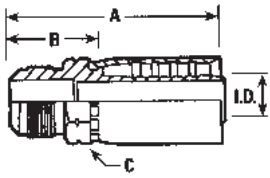

**SAE 45° MALE RIGID**

Hose I.D.	Dash Size	Thread	Part Number		Bore I.D.	Overall Length A	Cut Off B	Hex C
			Coupling	Pusher 4599				
3/16	-3	3/8-24	3903-03943	MP001	0.109	1.94	1-1/8	9/16
3/16	-4	7/16-20	3903-03944	MP001	.109	2.000	1-3/16	9/16
1/4	-5	1/2-20	3903-04945	MP002	.156	2.310	1-1/4	5/8
5/16	-6	5/8-18	3903-05946	MP005	.219	2.531	1-3/16	3/4
3/8	-5	1/2-20	3903-06945	MP005	.219	2.592	1-1/8	3/4
3/8	-6	5/8-18	3903-06946	MP005	.281	2.652	1-3/16	3/4
1/2	-6	5/8-18	3903-08946	MP008	.391	2.839	1-3/16	7/8
1/2	-8	3/4-16	3903-08948	MP008	.391	3.032	1-5/16	7/8
3/4	-10	7/8-14	3903-12950	MP011	.500	3.348	1-1/2	1-1/8
3/4	-12	1-1/16-14	3903-12952	MP011	.625	3.470	1-5/8	1-1/8
1	-16	1-3/8-12	3903-16956	FP023	.875	4.146	1-13/16	1-1/2
3/16	-3	3/8-24	3903-03943	MP001	.109	1.940	1-1/8	9/16
3/16	-4	7/16-20	390H-03944	MP001	.109	2.000	1-3/16	9/16
1/4	-5	1/2-20	390H-04945	MP002	.156	2.310	1-1/4	5/8
3/8	-6	5/8-18	390H-06946	MP005	.281	2.652	1-3/16	3/4
1/2	-8	3/4-16	390H-08948	MP008	.391	3.032	1-5/16	7/8
3/4	-10	7/8-14	390H-12950	MP011	.500	3.348	1-1/2	1-1/8
3/4	-12	1-1/16-14	390H-12952	MP011	.625	3.470	1-5/8	1-1/8
1	-16	1-3/8-12	390H-16956	FP023	.875	4.146	1-13/16	1-1/2

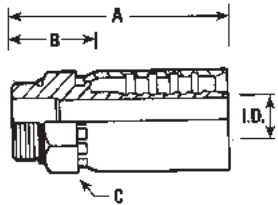

**MALE O-RING STRAIGHT THREAD**

Do not swage with O-Ring installed

Hose I.D.	Dash Size	Thread	Part Number		Bore I.D.	Overall Length A	Cut Off B	Hex C
			Coupling	Pusher 4599				
1/8	-2	5/16-24	3903-02D02	MP001	0.078	1.385	3/4	7/16
3/16	-4	7/16-20	3903-03D04	MP001	.109	1.860	1-1/16	9/16
1/4	-5	1/2-20	3903-04D05	MP002	.156	2.110	1-1/32	5/8
1/4	-6	9/16-18	3903-04D06	MP004	.156	2.141	1-1/16	11/16
5/16	-4	7/16-20	3903-05D04	MP004	.219	2.110	7/8	11/16
5/16	-5	1/2-20	3903-05D05	MP004	.219	2.110	7/8	11/16
5/16	-6	9/16-18	3903-05D06	MP004	.219	2.141	7/8	11/16
3/8	-6	9/16-18	3903-06D06	MP005	.281	2.423	1	3/4
3/8	-8	3/4-16	3903-06D08	MP008	.281	2.470	1-1/32	7/8
3/8	-10	7/8-14	3903-06D10	MP020	.281	2.656	1-1/8	1
1/2	-8	3/4-16	3903-08D08	MP009	.391	2.782	1-3/32	15/16
1/2	-10	7/8-14	3903-08D10	MP018	.391	2.844	1-5/32	1-1/16
3/4	-12	1-1/16-12	3903-12D12	MP014	0.625	3.062	1-1/4	1-1/4
1	-16	1-5/16-12	3903-16D16	MP019	.812	3.625	1-5/16	1-1/2
3/16	-4	7/16-20	390H-03D04	MP001	.109	1.860	1-1/16	9/16
3/16	-6	9/16-18	390H-06D06	MP004	.109	1.948	1-1/16	11/16
1/4	-5	1/2-20	390H-04D05	MP002	.156	2.110	1-1/32	5/8
1/4	-6	9/16-18	390H-04D06	MP004	.156	2.141	1-1/16	11/16
3/8	-6	9/16-18	390H-06D06	MP005	.281	2.423	1	3/4
3/8	-8	3/4-16	390H-06D08	MP008	.281	2.470	1-1/32	7/8
3/8	-10	7/8-14	390H-06D10	MP020	.281	2.656	1-1/8	1
1/2	-8	3/4-16	390H-08D08	MP009	.391	2.782	1-1/32	15/16
1/2	-10	7/8-14	390H-08D10	MP018	.391	2.844	1-5/32	1-1/16
1/2	-12	1-1/16-12	390H-08D12	MP014	.391	2.933	1-1/4	1-1/4
3/4	-12	1-1/16-12	390H-12D12	MP014	.625	3.062	1-1/4	1-1/4
1	-16	1-5/16-12	390H-16D16	MP019	.812	3.625	1-5/16	1-1/2

*Couplings Are Manufactured From Plated Steel and Dimensions Are in Inches Unless Otherwise Specified*

# Permanently Attached Hose Couplings

Hose I.D.	Dash Size	Thread	Part Number		Bore I.D.	Overall Length A	Cut Off B	Hex C	
			Coupling	Pusher 4599				C	D
3/16	-3	3/8-24	3903-03503	MP001	.109	1.979	15/16	9/16	
3/16	-4	7/16-20	3903-03504	MP001	.109	2.050	1-1/4	9/16	
1/4	-4	7/16-20	3903-04504	MP002	.156	2.300	1-1/4	5/8	
1/4	-5	1/2-20	3903-04505	MP002	.156	2.300	1-1/4	5/8	
1/4	-6	9/16-18	3903-04506	MP005	.156	2.400	1.320	3/4	
5/16	-5	1/2-20	3903-05505	MP002	.219	2.362	1-1/16	5/8	
5/16	-6	9/16-18	3903-05506	MP004	.219	2.300	1-5/16	11/16	
3/8	-5	1/2-20	3903-06505	MP005	.281	2.639	1-5/16	3/4	
3/8	-6	9/16-18	3903-06506	MP005	.281	2.588	1-3/8	3/4	
3/8	-8	3/4-16	3903-06508	MP007	.281	2.689	1-3/8	13/16	
1/2	-8	3/4-16	3903-08508	MP008	.391	2.876	1-7/16	7/8	
1/2	-10	7/8-14	3903-08510	MP009	.391	3.102	1-7/16	15/16	
1/2	-12	1-1/16-12	3903-08512	MP011	.391	3.145	1-1/2	1-1/8	
3/4	-12	1-1/16-12	3903-12512	MP011	.609	3.322	1-1/2	1-1/8	
3/4	-14	1-3/16-12	3903-12514	MP014	.625	3.358	1-9/16	1-1/4	
3/4	-16	1-5/16-12	3903-12516	MP013	.625	3.629	1-9/16	1-3/8	
1	-16	1-5/16-12	3903-16516	MP013	.812	3.942	1-5/8	1-3/8	

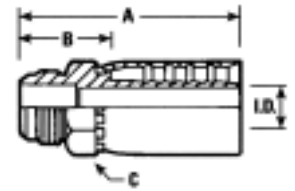

**JIC 37° MALE RIGID**

3/16	-4	7/16-20	390H-03504	MP001	.109	2.050	1-1/4	9/16	
1/4	-4	7/16-20	390H-04504	MP002	.156	2.300	1-1/4	5/8	
1/4	-5	1/2-20	390H-04505	MP002	.156	2.300	1-1/4	5/8	
1/4	-6	9/16-18	390H-04506	MP005	.156	2.400	1-5/16	3/4	
3/8	-6	9/16-18	390H-06506	MP005	.281	2.588	1-1/8	3/4	
3/8	-8	3/4-16	390H-06508	MP007	.281	2.689	1-1/4	13/16	
1/2	-8	3/4-16	390H-08508	MP008	.391	2.876	1-1/4	7/8	
1/2	-10	7/8-14	390H-08510	MP009	.391	3.102	1-1/2	15/16	
1/2	-12	1-1/16-12	390H-08512	MP011	.391	3.145	1-1/2	1-1/8	
3/4	-12	1-1/16-12	390H-12512	MP011	.609	3.322	1-1/2	1-1/8	
3/4	-14	1-3/16-12	390H-12514	MP014	.625	3.358	1-9/16	1-1/4	
3/4	-16	1-5/16-12	390H-12516	MP013	.625	3.629	1-9/16	1-3/8	
1	-16	1-5/16-12	390H-16516	MP013	.812	3.942	1-5/8	1-3/8	

Hose I.D.	Dash Size	Thread	Part Number		Bore I.D.	Overall Length A	Cut Off B	Hex	
			Coupling	Pusher 4599				C	D
1/8	1/8	1/8-27	3903-02142	MP027	.078	1.938	1-5/16	1/2	1/2
1/8	1/4	1/4-18	3903-02144	MP003	.078	2.105	1-7/16	5/8	11/16
3/16	1/8	1/8-27	3903-03142	MP027	.109	2.470	1-11/16	1/2	1/2
3/16	1/4	1/4-18	3903-03144	MP003	.109	2.637	1-13/16	5/8	11/16
1/4	1/4	1/4-18	3903-04144	MP003	.156	2.872	1-13/16	5/8	11/16
5/16	1/4	1/4-18	3903-05144	MP003	.219	2.872	1-5/8	5/8	11/16
3/8	3/8	3/8-18	3903-06146	MP006	.281	3.150	1-11/16	3/4	3/4
3/8	1/2	1/2-14	3903-06148	FP025	.281	3.375	1-7/8	3/4	7/8
1/2	1/2	1/2-14	3903-08148	MP010	.391	3.609	1-15/16	7/8	15/16
3/4	3/4	3/4-14	3903-12152	MP012	.594	3.840	2	1-1/8	1-1/8
1	1	1-11-1/2	3903-16156	MP016	.812	4.650	2-5/16	1-3/8	1-1/2

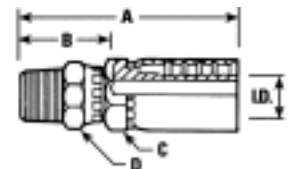

**MALE PIPE SWIVEL**

Couplings Are Manufactured From Plated Steel and Dimensions Are in Inches Unless Otherwise Specified

# Permanently Attached Hose Couplings

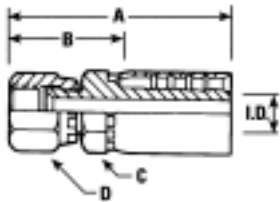

## JIC 37° FEMALE SWIVEL

Some Female swivels have double seats which make them compatible with either JIC 37° or SAE 45° male connectors.

## Torque Values (in - lbs) for Steel Female Swivel Couplings

Size	Min.	Max.
4	50	150
5	70	200
6	90	300
8	150	500
10	220	700
12	300	1,000
16	450	1,400

The maximum torques listed are based upon strength rather than sealing properties. Use of any torque within the min-max range will prevent damage or leakage.

Hose I.D.	Dash Size	Thread	Part Number		Bore I.D.	Overall Length A	Cut Off B	Hex	
			Coupling	Pusher 4599				C	D
1/8	-3	3/8-24	3903-02543	FP017	.078	1.650	1-7/16	1/2	9/16
1/8	-4	7/16-20	3903-02544	FP010	.078	1.713	1-1/16	1/2	5/8
1/8	-5	1/2-20	3903-02545	FP029	.078	1.713	1-1/16	1/2	3/4
3/16	-3	3/8-24	3903-03543	FP017	.109	2.211	1-5/16	9/16	9/16
3/16	-4	7/16-20	3903-03544	FP011	.109	2.156	1-3/8	9/16	5/8
3/16	-5	1/2-20	3903-03545	FP001	.109	2.156	1-3/8	9/16	3/4
1/4	-4	7/16-20	3903-04544	FP012	.156	2.531	1-7/16	5/8	5/8
1/4	-5	1/2-20	3903-04545	FP013	.156	2.531	1-7/16	5/8	3/4
1/4	-5	1/2-20	3903-04545-003	FP012	.156	2.531	1-7/16	5/8	5/8
1/4	-6	9/16-18	3903-04546	FP013	.156	2.531	1-7/16	5/8	3/4
5/16	-4	7/16-20	3903-05544	FP012	.219	2.588	1-7/16	5/8	5/8
5/16	-5	1/2-20	3903-05545	FP013	.219	2.531	1-1/4	5/8	3/4
5/16	-6	9/16-18	3903-05546	FP013	.219	2.531	1-3/8	5/8	3/4
3/8	-4	7/16-20	3903-06544	MP007	.281	2.688	1-1/4	13/16	5/8
3/8	-5	1/2-20	3903-06545	FP013	.234	2.688	1-1/4	3/4	3/4
3/8	-6	9/16-18	3903-06546	FP015	.281	2.813	1-1/2	3/4	3/4
3/8	-8	3/4-16	3903-06548	FP005	.281	2.813	1-3/8	3/4	15/16
3/8	-10	7/8-14	3903-06550	FP006	.281	2.969	1-1/2	7/8	1-1/16
1/2	-8	3/4-16	3903-08548	FP016	.391	3.156	1-5/8	7/8	15/16
1/2	-10	7/8-14	3903-08550	FP006	.391	3.156	1-5/8	7/8	1-1/16
1/2	-12	1-1/16-12	3903-08552	FP008	.391	3.250	1-5/8	1-1/8	1-1/4
3/4	-10	7/8-14	3903-12550	FP021	.484	3.437	1-5/8	1-1/8	1-1/16
3/4	-12	1-1/16-12	3903-12552	FP008	.625	3.437	1-5/8	1-1/8	1-1/4
3/4	-14	1-3/16-12	3903-12554	FP009	.625	3.499	1-11/16	1-3/8	1-1/2
3/4	-16	1-5/16-12	3903-12556	FP009	.625	3.500	1-11/16	1-3/8	1-1/2
1	-16	1-5/16-12	3903-16556	FP009	.812	4.062	1-11/16	1-3/8	1-1/2
3/16	-4	7/16-20	390H-03544	FP011	.109	2.156	1-3/8	9/16	5/8
3/16	-5	1/2-20	390H-03545	FP001	.109	2.156	1-3/8	9/16	3/4
1/4	-4	7/16-20	390H-04544	FP012	.156	2.531	1-7/16	5/8	5/8
1/4	-5	1/2-20	390H-04545	FP013	.156	2.531	1-7/16	5/8	3/4
1/4	-6	9/16-18	390H-04546	FP013	.156	2.531	1-7/16	5/8	3/4
5/16	-6	9/16-18	390H-05546	FP013	.219	2.531	1-1/4	5/8	3/4
3/8	-4	7/16-20	390H-06544	MP007	.281	2.688	1-1/4	13/16	5/8
3/8	-5	1/2-20	390H-06545	FP013	.234	2.688	1-1/4	3/4	3/4
3/8	-6	9/16-18	390H-06546	FP015	.281	2.813	1-3/8	3/4	3/4
3/8	-8	3/4-16	390H-06548	FP005	.281	2.813	1-3/8	3/4	15/16
3/8	-10	7/8-14	390H-06550	FP006	.281	2.969	1-1/2	7/8	1-1/16
1/2	-8	3/4-16	390H-08548	FP016	.391	3.156	1-5/8	7/8	15/16
1/2	-10	7/8-14	390H-08550	FP006	.391	3.156	1-5/8	7/8	1-1/16
1/2	-12	1-1/16-12	390H-08552	FP008	.391	3.250	1-5/8	1-1/8	1-1/4
5/8	-10	7/8-14	390H-10550	FP021	.469	3.455	1-7/8	1-1/8	1-1/16
5/8	-12	1-1/16-12	390H-10552	FP008	.469	3.455	1-7/8	1-1/8	1-1/4
3/4	-10	7/8-14	390H-12550	FP021	.625	3.437	1-5/8	1-1/8	1-1/16
3/4	-12	1-1/16-12	390H-12552	FP008	.625	3.437	1-5/8	1-1/8	1-1/4
3/4	-14	1-3/16-12	390H-12554	FP009	.625	3.499	1-11/16	1-3/8	1-1/2
3/4	-16	1-5/16-12	390H-16556	FP009	.625	3.500	1-11/16	1-3/8	1-1/2
1	-16	1-5/16-12	390H-16556	FP009	.812	4.062	1-11/16	1-3/8	1-1/2
3/16	-4	7/16-20	390V-03544	FP011	.082	2.156	1-5/16	9/16	5/8
1/4	-4	7/16-20	390V-04544	FP012	.140	2.531	1-7/16	5/8	5/8
1/4	-6	9/16-18	390V-04546	FP013	.140	2.531	1-7/16	5/8	3/4
3/8	-6	9/16-18	390V-06546	FP015	.266	2.920	1-5/8	3/4	3/4
3/8	-6	3/4-16	390V-06548	FP018	.266	2.956	1-5/8	3/4	15/16
3/4	-10	7/8-14	390N-12550	FP021	.484	3.486	1-3/4	1-1/8	1-1/16
3/4	-12	1-1/16-12	390N-12552	FP008	.625	3.486	1-3/4	1-1/8	1-1/4
1	-16	1-5/16-12	390N-16556	FP009	.812	4.062	1-3/4	1-3/8	1-1/2

Couplings Are Manufactured From Plated Steel and Dimensions Are in Inches Unless Otherwise Specified

# Permanently Attached Hose Couplings

Hose I.D.	Dash Size	Thread	Part Number		Bore I.D.	Overall Length A	Cut Off B	Hex	
			Coupling	Pusher 4599				C	D
3/16	-4	7/16-20	3903-03544	FP011	.109	2.156	1-3/8	9/16	5/8
3/16	-5	1/2-20	3903-03545	FP011	.109	2.156	1-3/8	9/16	3/4
1/4	-4	7/16-20	3903-04544	FP012	.156	2.531	1-7/16	5/8	5/8
1/4	-5	1/2-20	3903-04545	FP013	.156	2.531	1-7/16	5/8	3/4
1/4	-6	5/8-18	3903-04A06	FP003	.156	2.531	1-7/16	5/8	13/16
5/16	-5	1/2-20	3903-05545	FP013	.219	2.531	1-1/4	5/8	3/4
5/16	-6	5/8-18	3903-05A06	FP003	.219	2.531	1-1/4	5/8	13/16
3/8	-6	5/8-18	3903-06A06	FP014	.281	2.813	1-3/8	3/4	13/16
3/8	-8	3/4-16	3903-06548	FP005	.281	2.813	1-3/8	3/4	15/16
1/2	-8	3/4-16	3903-08548	FP016	.391	3.156	1-1/2	7/8	15/16
1/2	-10	7/8-14	3903-08550	FP006	.391	3.156	1-1/2	7/8	1-1/16
3/4	-12	1-1/16-14	3903-12A12	FP008	.625	3.437	1-5/8	1-1/8	1-1/4
1	-16	1-3/8-12	3903-16A16	FP023	.812	4.250	1-15/16	1-1/2	1-5/8
3/16	-4	7/16-20	390H-03544	FP011	.109	2.156	1-3/8	9/16	5/8
3/16	-5	1/2-20	390H-03545	FP001	.109	2.156	1-3/8	9/16	3/4
1/4	-4	7/16-20	390H-04544	FP012	.156	2.531	1-7/16	5/8	5/8
1/4	-5	1/2-20	390H-04545	FP013	.156	2.531	1-7/16	5/8	3/4
1/4	-6	5/8-18	390H-04A06	FP003	.156	2.531	1-7/16	5/8	13/16
3/8	-6	5/8-18	390H-06A06	FP014	.281	2.813	1-3/8	3/4	13/16
3/8	-8	3/4-16	390H-06548	FP005	.281	2.813	1-3/8	3/4	15/16
1/2	-8	3/4-16	390H-08548	FP016	.391	3.156	1-1/2	7/8	15/16
1/2	-10	7/8-14	390H-08550	FP006	.391	3.156	1-1/2	7/8	1-1/16
3/4	-12	1-1/16-14	390H-12A12	FP008	.625	3.437	1-5/8	1-1/8	1-1/4
1	-16	1-3/8-12	390H-16A16	FP023	.812	4.250	1-15/16	1-1/2	1-5/8

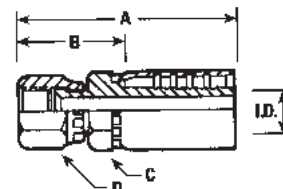

## SAE 45° FEMALE SWIVEL

Some Female swivels have double seats which make them compatible with either JIC 37° or SAE 45° male connectors.

Hose I.D.	Dash Size	Thread	Part Number		Bore I.D.	Overall Length A	Cut Off B	Hex C
			Coupling	Pusher 4599				
1/8	1/8	1/8-27	3903-02202	FP012	.078	1.713	1-1/8	9/16
3/16	1/8	1/8-27	3903-03202	FP026	.109	1.875	7/8	9/16
1/4	1/4	1/4-18	3903-04204	FP002	.156	2.344	1-1/4	3/4
1/4	3/8	3/8-18	3903-04206	FP004	.156	2.440	1-5/16	7/8
3/8	1/4	1/4-18	3903-06204	FP002	.281	2.532	1-1/16	3/4
3/8	3/8	3/8-18	3903-06206	FP004	.281	2.626	1-3/16	7/8
3/8	1/2	1/2-14	3903-06208	FP006	.281	2.938	1-1/2	1-1/16
1/2	1/2	1/2-14	3903-08208	FP007	.391	3.032	5/16	1-1/16
3/16	1/8	1/8-27	390H-03202	FP026	.109	2.000	7/8	9/16
3/16	1/4	1/4-18	390H-03204	FP002	.109	2.154	2-5/16	3/4
1/4	1/4	1/4-18	390H-04204	FP002	.156	2.344	1-1/4	3/4
1/4	3/8	3/8-18	390H-04206	FP004	.156	2.440	1-5/16	7/8
3/8	3/8	3/8-18	390H-06206	FP004	.281	2.626	1-3-/16	7/8
3/8	1/2	1/2-14	390H-06208	FP006	.281	2.938	1-1/2	1-1/16
1/2	1/2	1/2-14	390H-08208	FP007	.391	3.032	5/16	1-1/16

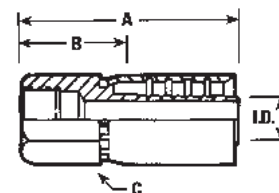

## FEMALE NPT RIGID

Couplings Are Manufactured From Plated Steel and Dimensions Are in Inches Unless Otherwise Specified



# Permanently Attached Hose Couplings

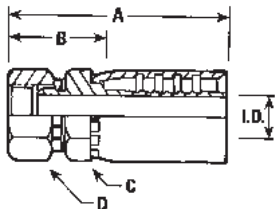

**30° INVERTED FLARE NPSM**

Hose I.D.	Dash Size	Thread	Part Number		Bore I.D.	Overall Length A	Cut Off B	Hex	
			Coupling	Pusher 4599				C	D
1/8	1/4	1/4-18	3903-02244	FP024	.078	1.688	1-1/16	1/2	11/16
3/16	1/4	1/4-18	3903-03244	FP002	.109	2.075	1-1/8	5/8	3/4
1/4	1/4	1/4-18	3903-04244	FP002	.156	2.375	1-5/16	5/8	3/4
1/4	3/8	3/8-18	3903-04246	FP004	.156	2.464	1-3/8	3/4	7/8
5/16	1/4	1/4-18	3903-05244	FP013	.219	2.530	1-1/4	3/4	3/4
3/8	1/4	1/4-18	3903-06244	FP013	.218	2.728	1-7/16	3/4	3/4
3/8	3/8	3/8-18	3903-06246	FP004	.281	2.656	1-3/16	3/4	7/8
1/2	1/2	1/2-14	3903-08248	FP018	.391	3.062	1-3/8	1	1
3/4	3/4	3/4-14	3903-12252	FP008	.625	3.430	1-5/8	1-1/8	1-1/4
1	1	1-11-1/2	3903-16256	FP009	.812	4.060	1-3/4	1-3/8	1-1/2
3/16	1/4	1/4-18	390H-03244	FP002	.109	2.120	1-5/16	5/8	3/4
1/4	1/4	1/4-18	390H-04244	FP002	.156	2.375	1-5/16	5/8	3/4
3/8	1/4	1/4-18	390H-06244	FP013	.218	2.656	1-3/8	3/4	3/4
3/8	3/8	3/8-18	390H-06246	FP004	.281	2.656	1-3/16	7/8	7/8
1/2	1/2	1/2-14	390H-08248	FP018	.391	3.062	1-3/8	1	1
3/4	3/4	3/4-14	390H-12252	FP008	.625	3.430	1-5/8	1-1/8	1-1/4
1	1	1-11-1/2	390H-16256	FP009	.812	4.06	1-11/16	1-3/8	1-1/2

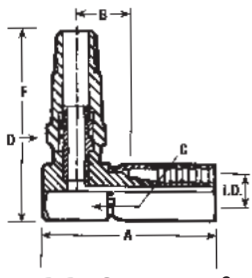

**MALE PIPE SWIVEL 90° ELBOW**

Hose I.D.	Dash Size	Thread	Part Number		Bore I.D.	Overall Length A	Cut Off B	Hex		Drop F
			Coupling	Pusher 4599				C	D	
1/4	1/4	1/4-18	3903-04274	SP008	.156	2.312	1-1/4	5/8	5/8	1.95
3/8	3/8	3/8-18	3903-06276	SP011	.281	2.625	7/8	13/16	3/4	2.04
1/2	1/2	1/2-14	3903-08278	SP009	.391	3.030	15/16	1	15/16	2.45
3/8	3/8	3/8-18	390H-06276	SP011	.281	2.625	7/8	13/16	3/4	2.04
1/2	1/2	1/2-14	390H-08278	SP009	.391	3.030	15/16	1	15/16	2.45

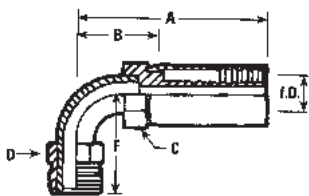

**90° BENT TUBE WITH SAE 45° INVERTED FLARE SWIVEL**

Hose I.D.	Dash Size	Thread	Part Number		Bore I.D.	Overall Length A	Cut Off B	Hex		Drop F
			Coupling	Pusher 4599				C	D	
3/8	-6	5/8-18	3903-06C76	TP206	.281	2.625	1-3/16	3/4	5/8	1.660

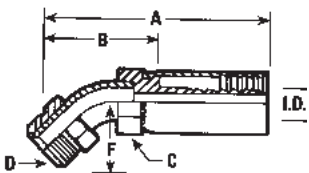

**45° BENT TUBE WITH 45° INVERTED FLARE SWIVEL**

Hose I.D.	Dash Size	Thread	Part Number		Bore I.D.	Overall Length A	Cut Off B	Hex		Drop F
			Coupling	Pusher 4599				C	D	
3/8	-6	5/8-18	3903-06C46	TP206	.281	3.299	1-7/8	3/4	5/8	0.965
3/8	-6	5/8-18	390H-06C46	TP206	.281	3.299	1-7/8	3/4	5/8	0.965

*Couplings Are Manufactured From Plated Steel and Dimensions Are in Inches Unless Otherwise Specified*

# Permanently Attached Hose Couplings

Hose I.D.	Dash Size	Thread	Part Number		Bore I.D.	Overall Length A	Cut Off B	Hex		Drop F
			Coupling	Pusher 4599				C	D	
3/16	-4	7/16-20	3903-03604	TP204	.109	2.303	1-1/2	9/16	9/16	.467
1/4	-4	7/16-20	3903-04604	TP204	.156	2.553	1-1/2	5/8	9/16	.467
1/4	-5	1/2-20	3903-04605	TP205	.156	2.733	1-5/8	5/8	5/8	.526
1/4	-6	9/16-18	3903-04606	TP206	.156	3.045	1-15/16	5/8	11/16	.039
5/16	-6	9/16-18	3903-05606	TP206	.219	3.110	1-15/16	5/8	11/16	.390
3/8	-6	9/16-18	3903-06606	TP206	.281	3.300	1-15/16	3/4	11/16	.390
3/8	-8	3/4-16	3903-06608	TP208	.281	3.540	2-1/4	3/4	7/8	.550
1/2	-8	3/4-16	3903-08608	TP308	.391	3.284	1-5/8	7/8	7/8	.713
1/2	-10	7/8-14	3903-08610	TP310	.391	3.910	1-7/8	7/8	1	.839
3/4	-12	1-1/16-12	3903-12612	TP312	.625	4.329	2-1/4	1-1/8	1-1/4	.630
1	-16	1-5/15-12	3903-16616	TP316	.812	5.019	2-5/8	1-3/8	1-1/2	1.146
3/16	-4	7/16-20	390H-03604	TP204	.109	2.303	1-1/2	9/16	9/16	.467
1/4	-4	7/16-20	390H-04604	TP204	.156	2.553	1-1/2	5/8	9/16	0.467
1/4	-5	1/2-20	390H-04605	TP205	.156	2.645	1-9/16	5/8	5/8	.526
3/8	-6	9/16-18	390H-06606	TP206	.281	3.300	1-15/16	3/4	11/16	.390
3/8	-8	3/4-16	390H-06608	TP208	.281	3.540	2-1/4	3/4	7/8	.550
1/2	-8	3/4-16	390H-08608	TP308	.391	3.284	1-5/8	7/8	7/8	.713
1/2	-10	7/8-14	390H-08610	TP310	.391	3.910	2-1/4	7/8	1	.630
3/4	-12	1-1/16-12	390H-12612	TP312	.625	4.329	2-7/16	1-1/8	1-1/4	1.118
1	-16	1-5/16-12	390H-16616	TP316	.812	5.019	2-5/8	1-3/8	1-1/2	1.146

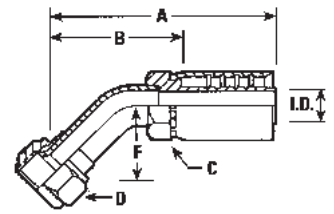

**45° BENT TUBE FEMALE SWIVEL, JIC 37°**

Hose I.D.	Dash Size	Thread	Part Number		Bore I.D.	Overall Length A	Cut Off B	Hex		Drop F
			Coupling	Pusher 4599				C	D	
1/8	-3	3/8-24	3903-02843	TP204	.078	1.525	15/16	1/2	7/16	1.625
3/16	-4	7/16-20	3903-03844	TP204	.109	2.063	1-1/4	9/16	9/16	1.800
1/4	-4	7/16-20	3903-04844	TP204	.156	2.310	1-1/4	5/8	9/16	1.800
1/4	-5	1/2-20	3903-04845	TP205	.156	2.375	1.295	5/8	5/8	1.770
1/4	-6	9/16-18	3903-04846	TP206	.156	2.438	1-3/16	5/8	11/16	2.180
5/16	-6	9/16-18	3903-05846	TP206	.219	2.438	1-3/16	5/8	11/16	2.180
3/8	-6	9/16-18	3903-06846	TP206	.281	3.240	1-15/16	3/4	11/16	2.180
3/8	-8	3/4-16	3903-06848	TP208	.281	2.751	1-5/16	3/4	7/8	2.430
1/2	-8	3/4-16	3903-08848	TP308	.391	2.938	1-5/16	7/8	7/8	2.430
1/2	-10	7/8-14	3903-08850	TP310	.391	3.770	2-3/16	7/8	1	2.570
3/4	-12	1-1/16-12	3903-12852	TP312	.625	3.875	2-1/16	1-1/8	1-1/4	3.730
3/4	-12	1-3/16-12	3903-12854	TP314	.625	4.120	2-5/16	1-1/4	1-3/8	4.330
1	-16	1-5/16-12	3903-16856	TP316	.812	4.688	2-5/16	1-3/8	1-1/2	4.330
3/16	-4	7/16-20	390H-03844	TP204	.109	2.063	1-1/4	9/16	9/16	1.800
1/4	-4	7/16-20	390H-04844	TP204	.156	2.310	1-1/4	5/8	9/16	1.800
1/4	-5	1/2-20	390H-04845	TP205	.156	2.375	1-5/16	5/8	5/8	1.770
1/4	-6	9/16-18	390H-04846	TP206	.156	2.438	1-3/16	5/8	11/16	2.180
3/8	-6	9/16-18	390H-06846	TP206	.281	3.240	1-15/16	3/4	11/16	2.180
3/8	-8	3/4-16	390H-06848	TP208	.281	2.751	1-5/16	3/4	7/8	2.430
1/2	-8	3/4-16	390H-08848	TP308	.391	2.938	1-5/16	7/8	7/8	2.430
1/2	-10	7/8-14	390H-08850	TP310	.391	3.770	2-3/16	7/8	1	2.570
5/8	-10	7/8-14	390H-10850	TP312	.469	3.330	1-13/16	1-1/8	1	2.570
3/4	-12	1-1/16-12	390H-12852	TP312	.625	3.875	2-1/16	1-1/8	1-1/4	3.730
3/4	-12	1-3/16-12	390H-12854	TP314	.625	4.120	2-5/16	1-1/4	1-3/8	4.330
1	-16	1-5/16-12	390H-16856	TP316	.812	4.688	2-3/8	1-3/8	1-1/2	4.330

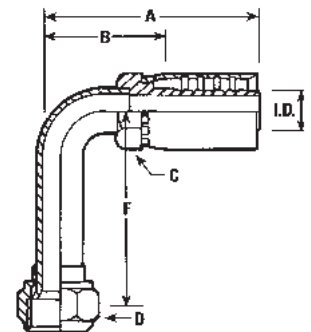

**90° LONG BENT TUBE FEMALE SWIVEL, JIC 37°**

*Couplings Are Manufactured From Plated Steel and Dimensions Are in Inches Unless Otherwise Specified*

# Permanently Attached Hose Couplings

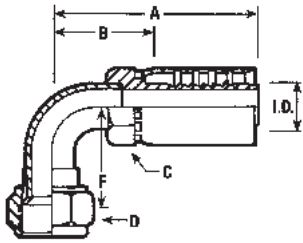

**90° SHORT BENT TUBE FEMALE SWIVEL, JIC 37°**

**Torque Values (in - lbs) for Bent Tube Couplings with Female Swivels**

Size	Min.	Max.
4	37	112
5	52	150
6	67	225
8	112	375
10	165	525
12	225	750
16	337	1,050

The maximum torques listed are based upon strength rather than sealing properties. Use of any torque within the min-max range will prevent damage or leakage.

Hose I.D.	Dash Size	Thread	Part Number		Bore I.D.	Overall Length A	Cut Off B	Hex		Drop F
			Coupling	Pusher 4599				C	D	
1/8	-3	3/8-24	3903-02643	TP204	.078	1.525	15/16	1/2	7/16	.750
1/8	-4	7/16-20	3903-02644	SP038	.078	2.103	1-1/16	1/2	9/16	.875
3/16	-4	7/16-20	3903-03644	TP204	.109	2.550	1-11/16	9/16	9/16	.680
1/4	-4	7/16-20	3903-04644	TP204	.156	2.755	1-11/16	5/8	9/16	.680
1/4	-5	1/2-20	3903-04645	TP205	.156	2.375	1-5/16	5/8	5/8	1.000
1/4	-6	9/16-18	3903-04646	TP206	.156	3.250	1-15/16	5/8	11/16	1.125
5/16	-5	1/2-20	3903-05645	TP205	.219	2.375	1-1/8	5/8	5/8	1.000
5/16	-6	9/16-18	3903-05646	TP206	.219	3.060	1-7/8	5/8	11/16	1.125
3/8	-4	7/16-20	3903-06644	TP204	.156	2.501	1-1/16	3/4	9/16	.875
3/8	-6	9/16-18	3903-06646	TP206	.281	3.250	1-15/16	3/4	11/16	.850
3/8	-8	3/4-16	3903-06648	TP208	.281	3.340	2	3/4	7/8	1.090
3/8	-10	7/8	3903-06650	TP310	.281	2.875	1-7/16	7/8	1	1.625
1/2	-8	3/4-16	3903-08648	TP308	.391	3.530	1-15/16	7/8	7/8	1.090
1/2	-10	7/8-14	3903-08650	TP310	.391	3.740	2-3/16	7/8	1	1.230
3/4	-10	7/8-14	3903-12650	TP312	.500	3.380	1-9/16	1-1/8	1	1.625
3/4	-12	1-1/16-12	3903-12652	TP312	.625	3.875	2-1/16	1-1/8	1-1/4	2.312
3/4	-12	1-3/16-12	3903-12654	TP314	.625	4.120	2-5/16	1-1/4	1-3/8	2.495
3/4	-16	1-5/16-12	3903-12656	TP314	.625	4.125	2-5/16	1-1/4	1-1/2	2.500
1	-12	1-1/16-12	3903-16652	TP316	.578	4.438	1-1/8	1-3/8	1-1/4	2.312
1	-16	1-5/16-12	3903-16656	TP316	.812	4.750	2-5/16	1-3/8	1-1/2	2.500
3/16	-4	7/16-20	390H-03644	TP204	.109	2.550	1-11/16	9/16	9/16	.680
1/4	-4	7/16-20	390H-04644	TP204	.156	2.755	1-11/16	5/8	9/16	.680
1/4	-5	1/2-20	390H-04645	TP205	.156	2.375	1-5/16	5/8	5/8	1.000
1/4	-6	9/16-18	390H-04646	TP206	.156	2.407	1-5/16	5/8	11-1/16	1.125
5/16	-6	9/16-18	390H-05646	TP206	.219	3.060	15/16	5/8	11/16	1.125
3/8	-4	7/16-20	390H-06644	TP204	.156	2.501	1-1/16	3/4	9/16	.875
3/8	-6	9/16-18	390H-06646	TP206	.281	3.250	1-15/16	3/4	11/16	.850
3/8	-8	3/4-16	390H-06648	TP208	.281	3.340	2	3/4	7/8	1.090
3/8	-10	7/8-14	390H-06650	TP310	.281	2.875	1-5/16	7/8	1	1.625
1/2	-8	3/4-16	390H-08648	TP308	.391	3.530	1-15/16	7/8	7/8	1.090
1/2	-10	7/8-14	390H-08650	TP310	.391	3.740	2-3/16	7/8	1	1.230
5/8	-12	1-1/16-12	390H-10652	TP312	.469	3.893	2-5/16	1-1/8	1-1/4	2.312
3/4	-10	7/8-14	390H-12650	TP312	.625	3.380	1-9/16	1-1/8	1	1.625
3/4	-12	1-1/16-12	390H-12652	TP312	.625	3.875	2-1/16	1-1/8	1-1/4	2.312
3/4	-14	1-3/16-12	390H-12654	TP314	.625	4.120	2-5/16	1-1/4	1-3/8	2.500
3/4	-16	1-5/16-12	390H-12656	TP316	.625	4.125	2-5/16	1-1/4	1-1/2	2.500
16	-12	1-1/16-12	390H-16652	TP316	.578	4.438	2-1/8	1-3/8	1-1/4	2.312
1	-16	1-5/16-12	390H-16656	TP316	.812	4.750	2-5/16	1-3/8	1-1/2	2.500

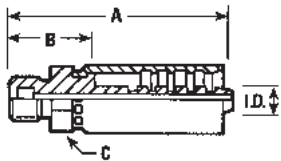

**SAE FLARELESS MALE END**

Hose I.D.	Dash Size	Thread	Part Number		Bore I.D.	Overall Length A	Cut Off B	Hex C
			Coupling	Pusher 4599				
1/4	-4	7/16-20	3903-04K44	MP002	.156	2.203	15/16	5/8
3/8	-6	9/16-18	3903-06K46	MP005	.282	2.495	1-1/16	3/4
1/2	-8	3/4-16	3903-06K48	MP008	.391	2.781	1-3/16	7/8

*Couplings Are Manufactured From Plated Steel and Dimensions Are in Inches Unless Otherwise Specified*

# Permanently Attached Hose Couplings

Hose I.D.	Dash Size	Thread	Part Number		Bore I.D.	Overall Length A	Cut Off B	Hex	
			Coupling	Pusher 4599				C	D
1/8	-4	9/16-18	3903-02404	MP045	.078	1.822	1-3/16	5/8	11/16
1/4	-4	9/16-18	3903-04404	MP045	0.156	2.597	1-1/2	5/8	11/16
5/16	-4	9/16-18	3903-05404	MP045	.219	2.660	1-1/2	5/8	11/16
5/16	-6	11/16-16	3903-05406	MP037	.375	2.745	1-9/16	5/8	13/16
3/8	-6	11/16-16	3903-06406	SP031	.272	2.752	1-7/16	3/4	7/8
3/8	-8	13/16-16	3903-06408	MP046	.272	3.220	1-7/8	3/4	15/16
1/2	-8	13/16-16	3903-08408	FP040	.382	3.125	1-9/16	15/16	1-1/16
3/4	-12	1-3/16-12	3903-12412	MP039	.610	3.885	2-1/8	1-1/8	1-3/8
1	-16	1-7/16-12	3903-16416	MP042	.811	4.36	2-1/8	1-3/8	1-5/8
3/4	-12	1-3/16-12	390N-12412	MP039	.584	3.885	2-1/8	1-1/8	1-3/8
1	-16	1-7/16-12	390N-16416	MP042	.811	4.360	2-1/8	1-3/8	1-5/8

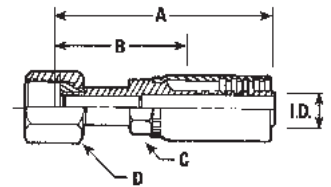

**STRAIGHT WITH FEMALE SWIVEL, O-RING FACE SEAL**

Hose I.D.	Dash Size	Thread	Part Number		Bore I.D.	Overall Length A	Cut Off B	Hex	
			Coupling	Pusher 4599				C	D
1/4	-4	9/16-18	390H-04404	MP045	.156	2.597	1-1/2	5/8	11/16
3/8	-6	11/16-16	390H-06406	SP031	.272	2.752	1-7/16	3/4	7/8
1/2	-8	13/16-16	390H-08408	FP040	.382	3.285	1-11/16	7/8	1-1/16
1/2	-10	1-14	390H-08410	MP059	.382	3.39	1-7/8	7/8	1-1/8
5/8	-10	1-14	390H-10410	TP312	.469	3.780	2-3/16	1-1/8	1-1/8
5/8	-12	1-3/16-12	390H-10412	MP039	.469	3.840	2-1/4	1-1/8	1-3/8
3/4	-12	1-3/16-12	390H-12412	MP039	.610	3.885	2-1/8	1-1/8	1-3/8
1	-16	1-7/16-12	390H-16416	MP042	.811	4.36	2-1/8	1-3/8	1-5/8

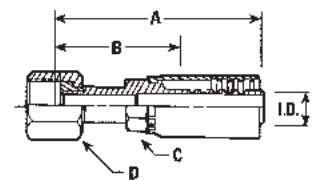

**STRAIGHT WITH FEMALE SWIVEL, O-RING FACE SEAL**

Hose I.D.	Dash Size	Thread	Part Number		Bore I.D.	Overall Length A	Cut Off B	Hex		Drop F
			Coupling	Pusher 4599				C	D	
1/8	-4	9/16-18	3903-02444	TP204*	.078	1.963	1-5/16	1/2	11/16	.409
1/4	-4	9/16-18	3903-04444	TP204	.156	2.551	1-1/2	5/8	11/16	.409
5/16	-4	9/16-18	3903-05444	TP204	.219	2.610	1-7/16	5/8	11/16	.409
5/16	-6	11/16-16	3903-05446	TP206	.219	2.632	1-1/2	5/8	13/16	.429
3/8	-6	11/16-16	3903-06446	TP206	.281	2.825	1-1/2	3/4	13/16	.429
1/2	-8	13/16-16	3903-08448	TP308	.391	3.315	1-3/4	7/8	15/16	.590
3/4	-12	1-3/16-12	3903-12452	TP312	.625	3.980	2-1/4	1-1/8	1-3/8	.831
1/4	-4	9/16-18	390H-04444	TP204	.156	2.551	1-1/2	5/8	11/16	.409
3/8	-6	11/16-16	390H-06446	TP206	.281	2.825	1-1/2	3/4	13/16	.429
1/2	-8	13/16-16	390H-08448	TP308	.391	3.315	1-3/4	7/8	15/16	.590
3/4	-12	1-3/16-12	390H-12452	TP312	.625	3.980	2-1/4	1-1/8	1-3/8	.831

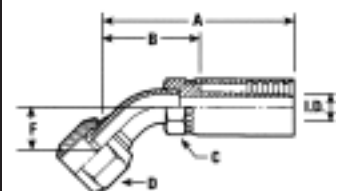

**FEMALE SWIVEL, 45° ELBOW O-RING FACE SEAL**

\* Requires a 3/16" shim

Couplings Are Manufactured From Plated Steel and Dimensions Are in Inches Unless Otherwise Specified

# Permanently Attached Hose Couplings

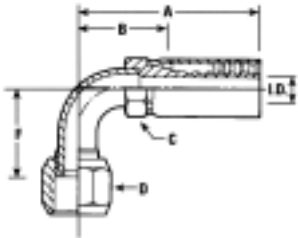

**FEMALE SWIVEL, 90° ELBOW O-RING FACE SEAL (SHORT DROP)**

Hose I.D.	Dash Size	Thread	Part Number		Bore I.D.	Overall Length A	Cut Off B	Hex		Drop F
			Coupling	Pusher 4599				C	D	
1/8	-4	9/16-18	3903-02474	TP204*	.078	1.723	1-1/8	1/2	11/16	.779
1/4	-4	9/16-18	3903-04474	TP204	.156	2.313	1-1/4	5/8	11/16	.779
5/16	-4	9/16-18	3903-05474	TP204	.219	2.370	1-3/16	5/8	11/16	.779
5/16	-6	11/16-16	3903-05476	TP206	.281	3.100	1-15/16	3/4	13/16	.902
3/8	-6	11/16-16	3903-06476	TP206	.281	3.300	2	3/4	13/16	.902
1/2	-8	13/16-16	3903-08478	TP308	.391	3.043	1-1/2	7/8	15/16	1.150
3/4	-12	1-3/16-12	3903-12482	TP312	.625	4.475	2-3/4	1-1/8	1-3/8	1.882
1/4	-4	9/16-18	390H-04474	TP204	.156	2.313	1-1/4	5/8	11/16	.779
3/8	-6	11/16-16	390H-06476	TP206	.281	3.300	2	3/4	13/16	.902
1/2	-8	13/16-16	390H-08478	TP308	.391	3.043	1-1/2	7/8	15/16	1.150
3/4	-12	1-3/16-12	390H-12482	TP312	.625	4.475	2-3/4	1-1/8	1-3/8	1.882
3/4	-12	1-3/16-12	390N-12482	TP312	.625	4.475	2-3/4	1-1/8	1-3/8	1.882

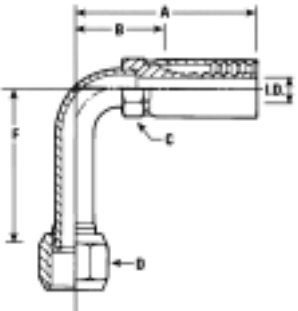

**FEMALE SWIVEL, 90° ELBOW O-RING FACE SEAL (LONG DROP)**

Hose I.D.	Dash Size	Thread	Part Number		Bore I.D.	Overall Length A	Cut Off B	Hex		Drop F
			Coupling	Pusher 4599				C	D	
1/4	-4	9/16-18	3903-04674	TP204	.156	2.865	1-3/4	5/8	11/16	1.779
5/16	-4	9/16-18	3903-05674	TP204	.219	2.370	1-3/16	5/8	11/16	1.779
5/16	-6	11/16-16	3903-05676	TP206	.281	3.100	1-15/16	3/4	13/16	2.130
3/8	-6	11/16-16	3903-06676	TP206	.281	3.300	2	3/4	13/16	2.130
1/2	-8	13/16-16	3903-08678	TP308	.391	3.043	1-1/2	7/8	15/16	2.512
3/4	-12	1-3/16-12	3903-12682	TP312	.625	4.475	2-3/4	1-1/8	1-3/8	3.779
1/4	-4	9/16-18	390H-04674	TP204	.156	2.313	1-1/4	5/8	11/16	1.779
3/8	-6	11/16-16	390H-06676	TP206	.281	3.300	2	3/4	13/16	2.130
1/2	-8	13/16-16	390H-08678	TP308	.391	3.043	1-1/2	7/8	15/16	2.512
3/4	-12	1-3/16-12	390H-12682	TP312	.625	4.475	2-3/4	1-1/8	1-3/8	3.779
3/4	-12	1-3/16-12	390N-12682	TP312	.625	4.475	2-3/4	1-1/8	1-3/8	3.779

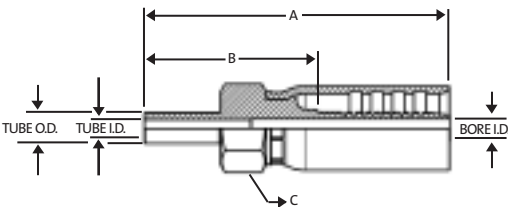

**STAND PIPE J SERIES**

Hose I.D.	Tube O.D.	Part Number		Bore I.D.	Overall Length A	Cut Off B	Hex C
		Coupling	Pusher 4599				
1/4	0.250	3903-04J04	TP204	.156	2.50	1-7/16	5/8
3/8	0.375	3903-06J06	TP206	.281	2.81	1-1/2	3/4
1/2	0.500	3903-08J08	TP308	.391	3.26	1-11/16	7/8
1/4	0.250	390H-04J04	TP204	.156	2.50	1-7/16	5/8
3/8	0.375	390H-06J06	TP206	.281	2.81	1-1/2	3/4
1/2	0.500	390H-08J08	TP308	.391	3.26	1-11/16	7/8

*Couplings Are Manufactured From Plated Steel and Dimensions Are in Inches Unless Otherwise Specified*

# Permanently Attached Hose Couplings

Hose I.D.	Dash Size	Thread	Part Number		Bore I.D.	Overall Length A	Cut Off B	Hex	
			Coupling	Pusher 4599				C	D
3/16	-4	7/16-20	390A-03544	FP011	.109	2.213	1-5/16	9/16	5/8
1/4	-4	7/16-20	390A-04544	FP012	.156	2.526	1-7/16	5/8	5/8
3/8	-6	9/16-18	390A-06546	FP015	.281	2.870	1-9/16	3/4	3/4
1/2	-8	3/4-16	390A-08548	FP016	.391	3.214	1-9/16	7/8	15/16
1/2	-10	7/8-14	390A-08550	FP006	.391	3.214	1-9/16	7/8	1-1/16
3/4	-12	1-1/16-12	390A-12552	FP008	.625	3.495	1-3/4	1-1/8	1-1/4
1	-16	1-5/16-12	390A-16556	FP009	.813	4.057	1-7/8	1-3/8	1-1/2

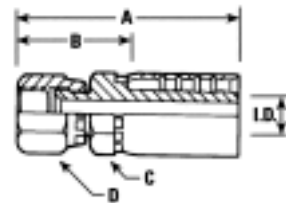

**JIC 37° FEMALE SWIVEL, AISI 316 SERIES STAINLESS STEEL**

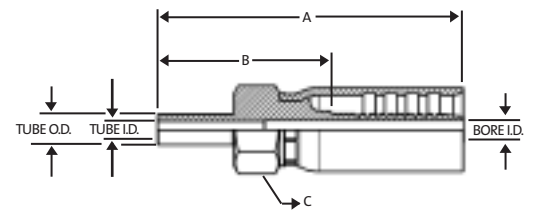

**STAND PIPE, STRAIGHT, STAINLESS STEEL**

Hose I.D.	Pipe Size	Part Number		Pusher 4599	Bore I.D.	Overall Length A	Cut Off B	Hex C
		Thread	Coupling					
1/4	1/4	-	390A-04J04	TP204	.156	2.860	1-13/16	5/8
3/8	3/8	-	390A-06J06	TP206	.281	3.235	1-15/16	3/4
1/2	1/2	-	390A-08J08	TP208	.391	3.500	1-15/16	7/8
1/4	0.250	-	390L-04J04	TP204	.156	2.50	1-7/16	5/8
3/8	0.375	-	390L-06J06	TP206	.281	2.81	1-1/2	3/4
1/2	0.500	-	390L-08J08	TP308	.391	3.26	1-11/16	7/8

Hose I.D.	Pipe Size	Part Number		Pusher 4599	Bore I.D.	Overall Length A	Cut Off B	Hex	
		Thread	Brass Coupling					C	D
1/4	-4	7/16-20	3906-04544	FP022	.156	2.219	1-1/8	11/16	11/16
1/4	-6	9/16-18	3906-04546	FP003	.156	2.344	1-1/2	11/16	13/16
3/8	-6	9/16-18	3906-06546	FP014	.281	2.813	1-3/8	3/4	13/16

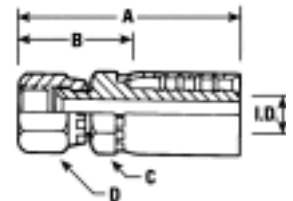

**JIC 37° FEMALE SWIVEL BRASS**

Hose I.D.	Pipe Size	Part Number		Pusher 4599	Bore I.D.	Overall Length A	Cut Off B	Hex C
		Thread	Coupling					
1/4	1/4	-	3906-04104	MP004	.156	2.048	1-1/8	11/16

*Couplings Are Manufactured From Plated Steel and Dimensions Are in Inches Unless Otherwise Specified*

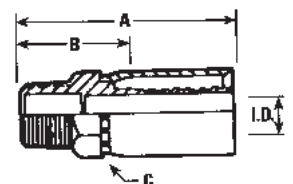

**MALE PIPE RIGID BRASS**

**Complete Line of Stainless Steel Couplings Are Available. Contact Factory for Additional Information.**

# Metric, BSP and JIS Hose Couplings

## Metric, BSP and JIS Hose Couplings

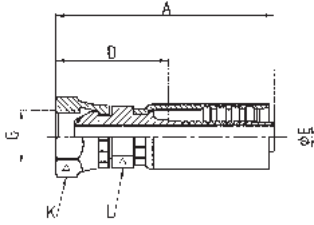

**CODE B  
FEMALE SWIVEL, WITH  
O-RING, BSP THREAD**

Hose		Dash Size G	Coupling	A mm	D mm	Dia.E mm	L mm	K mm	Pusher 4599
D.N.	I.D.								
3	1/8"	1/8"-28	*7903-02P02	40.9	26.6	2.08	14	14	4599-FP501
<b>*Without O-Ring</b>									
4	3/16"	1/4"-19	7903-03B04	54.8	35.8	2.77	14	19	4599FP002
6	1/4"	1/4"-19	7903-04B04	58.8	32.8	3.96	14	19	4599-FP002
8	5/16"	1/4"-19	7903-05B04	61.1	33.1	5.56	17	9	4599-FP002
10	3/8"	1/4"-19	7903-06B04	66	34	7.14	17	19	4599-FP002
4	1/4"	3/8"-19	7903-04B06	60.7	34.7	3.96	17	22	4599-FP503
8	5/16"	3/8"-19	7903-05B06	63	35	5.56	17	22	4599-FP503
10	3/8"	3/8"-19	7903-06B06	67.8	35.8	7.14	17	22	4599-FP503
10	3/8"	1/2"-14	7903-06B08	72.5	40.5	7.14	18	27	4599-FP505
13	1/2"	3/8"-19	7903-08B06	74.9	36.9	9.93	22	22	4599-FP503-001
13	1/2"	1/2"-14	7903-08B08	77.4	39.4	9.93	22	27	4599-FP505
13	1/2"	5/8"-14	7903-08B10	82.1	44.1	9.93	22	30	4599-FP506
13	1/2"	3/4"-14	7903-08B12	82.1	44.1	9.93	26	32	4599-FP506
20	3/4"	3/4"-14	7903-12B12	86.9	43.9	15.88	28	32	4599-FP506
25	1"	1"-11	7903-16B16	101.7	44.7	20.65	36	41	4599-FP508
<b>790H Series</b>									
4	3/16"	1/4"-19	790H-03B04	54.8	35.8	2.77	14	19	4599FP002
6	1/4"	1/4"-19	790H-04B04	58.8	32.8	3.96	14	19	4599-FP002
10	3/8"	1/4"-9	790H-06B04	66	34	7.14	17	19	4599-FP002
4	1/4"	3/8"-19	790H-04B06	60.7	34.7	3.96	17	22	4599-FP503
10	3/8"	3/8"-19	790H-06B06	67.8	35.8	7.14	17	22	4599-FP503
10	3/8"	1/2"-14	790H-06B08	72.5	40.5	7.14	18	27	4599-FP505
13	1/2"	3/8"-19	790H-08B06	74.9	36.9	9.93	22	22	4599-FP503-001
13	1/2"	1/2"-14	790H-08B08	77.4	39.4	9.93	22	27	4599-FP505
13	1/2"	5/8"-14	790H-08B10	82.1	44.1	9.93	22	30	4599-FP506
13	1/2"	3/4"-14	790H-08B12	82.1	44.1	9.93	26	32	4599-FP506
<b>790H Series</b>									
20	3/4"	3/4"-14	790H-12B12	86.9	43.9	15.88	28	32	4599-FP506
25	1"	1"-11	790H-16B16	101.7	44.7	20.65	36	41	4599-FP5008

*Couplings Are Manufactured From Plated Steel and Dimensions Are in Inches Unless Otherwise Specified*

# Metric, BSP and JIS Hose Couplings

Hose		Dash Size G	Coupling	A mm	B mm	D mm	Dia.E mm	L mm	K mm	Pusher 4599
D.N.	I.D.									
4	3/16"	1/4"-19	7903-03B04-100	57	38	37	2.77	14	19	4599-TP205
6	1/4"	1/4"-19	7903-04B04-100	61	35	37	3.96	17	19	4599-TP205
8	5/16"	3/8"-19	7903-05B06-100	67	39	38	5.56	17	22	4599-TP210
10	3/8"	3/8"-19	7903-06B06-100	72	40	38	7.14	17	22	4599-TP210
13	1/2"	1/2"-14	7903-08B08-100	80	42	42.5	9.93	22	27	4599-TP308
13	1/2"	5/8"-14	7903-08B10-100	80	42	44	9.93	22	30	4599-TP308
20	3/4"	3/4"-14	7903-12B12-100	98	55	59	15.88	30	32	4599-TP312
25	1"	1"-11	7903-16B16-100	116.5	59.5	66.5	20.65	40	41	4599-TP316
4	3/16"	1/4"-19	790H-03B04-100	57	38	37	2.77	14	19	4599-TP205
6	1/4"	1/4"-19	790H-04B04-100	61	35	37	3.96	17	19	4599-TP205
10	3/8"	3/8"-19	790H-06B06-100	72	40	38	7.14	17	22	4599-TP210
13	1/2"	1/2"-14	790H-08B08-100	80	42	42.5	9.93	22	27	4599-TP308
13	1/2"	5/8"-14	790H-08B10-100	80	42	44	9.93	22	30	4599-TP308
20	3/4"	3/4"-14	790H-12B12-100	98	55	59	15.88	30	32	4599-TP312
25	1"	1"-11	790H-16B16-100	116.5	59.5	66.5	20.65	40	41	4599-TP316

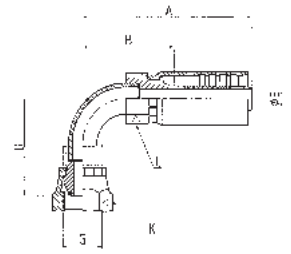

**Code B-100  
FEMALE SWIVEL WITH  
O-RING, 90° ELBOW -  
BSP THREAD**

Hose		Dash Size G	Coupling	A mm	B mm	D mm	Dia.E mm	L mm	K mm	Pusher 4599
D.N.	I.D.									
4	3/16"	1/4"-19	7903-03B04-300	69.2	50.2	20.4	2.77	14	19	4599-TP205
6	1/4"	1/4"-19	7903-04B04-300	72.3	46.3	20.4	3.96	17	19	4599-TP205
8	5/16"	3/8"-19	7903-05B06-300	77.6	49.6	20	5.56	17	22	4599-TP210
10	3/8"	3/8"-19	7903-06B06-300	82.4	50.4	20	7.14	17	22	4599-TP210
13	1/2"	1/2"-14	7903-08B08-300	91.8	53.8	22.6	9.93	22	27	4599-TP308
13	1/2"	5/8"-14	7903-08B10-300	92.8	54.8	23.6	9.93	22	30	4599-TP308
20	3/4"	3/4"-14	7903-12B12-300	111	68	29.8	15.88	30	32	4599-TP312
25	1"	1"-11	7903-16B16-300	127.3	70.3	32	20.65	40	41	4599-TP316
4	3/16"	1/4"-19	790H-03B04-300	69.2	50.2	20.4	2.77	14	19	4599-TP205
6	1/4"	1/4"-19	790H-04B04-300	72.3	46.3	20.4	3.96	17	19	4599-TP205
10	3/8"	3/8"-19	790H-06B06-300	82.4	50.4	20	7.14	17	22	4599-TP210
13	1/2"	1/2"-14	790H-08B08-300	91.8	53.8	22.6	9.93	22	27	4599-TP308
13	1/2"	5/8"-14	790H-08B10-300	92.8	54.8	23.6	9.93	22	30	4599-TP308
20	3/4"	3/4"-14	790H-12N12-300	111	68	29.8	15.88	30	32	4599-TP312
25	1"	1"-11	790H-16B16-300	127.3	70.3	32	20.65	40	41	4599-TP316

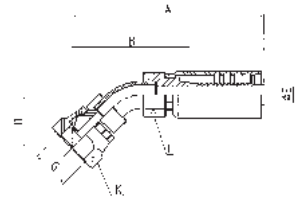

**CODE B-300 WITH  
O-RING, 45° ELBOW**

Couplings Are Manufactured From Plated Steel and Dimensions Are in Inches Unless Otherwise Specified



# Metric, BSP and JIS Hose Couplings

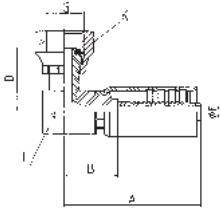

**CODE B-600 FEMALE SWIVEL WITH O-RING, BLOCK ELBOW 90°**

Hose		Dash Size G	Coupling	A mm	B mm	D mm	Dia.E mm	L mm	K mm	Pusher 4599
D.N.	I.D.									
3	1/8"	1/8"-28	*7903-02P02-600	26	12	19.3	2.08	12	14	4599-PC604
<b>*Without O-Ring</b>										
4	3/16"	1/4"-19	7903-03B04-600	44.3	25.3	23	2.77	14	18	4599-PC601
6	1/4"	1/4"-19	7903-04B04-600	48.2	22.4	23	3.96	14	18	4599-PC601
6	1/4"	3/8"-19	7903-04B06-600	48.4	22.4	24.7	3.96	14	21	4599-PC601
8	5/16"	3/8"-19	7903-05B06-600	52.7	24.7	27	5.56	18	21	4599-PC602
10	3/8"	3/8"-19	7903-06B06-600	57.5	25.5	27	7.14	18	21	4599-PC602
13	1/2"	1/2"-14	7903-08B08-600	64.8	26.8	28.5	9.93	22	25	4599-PC603
4	3/16"	1/4"-19	790H-03B04-600	44.3	25.3	23	2.77	14	18	4599-PC601
6	1/4"	1/4"-19	790H-04B04-600	48.4	22.4	23	3.96	14	18	4599-PC601
6	1/4"	3/8"-19	790H-04B06-600	48.4	22.4	24.7	3.96	14	21	4599-PC601
10	3/8"	3/8"-19	790H-06B06-600	57.5	25.5	27	7.14	18	21	4599-PC602
13	1/2"	1/2"-14	790H-08B08-600	64.8	26.8	28.5	9.98	22	25	4599-PC603

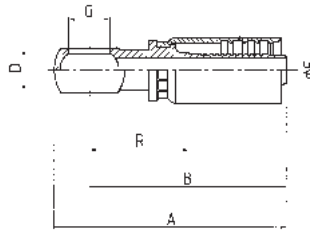

**CODE BM METRIC BANJO DIN 7642**

Hose		Dash Size G	Coupling	A mm	D mm	Dia.E mm	L mm	K mm	Pusher 4599
D.N.	I.D.								
4	3/16"	10	7903-03BM10	60.8	52.3	10	2.77	33.3	4599-BP005
4	3/16"	12	7903-03BM12	64.3	54.3	12	2.77	35.3	4599-BP004
6	1/4"	10	7903-04BM10	64.9	56.4	10	3.96	30.4	4599-BP005
6	1/4"	12	7903-04BM12	68.4	58.4	12	3.96	32.4	4599-BP004
6	1/4"	14	7903-04BM14	72.4	60.4	14	3.96	34.4	4599-BP001
6	1/4"	16	7903-04BM16	76.4	62.4	16	3.96	36.4	4599-BP002
8	5/16"	12	7903-05BM12	70.6	60.6	12	5.56	32.6	4599-BP004
8	5/16"	14	7903-05BM14	74.6	62.6	14	5.56	34.6	4599-BP001
8	5/16"	16	7903-05NM16	78.6	64.6	16	5.56	36.6	4599-BP002
8	5/16"	18	7903-05BM18	82.6	66.6	18	5.56	38.6	4599-BP003
10	3/8"	14	7903-06BM14	79.5	67.5	14	7.14	35.5	4599-BP001
10	3/8"	16	7903-06BM16	83.5	69.5	16	7.14	37.5	4599-BP002
10	3/8"	18	7903-06BM18	87.5	71.5	18	7.14	39.5	4599-BP003
13	1/2"	22	7903-08BM22	93.3	77.3	18	9.93	39.3	4599-BP002
13	1/2"	22	7903-08BM22	99.8	80.3	22	9.93	42.3	4599-BP006

*Couplings Are Manufactured From Plated Steel and Dimensions Are in Inches Unless Otherwise Specified*

# Metric, BSP and JIS Hose Couplings

Hose		Dash Size G	Coupling	A mm	D mm	Dia.E mm	L mm	K mm	R mm	Pusher 4599
D.N.	I.D.									
4	3/16"	M12x1.5	7903-03J12-060	55.2	36.2	2.77	14	17	6	4599-FP502
6	1/4"	M14x1.5	7903-04J14-080	59.2	33.2	3.96	14	17	8	4599-FP502
6	1/4"	M16x1.5	7903-04J16-100	60.0	34.7	3.96	17	19	10	4599-FP503
8	5/16"	M14x1.5	7903-05J14-080	61.5	33.5	5.56	17	17	8	4599-FP502
8	5/16"	M16x1.5	7903-05J16-100	63	35	5.56	17	19	10	4599-FP503
8	5/16"	M18x1.5	7903-05J18-120	63	35	5.56	17	22	12	4599-FP503
10	3/8"	M16x1.5	7903-06J16-100	67.8	35.8	7.14	17	19	10	4599-FP503
10	3/8"	M18x1.5	7903-06J18-120	67.8	35.8	7.14	17	22	12	4599-FP503
10	3/8"	M22x1.5	7903-06J22-150	72.5	40.5	7.14	22	27	15	4599-FP505
13	1/2"	M22x1.5	7903-08J22-150	77.4	39.4	9.93	22	27	15	4599-FP505
13	1/2"	M26x1.5	7903-08J26-180	80.5	42.5	9.93	27	32	18	4599-FP507
20	3/4"	M26x1.5	7903-12J26-180	85.3	42.3	15.88	30	32	18	4599-FP507
20	3/4"	M30x2	7903-12J30-220	88.7	45.7	15.88	30	36	22	4599-FP507
8	5/16"	M20x1.5	7903-05J20-120	64.7	36.7	5.56	18	24	12	4599-FP504
4	3/16"	M16x1.5	790H-03J16-080	56.7	37.7	2.77	14	19	8	4599-FP503
6	1/4"	M16x1.5	790H-04J16-080	60.7	34.7	3.96	14	19	8	4599-FP503
6	1/4"	M18x1.5	790H-04J18-100	60.7	34.7	3.96	17	22	10	4599-FP503
10	3/8"	M20x1.5	790H-06J20-120	69.5	37.5	7.14	18	24	12	4599-FP504
10	3/8"	M22x1.5	790H-06J22-140	72.5	40.5	7.14	21	27	14	4599-FP505
13	1/2"	M24x1.5	790H-08J24-160	82	44	9.93	22	30	16	4599-FP506
13	1/2"	M30x2	790H-08J30-200	83.9	45.9	9.93	30	36	20	4599-FP507
20	3/4"	M30x2	790H-12J30-200	88.7	45.7	15.88	30	36	20	4599-FP507
20	3/4"	M36x2	790H-12J36-250	90	47	15.88	36	41	25	4599-FP508
25	1"	M42x2	790H-16J42-300	101.6	44.6	20.65	38	50	30	4599-FP508

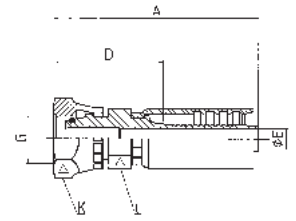

**Code J-XXO  
FEMALE SWIVEL  
O-RING, METRIC  
THREAD**

Hose		Dash Size G	Coupling	A mm	B mm	D mm	Dia.E mm	L mm	K mm	R mm	Pusher 4599
D.N.	I.D.										
4	3/16"	M12x1.5	7903-03J12-061	56	37	35	2.77	14	17	6	4599-TP205
6	1/4"	M14x1.5	7903-04J14-081	59	33	35	3.96	17	17	8	4599-TP205
6	1/4"	M16x1.5	7903-04J16-101	60.5	34.5	39	3.96	17	19	10	4599-TP206
8	5/16"	M14x1.5	7903-05J14-081	61.5	33.5	35	5.56	17	17	8	4599-TP205
8	5/16"	M16x1.5	7903-05J16-101	63	35	39	5.56	17	19	10	4599-TP206
10	3/8"	M18x1.5	7903-06J18-121	73	41	41.5	7.14	17	22	12	4599-TP210
13	1/2"	M22x1.5	7903-08J22-151	80	42	45	9.93	22	27	15	4599-TP308
13	1/2"	M26x1.5	7903-08J26-181	91	53	57.5	9.93	28	32	18	4599-TP312
20	3/4"	M26x1.5	7903-12J26-181	97.8	54.8	59.5	15.88	30	32	18	4599-TP312
20	3/4"	M30x2	7903-12J30-221	97.8	54.8	61	15.88	30	36	22	4599-TP312
8	5/16"	M20x1.5	7903-05J20-121	63	35	37	5.56	17	24	12	4599-TP206
4	3/16"	M16x1.5	790H-03J16-081	55	36	34	2.77	14	19	8	4599-TP205
6	1/4"	M18x1.5	790H-04J18-101	59	33	35.5	3.96	17	22	10	4599-TP205
10	3/8"	M20x1.5	790H-06J20-121	68	36	37	7.14	17	24	12	4599-TP206
10	3/8"	M22x1.5	790H-06J22-141	72	40	42	7.14	17	27	14	4599-TP210
13	1/2"	M24x1.5	790H-08J24-161	80	42	46.5	9.93	22	30	16	4599-TP308
20	3/4"	M30x2	790H-12J30-201	98	55	62.3	15.88	30	36	20	4599-TP312
20	3/4"	M36x2	790H-12J36-251	98	55	62.7	15.88	30	41	25	4599-TP312

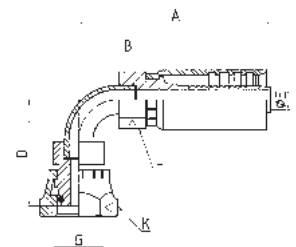

**CODE J-XX1 FEMALE  
SWIVEL O-RING -  
ELBOW 90° - METRIC  
THREAD**

Couplings Are Manufactured From Plated Steel and Dimensions Are in Inches Unless Otherwise Specified

# Metric, BSP and JIS Hose Couplings

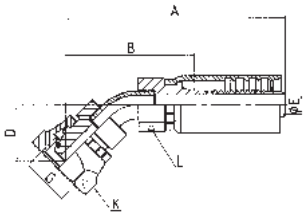

**CODE J-XX3  
FEMALE SWIVEL  
O-RING - ELBOW 45° -  
METRIC THREAD  
DKO 24° MALE CONE**

Hose		Dash Size G	Coupling	A mm	B mm	D mm	Dia.E mm	L mm	K mm	R mm	Pusher 4599
D.N.	I.D.										
4	3/16"	M12x1.5	7903-03J12-063	67	48	19.2	2.77	14	17	6	4599-TP205
6	1/4"	M14x1.5	7903-04J14-083	72	46	20	3.96	17	17	8	4599-TP205
6	1/4"	M16x1.5	7903-04J16-103	72.5	46.5	20.3	3.96	17	19	10	4599-TP206
8	5/16"	M16x1.5	7903-05J16-103	75	47	20.3	5.56	17	19	10	4599-TP206
10	3/8"	M18x1.5	7903-06J18-123	84.3	52.3	21.9	7.14	17	22	12	4599-TP210
13	1/2"	M22x1.5	7903-08J22-153	90.5	52.5	23	9.93	22	27	15	4599-TP308
13	1/2"	M26x1.5	7903-08J26-183	104	66	29	9.93	28	32	18	4599-TP312
20	3/4"	M26x1.5	7903-12J26-183	111	68	29.5	15.88	30	32	18	4599-TP312
20	3/4"	M30x2	7903-12J30-223	111	68	30.7	15.88	30	36	22	4599-TP312
8	5/16"	M20x1.5	7903-05J20-123	75	47	20	5.56	17	24	12	4599-TP206
4	3/16"	M16x1.5	790H-03J16-083	67	48	19	2.77	14	19	8	4599-TP205
6	1/4"	M18x1.5	790H-04J18-103	72	46	20	3.96	17	22	10	4599-TP205
10	3/8"	M20x1.5	790H-06J20-123	80	48	20	7.14	17	24	12	4599-TP206
10	3/8"	M22x1.5	790H-06J22-143	84	52	22.1	7.14	17	27	14	4599-TP210
13	1/2"	M24x1.5	790H-08J24-163	92	54	24	9.93	22	30	16	4599-TP308
20	3/4"	M30x2	790H-12J30-203	112	69	31.6	15.88	30	36	20	4599-TP312
20	3/4"	M36x2	790H-12J36-253	112	69	31.9	15.88	30	41	25	4599-TP312

*Couplings Are Manufactured From Plated Steel and Dimensions Are in Inches Unless Otherwise Specified*

# Metric, BSP and JIS Hose Couplings

Hose		Coupling	A mm	D mm	Dia.E mm	L mm	K mm	Pusher 4599
D.N.	I.D.							
3	1/8"	7903-02N04	43.8	29.8	2.08	13	4	4599-MP001
3	1/8"	7903-02N06	43.8	29.8	2.08	13	6	4599-MP001
3	1/8"	7903-02N08	45.8	31.8	2.08	13	8	4599-MP001
4	3/16"	7903-03N05	58.3	39.3	2.77	14	5	4599-MP501
4	3/16"	7903-03N06	58.3	39.3	2.77	14	6	4599-MP501
4	3/16"	7903-03N06-001	68.3	49.3	2.77	14	6	4599-MP523
4	3/16"	7903-03N08	60.3	41.3	2.77	14	8	4599-MP501
6	1/4"	7903-04N06	62.4	36.4	3.96	14	6	4599-MP501
6	1/4"	7903-04N08	64.4	38.4	3.96	14	8	4599-MP501
6	1/4"	7903-04N10	66.4	40.4	3.96	14	10	4599-MP501
6	1/4"	7903-04N12	69.4	43.4	3.96	17	12	4599-MP502
6	1/4"	7903-04N13	69.4	43.4	3.96	17	13	4599-MP502
8	5/16"	7903-05N08	68.6	40.6	5.56	17	8	4599-MP502
8	5/16"	7903-05N10	70.6	42.6	5.56	17	10	4599-MP502
8	5/16"	7903-05N10-001	80.6	52.6	5.56	17	10	4599-MP503-002
8	5/16"	7903-05N12	71.6	43.6	5.56	17	12	4599-MP502
8	5/16"	7903-05N12-001	78.6	50.6	5.56	19	12	4599-MP503-002
10	3/8"	7903-06N10	75.5	43.5	7.14	17	10	4599-MP502
10	3/8"	7903-06N12	76.5	44.5	7.14	17	12	4599-MP502
10	3/8"	7903-06N14	79.5	47.5	7.14	19	14	4599-MP503
10	3/8"	7903-06N16	82.5	50.5	7.14	22	16	4599-MP504
13	1/2"	7903-08N14	85.3	47.3	9.93	22	14	4599-MP504
13	1/2"	7903-08N15	85.3	47.3	9.93	22	15	4599-MP504
13	1/2"	7903-08N16	87.3	49.3	9.93	22	16	4599-MP504
13	1/2"	7903-08N18	88.3	50.3	9.93	22	18	4599-MP504
13	1/2"	7903-08N20	89.3	51.3	9.93	24	20	4599-MP505
20	3/4"	7903-12N20	94.6	51.6	15.88	30	20	4599-MP508
20	3/4"	7903-12N22	96.6	53.6	15.88	30	22	4599-MP508
20	3/4"	7903-12N25	98.6	55.6	15.88	30	25	4599-MP508
20	3/4"	7903-12N28	99.6	56.6	15.88	32	28	4599-MP509
25	1"	7903-16N25	110.3	53.3	20.65	36	25	4599-MP510
25	1"	7903-16N28	111.3	54.3	20.65	36	28	4599-MP510
25	1"	7903-16N30	112.3	55.3	20.65	40	30	4599-MP511
25	1"	7903-16N35	113.3	56.3	20.65	40	35	4599-MP511
4	3/16"	790H-03N05	58.3	39.3	2.77	14	5	4599-MP501
4	3/16"	790H-03N06	58.3	39.3	2.77	14	6	4599-MP501
4	3/16"	790H-03N06-001	68.3	49.3	2.77	14	6	4599-MP523
4	3/16"	790H-03N08	60.3	41.3	2.77	14	8	4599-MP501
6	1/4"	790H-04N06	62.4	36.4	3.96	14	6	4599-MP501
6	1/4"	790H-04N08	64.4	38.4	3.96	14	8	4599-MP501
6	1/4"	790H-04N10	66.4	40.4	3.96	14	10	4599-MP501
6	1/4"	790H-04N12	69.4	43.4	3.96	17	12	4599-MP502
6	1/4"	790H-04N13	69.4	43.4	3.96	17	13	4599-MP502
10	3/8"	790H-06N10	75.5	43.5	7.14	17	10	4599-MP502
10	3/8"	790H-06N12	76.5	44.5	7.14	17	12	4599-MP502
10	3/8"	790H-06N14	79.5	47.5	7.14	19	14	4599-MP503
10	3/8"	790H-06N16	82.5	50.5	7.14	22	16	4599-MP504
13	1/2"	790H-08N14	85.3	47.3	9.93	22	14	4599-MP504
13	1/2"	790H-08N15	85.3	47.3	9.93	22	15	4599-MP504
13	1/2"	790H-08N16	87.3	49.3	9.93	22	16	4599-MP504
13	1/2"	790H-08N18	88.3	50.3	9.93	22	18	4599-MP504
13	1/2"	790H-08N20	89.3	51.3	9.93	24	20	4599-MP505
20	3/4"	790H-12N20	94.6	51.6	15.88	30	20	4599-MP508
20	3/4"	790H-12N22	96.6	53.6	15.88	30	22	4599-MP508
20	3/4"	790H-12N25	98.6	55.6	15.88	30	25	4599-MP508
20	3/4"	790H-12N28	99.6	56.6	15.88	32	28	4599-MP509
25	1"	790H-16N25	110.3	53.3	20.65	36	25	4599-MP510
25	1"	790H-16N28	111.3	54.3	20.65	36	28	4599-MP510
25	1"	790H-16N30	112.3	55.3	20.65	40	30	4599-MP511
25	1"	790H-16N35	113.3	56.3	20.65	40	35	4599-MP511

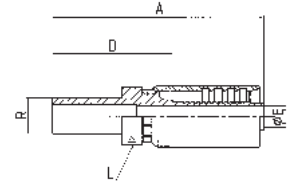

**CODE N  
METRIC STAND PIPE**

*Couplings Are Manufactured From Plated Steel and Dimensions Are in Inches Unless Otherwise Specified*

# Metric, BSP and JIS Hose Couplings

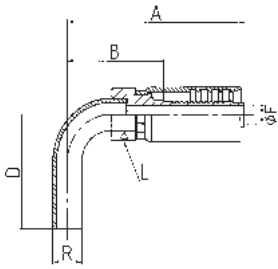

**CODE N-100  
METRIC STAND PIPE  
90° ELBOW**

Hose		Coupling	A mm	B mm	D mm	Dia.E mm	L mm	K mm	Pusher 4599
D.N.	I.D.								
3	1/8"	7903-02N06-100	38	24	32	2.08	13	6	4599-TP204
4	3/16"	7903-03N06-100	53	34	32	2.77	14	6	4599-TP204
4	3/16"	7903-03N08-100	55.8	36.8	34	2.77	14	8	4599-TP205
6	1/4"	7903-04N06-100	57	31	32	3.96	17	6	4599-TP204
6	1/4"	7903-04N08-100	59	33	34	3.96	17	8	4599-TP205
6	1/4"	7903-04N10-100	61	35	38	3.96	17	10	4599-TP206
8	5/16"	7903-05N08-100	61.2	33.2	34	5.56	17	8	4599-TP205
8	5/16"	7903-05N10-100	63.2	35.2	38	5.56	17	10	4599-TP206
8	5/16"	7903-05N12-100	67.2	39.2	43	5.56	17	12	4599-TP210
10	3/8"	7903-06N10-100	68	36	38	7.14	17	10	4599-TP206
10	3/8"	7903-06N12-100	72	40	43	7.14	17	12	4599-TP210
13	1/2"	7903-08N15-100	82	44	48	9.93	22	15	4599-TP310
13	1/2"	7903-08N16-100	84	46	54	9.93	22	16	4599-TP310
13	1/2"	7903-08N18-100	91	53	54	9.93	28	18	4599-TP312
4	3/16"	790H-03N06-100	53	34	32	2.77	14	6	4599-TP204
4	3/16"	790H-03N08-100	55.8	36.8	34	2.77	14	8	4599-TP205
6	1/4"	790H-04N06-100	57	31	32	3.96	17	6	4599-TP204
6	1/4"	790H-04N08-100	59	33	34	3.96	17	8	4599-TP205
6	1/4"	790H-04N10-100	61	35	38	3.96	17	10	4599-TP206
10	3/8"	790H-06N10-100	68	36	38	7.14	17	10	4599-TP206
10	3/8"	790H-06N12-100	72	40	43	7.14	17	12	4599-TP210
13	1/2"	790H-08N15-100	82	44	48	9.93	22	15	4599-TP310
13	1/2"	790H-08N16-100	84	46	54	9.93	22	16	4599-TP310
13	1/2"	790H-08N18-100	91	53	54	9.93	28	18	4599-TP312

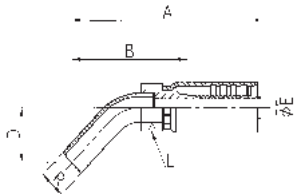

**CODE N-300 METRIC  
STAND PIPE, 45° ELBOW**

Hose		Coupling	A mm	B mm	D mm	Dia.E mm	L mm	K mm	Pusher 4599
D.N.	I.D.								
4	3/16"	7903-03N06-300	65.4	46.4	18.4	2.77	14	6	4599-TP204
4	3/16"	7903-03N08-300	66.8	47.8	19	2.77	14	8	4599-TP205
6	1/4"	7903-04N06-300	70	44	18.5	3.96	17	6	4599-TP204
6	1/4"	7903-04N08-300	71	45	19	3.96	17	8	4599-TP205
6	1/4"	7903-04N10-300	74	48	21.1	3.96	17	10	4599-TP206
8	5/16"	7903-05N10-300	76	48	21.1	5.56	17	10	4599-TP206
8	5/16"	7903-05N12-300	79.6	51.6	23	5.56	17	12	4599-TP210
10	3/8"	7903-06N12-300	84.5	52.5	23	7.14	17	12	4599-TP210
13	1/2"	7903-08N15-300	93	55	24.4	9.93	22	15	4599-TP310
13	1/2"	7903-08N16-300	97	59	27.8	9.93	22	16	4599-TP310
13	1/2"	7903-08N18-300	102	64	27	9.93	28	18	4599-TP312
4	3/16"	790H-03N06-300	65.4	46.4	18.4	2.77	14	6	4599-TP204
4	3/16"	790H-03N08-300	66.8	47.8	19	2.77	14	8	4599-TP205
6	1/4"	790H-04N06-300	70	44	18.5	3.96	17	6	4599-TP204
6	1/4"	790H-04N08-300	71	45	19	3.96	17	8	4599-TP205
6	1/4"	790H-04N10-300	74	48	21.1	3.96	17	10	4599-TP206
10	3/8"	790H-06N12-300	84.5	52.5	23	7.14	17	12	4599-TP210
13	1/2"	790H-08N15-300	93	55	24.4	9.93	22	15	4599-TP310
13	1/2"	790H-08N16-300	97	59	27.8	9.93	22	16	4599-TP310
13	1/2"	790H-08N18-300	102	64	27	9.93	28	18	4599-TP312

*Couplings Are Manufactured From Plated Steel and Dimensions Are in Inches Unless Otherwise Specified*

# Metric, BSP and JIS Hose Couplings

Hose		Dash Size G	Coupling	A mm	B mm	D mm	Dia.E mm	Pusher 4599
D.N.	I.D.							
3	1/8"	1/8"-28	7903-02Q02	33.3	19.3	2.08	13	4599-MP001
4	3/16"	1/8"-28	7903-03Q02	48.3	29.3	2.77	14	4599-MP501
4	3/16"	1/4"-19	7903-03Q04	51.5	32.5	2.77	17	4599-MP502
6	1/4"	1/8"-28	7903-04Q02	52.4	26.4	3.96	14	4599-MP501
6	1/4"	1/4"-19	7903-04Q04	55.6	29.6	3.96	17	4599-MP502
8	5/16"	1/4"-19	7903-05Q04	57.8	29.8	5.56	17	4599-MP502
8	5/16"	3/8"-19	7903-05Q06	60.3	32.3	5.56	22	4599-MP504
10	3/8"	3/8"-19	7903-06Q06	65.2	33.2	7.14	21	4599-MP504
10	3/8"	1/2"-14	7903-06Q08	70.3	38.3	7.14	26	4599-MP506
13	1/2"	1/2"-14	7903-08Q08	75.2	37.2	9.93	27	4599-MP506
13	1/2"	5/8"-14	7903-08Q10	75.8	37.8	9.93	30	4599-MP508
13	1/2"	3/4"-14	7903-08Q12	78.8	40.8	9.93	32	4599-MP509
20	3/4"	3/4"-14	7903-12Q12	83.7	40.7	15.88	32	4599-MP509
25	1"	1"-11	7903-16Q16	96.8	39.8	20.65	40	4599-MP511
4	3/16"	1/8"-28	790H-03Q02	48.3	29.3	2.77	14	4599-MP501
4	3/16"	1/4"-19	790H-03Q04	51.5	32.5	2.77	17	4599-MP502
6	1/4"	1/8"-28	790H-04Q02	52.4	26.4	3.96	14	4599-MP501
6	1/4"	1/4"-19	790H-04Q04	55.6	29.6	3.96	17	4599-MP502
10	3/8"	3/8"-19	790H-06Q06	65.2	33.2	7.14	21	4599-MP504
10	3/8"	1/2"-14	790H-06Q08	70.3	38.3	7.14	26	4599-MP506
13	1/2"	1/2"-14	790H-08Q08	75.2	37.2	9.93	27	4599-MP506
13	1/2"	5/8"-14	790H-08Q10	75.8	37.8	9.93	30	4599-MP508
13	1/2"	3/4"-14	790H-08Q12	78.8	40.8	9.93	32	4599-MP509
20	3/4"	3/4"-14	790H-12Q12	83.7	40.7	15.88	32	4599-MP509
25	1"	1"-11	790H-16Q16	96.8	39.8	20.65	40	4599-MP511

Couplings Are Manufactured From Plated Steel and Dimensions Are in Inches Unless Otherwise Specified

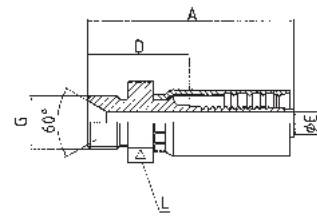

CODE Q BSP MALE RIGID

# Metric, BSP and JIS Hose Couplings

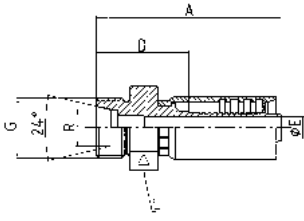

**CODE S  
METRIC MALE RIGID  
(DIN 3901-3902)**

Hose		Dash Size G	Coupling	A mm	D mm	Ø E mm	L mm	R mm	Pusher 4599
D.N.	I.D.								
4	3/16"	M12x1.5	7903-03SL06	50.3	31.3	2.77	17	6	4599-MP502
6	1/4"	M14x1.5	7903-04SL08	54.4	28.4	3.96	19	8	4599-MP503
6	1/4"	M16x1.5	7903-04SL10	55.4	29.4	3.96	20	10	4599-MP503
8	5/16"	M16x1.5	7903-05SL10	57.6	29.6	5.56	20	10	4599-MP503
8	5/16"	M18x1.5	7903-05SL12	58.6	30.6	5.56	22	12	4599-MP504
8	5/16"	M22x1.5	7903-05SL15	61.6	33.6	5.56	26	15	4599-MP506
10	3/8"	M16x1.5	7903-06SL10	62.5	30.5	7.14	20	10	4599-MP503
10	3/8"	M18x1.5	7903-06SL12	63.5	31.5	7.14	22	12	4599-MP504
10	3/8"	M22x1.5	7903-06SL15	66.5	34.5	7.14	26	15	4599-MP506
13	1/2"	M22x1.5	7903-08SL15	71.3	33.3	9.93	26	15	4599-MP506
13	1/2"	M26x1.5	7903-08SL18	71.8	33.8	9.93	32	18	4599-MP509
20	3/4"	M30x2	7903-12SL22	78.6	35.6	15.88	36	22	4599-MP510
25	1"	M36x2	7903-16SL28	90.3	33.3	20.65	40	28	4599-MP511
8	5/16"	M18x1.5	7903-05SS10	59.6	31.6	5.56	22	10	4599-MP504
8	5/16"	M20x1.5	7903-05SS12	61.6	33.6	5.56	24	12	4599-MP505
4	3/16"	M16x1.5	790H-03SS08	52.3	33.3	2.77	20	8	4599-MP503
6	1/4"	M16x1.5	790H-04SS08	56.4	30.4	3.96	20	8	4599-MP503
6	1/4"	M18x1.5	790H-04SS10	57.4	31.4	3.96	22	10	4599-MP504
6	1/4"	M20x1.5	790H-04SS12	59.4	33.4	3.96	22	12	4599-MP505
10	3/8"	M20x1.5	790H-06SS12	66.5	34.5	7.14	24	12	4599-MP505
10	3/8"	M22x1.5	790H-06SS14	68.5	36.5	7.14	26	14	4599-MP506
10	3/8"	M24x1.5	790H-06SS16	68.5	36.5	7.14	28	16	4599-MP507
13	1/2"	M24x1.5	790H-08SS16	73.3	35.3	9.93	28	16	4599-MP507
13	1/2"	M30x2	790H-08SS20	75.8	37.8	9.93	36	20	4599-MP510
20	3/4"	M36x2	790H-12SS25	82.6	39.6	15.88	40	25	4599-MP511
25	1"	M42x2	790H-16SS30	99.3	42.3	20.65	46	30	4599-MP512

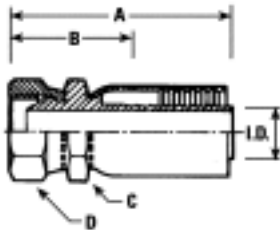

**JIS FEMALE SWIVEL 60°  
MALE CONE (PF)**

Hose I.D.	Thread (PF)	Part Number		Bore I.D.	Overall Length A	Cut Off B	Hex	
		Coupling	Pusher 4599				C	D
3/16	1/4-19	7903-03V44	FP413	.109	2.16	1.38	19	19
1/4	1/4-19	7903-04V44	FP414	.156	2.48	1.40	19	19
5/16	3/8-19	7903-05V46	FP416	.219	2.35	1.22	22	22
3/8	3/8-19	7903-06V46	FP416	.281	2.87	1.56	22	22
1/2	1/2-14	7903-08V48	FP418	.391	3.23	1.67	27	27
3/16	1/4-19	790H-03V44	FP413	.109	2.16	1.38	17	19
1/4	1/4-19	790H-04V44	FP414	.156	2.48	1.40	19	19
3/8	3/8-19	790H-06V46	FP416	.281	2.87	1.56	22	22
1/2	1/2-14	790H-08V48	FP418	.391	3.23	1.67	27	27

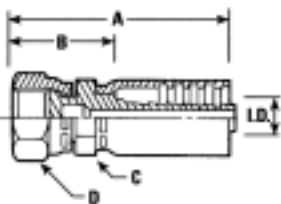

**JIS FEMALE SWIVEL 60°  
FEMALE CONE (PF)**

Hose I.D.	Thread (PF)	Part Number		Bore I.D.	Overall Length A	Cut Off B	Hex	
		Coupling	Pusher 4599				C	D
1/4	1/4-19	7903-04V04	FP414	.156	2.48	1-3/8	19	19
3/8	3/8-19	7903-06V06	FP416	.281	2.87	1-9/16	22	22
1/2	1/2-14	7903-08V08	FP418	.391	3.23	1-11/16	22	27
3/4	3/4-14	7903-12V12	FP422	.625	3.39	1-3/4	36	36
1/4	1/4-19	790H-04V04	FP414	.156	2.48	1-3/8	19	19
3/8	3/8-19	790H-06V06	FP416	.281	2.87	1-9/16	22	22
1/2	1/2-14	790H-08V08	FP418	.391	3.23	1-11/16	22	27
3/4	3/4-14	790H-12V12	FP422	.625	3.39	1-3/4	29	35

*Couplings Are Manufactured From Plated Steel and Dimensions Are in Inches Unless Otherwise Specified*

## Reusable Hose Couplings

# Reusable Hose Couplings

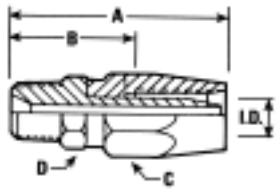

**MALE PIPE**

Hose I.D.	Pipe Thread	Part Number	Bore I.D.	Overall Length A	Cut Off B	Hex	
						C	D
3/16	1/8	3901-03102	.144	1.797	7/8	9/16	7/16
3/16	1/4	3901-03104	.144	1.985	1-1/16	9/16	9/16
1/4	1/4	3901-04104	.218	2.219	1-1/8	5/8	9/16
5/16	1/4	3901-05104	.266	2.406	1-3/16	3/4	9/16
5/16	3/8	3901-05106	.266	2.406	1-3/16	3/4	11/16
3/8	3/8	3901-06106	.323	2.515	1-1/4	13/16	11/16
1/2	3/8	3901-08106	.402	2.896	1-3/8	1	7/8
1/2	1/2	3901-08108	.438	3.078	1-9/16	1	7/8
3/4	3/4	3901-12112	.688	3.203	1-5/8	1-3/8	1-1/8
1	1	3901-16116	.875	3.501	1-3/4	1-5/8	1-3/8
1/2	3/8	390J-08106	.402	2.896	1-3/8	1-1/8	7/8
1/2	1/2	390J-08108	.438	3.078	1-9/16	1-1/8	7/8
3/4	3/4	390J-12112	.688	3.203	1-5/8	1-3/8	1-1/8
1	1	390J-16116	.875	3.501	1-3/4	1-5/8	1-3/8

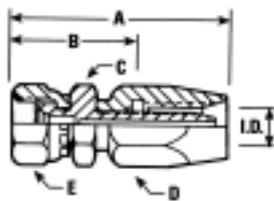

**JIC 37° SWIVEL**

Hose I.D.	Dash Size	Pipe Thread	Part Number	Bore I.D.	Overall Length A	Cut Off B	Hex		
							C	D	E
3/16	-4	7/16-20	3901-03544	.144	2.017	1-1/8	9/16	9/16	9/16
1/4	-4	7/16-20	3901-04544	.172	2.251	1-1/4	9/16	5/8	5/8
1/4	-5	1/2-20	3901-04545	.218	2.312	1-5/16	5/8	5/8	3/4
1/4	-6	9/16-18	3901-04546	.218	2.406	1-5/16	11/16	5/8	3/4
5/16	-6	9/16-18	3901-05546	.266	2.587	1-5/16	11/16	3/4	11/16
3/8	-6	9/16-18	3901-06546	.297	2.696	1-7/16	11/16	13/16	11/16
3/8	-8	3/4-16	3901-06548	.323	2.878	1-5/8	7/8	13/16	7/8
1/2	-8	3/4-16	3901-08548	.375	3.253	1-3/4	7/8	1	7/8
1/2	-10	7/8-14	3901-08550	.438	3.291	1-3/4	1	1	1
3/4	-12	1-1/16-12	3901-12552	.688	3.422	1-15/16	1-1/4	1-3/8	1-1/4
1	-16	1-5/16-12	3901-16556	.844	3.550	1-15/15	1-1/2	1-5/8	1-1/2
3/16	-4	7/16-20	390J-03544	.125	2.704	1-1/4	9/16	9/16	5/8
1/2	-8	3/4-16	390J-08548	.391	3.253	1-3/4	7/8	7/8	1-1/8
1/2	-10	7/8-14	390J-08550	.438	3.291	1-3/4	1	1-1/8	1
3/4	-12	1-1/16-12	390J-12552	.688	3.422	1-15/16	1-1/4	1-3/8	1-1/4
1	-16	1-5/16-12	390J-16556	.844	3.706	1-15/16	1-1/2	1-5/8	1-1/2

*JIC 37° and SAE 45° couplings are interchangeable on all sizes except -6 and -12 tube sizes*

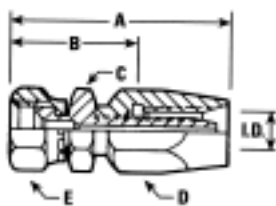

**45° SAE SWIVEL**

Hose I.D.	Dash Size	Pipe Thread	Part Number	Bore I.D.	Overall Length A	Cut Off B	Hex		
							C	D	E
1/8	-5	1/2-20	3901-02A05	.109	1.847	1-1/16	5/8	11/16	1/2
3/16	-4	7/16-20	3901-03544	.144	2.017	1-1/8	9/16	9/16	9/16
1/4	-4	7/16-20	3901-04544	.172	2.251	1-1/4	9/16	5/8	5/8
1/4	-5	1/2-20	3901-04545	.218	2.312	1-5/16	5/8	5/8	3/4
5/16	-6	5/8-18	3901-05A06	.266	2.637	1-3/8	3/4	3/4	3/4
3/8	-6	5/8-18	3901-06A06	.297	2.746	1-1/2	3/4	3/4	13/16
3/8	-8	3/4-16	3901-06548	.323	2.878	1-5/8	7/8	13/16	7/8
1/2	-8	3/4-16	3901-08548	.391	3.253	1-3/4	7/8	1	7/8
1/2	-10	7/8-14	3901-08550	.438	3.291	1-3/4	1	1	1

*Couplings Are Manufactured From Plated Steel and Dimensions Are in Inches Unless Otherwise Specified*



# Reusable Hose Couplings

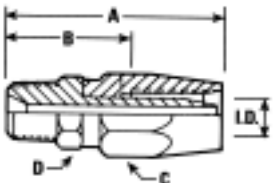

**MALE PIPE AISI 303  
SERIES STAINLESS STEEL**

Hose I.D.	Dash Size	Pipe Thread	Part Number	Bore I.D.	Overall Length A	Cut Off B	Hex	
							C	D
3/16	-	1/8	3908-03102	.144	1.797	7/8	9/16	7/16
3/16	-	1/4	3908-03104	.144	1.989	1-1/16	9/16	9/16
1/4	-	1/4	3908-04104	.218	2.219	1-1/8	5/8	9/16
5/16	-	1/4	3908-05105	.266	2.406	1-3/16	3/4	9/16
3/8	-	3/8	3908-06106	.323	2.515	1-1/4	13/16	11/16
1/2	-	1/2	3908-08108	.438	3.078	1-9/16	1	7/8
3/4	-	3/4	3908-12112	.688	3.203	1-5/8	1-3/8	1-1-8
1	-	1	3908-16116	.875	3.501	1-3/4	1-1/2	1-3/8

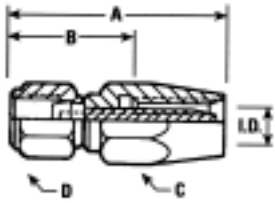

**JIC 37° SWIVEL AISI 303  
SERIES STAINLESS STEEL**

Hose I.D.	Dash Size	Pipe Thread	Part Number	Bore I.D.	Overall Length A	Cut Off B	Hex	
							C	D
3/16	-4	7/16-20	3908-03544	.144	1.844	15/16	9/16	9/16
1/4	-4	7/16-20	3908-04544	.172	2.560	1-1/2	5/8	9/16
1/4	-5	1/2-20	3908-04545	.218	2.139	1-1/16	5/8	5/8
5/16	-6	9/16-18	3908-05546	.266	2.375	1-1/8	3/4	11/16
3/8	-6	9/16-18	3908-06546	.297	2.696	1-7/16	1-3/16	11/16
3/8	-8	3/4-16	3908-06548	.323	2.608	1-5/16	13/16	7/8
1/5	-8	3/4-16	3908-08548	.383	3.838	2-5/16	1	7/8
1/2	-10	7/8-14	3908-08550	.438	3.038	1-1/2	1	1
3/4	-12	1-1/16-12	3908-12552	.609	4.093	2-1/2	1-3/8	1-1/4
1	-16	1-5/16-12	3908-16556	.875	4.312	2-9/16	1-1/2	1-1/2
3/16	-4	7/16-20	390K-03544	.186	2.450	1	5/8	9/16
1/2	-8	3/4-16	390K-08548	.437	3.838	2-5/16	1-1/8	7/8
1/2	-10	7/8-14	390K-08550	.438	3.038	1/2	1-1/8	1
3/4	-12	1-1/16-12	390K-12552	.688	4.250	2-11/16	1-3/8	1-1/4

JIC 37° and SAE 45° couplings are interchangeable on all sizes except -6 and -12 tube sizes

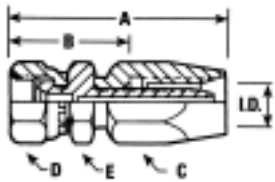

**JIC 37° FEMALE SWIVEL**

Hose I.D.	Thread	Part Number	Bore I.D.	Overall Length A	Cut Off B	Hex		
						C	D	E
3/16	7/16-20	3902-03544	.144	2.017	1-1/8	9/16	9/16	9/16
1/4	7/16-20	3902-04544	.170	2.246	1-3/8	5/8	5/8	11/16
1/4	1/2-20	3902-04545	.170	2.376	1-3/8	5/8	3/4	5/8
1/4	9/16-18	3902-04546	.170	2.34	1-3/8	5/8	3/4	11/16
5/16	1/2-20	3902-05545	.230	2.616	1-1/2	3/4	3/4	5/8
5/16	9/16-18	3902-05546	.230	2.585	1-1/2	3/4	3/4	5/8
3/8	9/16-18	3902-06546	.265	2.78	1-1/2	7/8	3/4	11/16
3/8	3/4-16	3902-06548	.265	2.854	1-1/2	7/8	15/16	7/8
1/2	9/16-18	3902-08546	.390	3.211	1-3/4	1-1/16	3/4	7/8
1/2	3/4-16	3902-08548	.390	3.242	1-3/4	1-1/16	15/16	7/8
3/4	1-1/16-12	3902-12552	.600	3.625	1-3/4	1-3/8	1-1/4	1-1/8

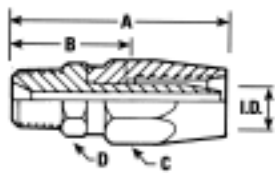

**MALE PIPE RIGID**

Hose I.D.	Thread	Part Number	Bore I.D.	Overall Length A	Cut Off B	Hex	
						C	D
3/16	1/4-18	3902-03104	.144	2.376	1-1/4	9/16	9/16
1/4	1/4-18	3902-04104	.170	2.15	1-1/4	5/8	9/16
5/16	1/4-18	3902-05104	.230	2.4	1-1/4	3/4	9/16
3/8	3/8-18	3902-06106	.265	2.595	1-3/4	7/8	11/16
1/2	1/2-14	3902-08108	.390	3.216	1-3/4	1-1/16	7/8
3/4	3/4-14	3902-12112	.600	3.406	1-3/4	1-3/8	1-1/8

Couplings Are Manufactured From Plated Steel and Dimensions Are in Inches Unless Otherwise Specified

# Reusable Hose Couplings

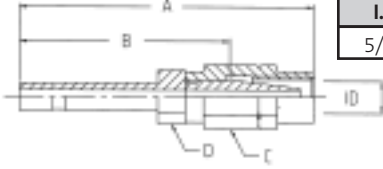

**METRIC STAND PIPE  
(Grease Hose Series)**

Hose I.D.	Tube O.D. (mm)	Part Number		Bore I.D.	Overall Length A	Cut Off B	Hex	
		Insert	Shell				C	D
5/32	6	7950-M4N06	7951-M4000	0.126	2.126	1-3/8	10	12

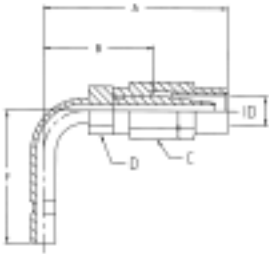

**METRIC STAND PIPE  
90° ELBOW  
(Grease Hose Series)**

Hose I.D.	Tube O.D. (mm)	Part Number		Bore I.D.	Overall Length A	Cut Off B	Hex		Drop F
		Insert	Shell				C	D	
5/32	6	7950-M4N06-10L	7951-M4000	0.126	1.772	1-1/16	10	12	1.811

*Couplings Are Manufactured From Plated Steel and Dimensions Are in Inches Unless Otherwise Specified*

# Brass Hose Couplings

## 390C Brass Hose Couplings

390C Series Brass Couplings Are Ordered by Selecting Components From the Parts Shown Below. Couplings Are Intended for Use With Hose Clamps or Brass Ferrules.

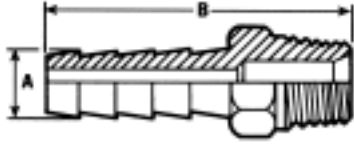

### NPT Male/Hose Barb

Hose I.D. A	NPT Thread	Part Number	Length B	Hex
3/16	1/8-27	3980-77320	1.36	7/16
3/16	1/4-18	3980-77420	1.54	9/16
1/4	1/8-27	3980-71720	1.58	1/2
1/4	1/4-18	3980-71820	1.76	9/16
1/4	3/8-18	3980-71920	1.76	11/16
3/8	1/4-18	3980-72020	1.76	9/16
3/8	3/8-27	3980-72120	1.76	11/16
3/8	1/2-24	3980-72220	1.97	7/8
1/2	3/8-18	3980-77520	1.76	11/16
1/2	1/2-14	3980-77620	1.97	7/8
1/2	3/4-14	3980-77920	1.97	1-1/16
3/4	1/2-14	3980-77720	2.19	7/8
3/4	3/4-14	3980-77820	2.19	1-1/16

### Construction

- Machined From 360 Alloy Brass
- Pipe Thread Manufactured to Dryseal Specifications
- 3/16 Inches ID Hose Barb Stems Contain Three Barbs; 1/4 Inches ID and Larger Contain Four Barbs



### Female Swivel/Hose Barb 37°JIC/ 45° SAE

Hose I.D. A	Tube O.D.	Thread	Part Number	Stem Length B	Nut Length C	Hex
3/16	1/4	7/16-20	3983-54416	1.02	.60	9/16
1/4	1/4	7/16-20	3983-54417	1.24	.60	9/16
1/2	1/2	3/4-16	3983-54806	1.34	.84	7/8
3/8	3/8	5/8-18	3983-A0606	1.27	.68	3/4
1/4	3/8	9/16-18	3983-54614	1.31	.69	11/16
3/8	3/8	9/16-18	3983-54615	1.31	.69	11/16

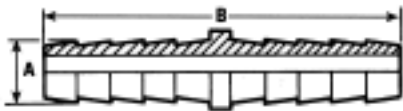

### Hose Splicer

Hose I.D. A	Part Number	Length B
1/4	3980-82920	2.03
3/8	3980-83020	2.06
1/2	3980-83120	2.06
3/4	3680-83220	2.50

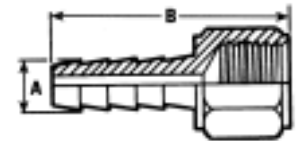

### NPT Female/Hose Barb

Hose I.D. A	NPT Thread	Part Number	Length B	Hex
3/16	1/4-18	3980-82320	1.44	5/8
1/4	1/4-18	3980-71520	1.66	5/8
3/8	1/4-18	3980-84420	1.66	5/8
3/8	3/8-18	3980-71620	1.66	3/4
1/2	3/8-18	3980-84520	1.66	3/4
1/2	1/2-14	3980-82420	1.66	15/16
3/4	3/4-14	3980-82520	2.19	1-3/16

### NPS Female Swivel/Hose Barb Ball Seat Type

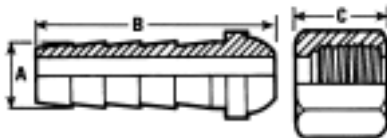

Hose I.D. A	NPS Thread	Part Number	Stem Length B	Nut Length C	Hex
3/16	1/4-18	3983-24412	1.17	.53	5/8
1/4	1/4-18	3983-24413	1.39	.53	5/8
3/8	3/8-18	3983-24605	1.45	.63	3/4
1/2	1/2-14	3983-24802	1.54	.69	15/16
3/4	3/4-14	3983-25202	1.69	.75	1-1/8

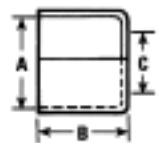

### Brass Ferrules

Hose I.D. A	Part Number	Ferrule ID A	Ferrule Lgth. B	Hose Size C
3/16	3981-30220	.400	.47	.27
1/4	3981-30320	.500	1.00	.34
3/8	3981-19120	.656	1.00	.44
1/2	3981-30420	.812	1.00	.63
3/4	3981-30520	1.150	.88	.88

### Garden Hose Fitting Set

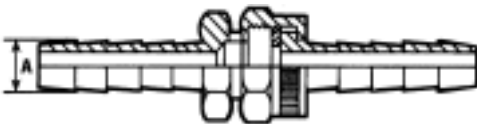

Hose I.D. (Both Fittings)	Thread	Part Number
1/2	3/4-11-1/2	3983-GHS01
3/4	3/4-11-1/2	3983-GHS02

Dimensions Are in Inches Unless Otherwise Specified.  
\*Contact Customer Support for 390C Series Swaging Pusher Recommendations.

# Adapters

## Adapters



**Male Pipe/  
Female Pipe  
Swivel**

Size	Part Number	Thread	
		Male	Female
1/8-1/8	3A01-02A02	1/8NPT	1/8 1/8NPSM
1/8-1/4	3A01-02A04	1/8 NPT	1/4 NPSM
1/4-1/4	3A01-04A04	1/4 NPT	1/4 NPSM
1/4-3/8	3A01-04A06	1/4NPT	3/8 NPSM
3/8-1/4	3A01-06A04	3/8NPT	1/4 NPSM
3/8-3/8	3A01-06A06	3/8NPT	3/8 NPSM
3/8-1/2	3A01-06A08	3/8NPT	1/2 NPSM
1/2-3/8	3A01-08A06	1/2 NPT	3/8NPSM
1/2-1/2	3A01-08A08	1/2 NPT	1/2NPSM
1/2-3/4	3A01-08A12	1/2 NPT	3/4 NPSM
3/4-1/2	3A01-12A08	3/4NPT	1/2 NPSM
3/4-3/4	3A01-12A12	3/4NPT	3/4 NPSM
3/4-1	3A01-12A16	3/4NPT	1 NPSM
1-3/4	3A01-16A12	1NPT	3/4 NPSM
1-1	3A01-16A16	1NPT	1NPSM
		<b>Female</b>	<b>Female</b>
1/8-1/8	3A02-02A02	1/8NPT	1/8 NPSM
1/4-1/4	3A02-04A04	1/4 NPT	1/4 NPSM
3/8-3/8	3A02-06A06	3/8 NPT	3/8NPSM
1/2-1/2	3A02-08A08	1/2NPT	1/2 NPSM
3/4-3/4	3A02-12A12	3/4NPT	3/4NPSM
1-3/4	3A02-16A12	1 NPT	3/4NPSM
1-1	3A02-16A16	1 NPT	1NPSM
		<b>Male</b>	<b>Female</b>
1/8-1/8	3A03-02A02	1/8 NPT	1/8NPSM
1/4-1/4	3A03-04A04	1/4NPT	1/4NPSM
1/4-3/8	3A03-04A06	1/4NPT	3/8 NPSM
3/8-1/4	3A03-04A04	3/8NPT	1/4NPSM
3/8-3/8	3A03-06A06	3/8NPT	3/8 NPSM
3/8-1/2	3A03-06A08	3/8 NPT	1/2NPSM
1/2-3/8	3A03-08A06	1/2 NPT	3/8 NPSM
1/2-1/2	3A03-08A08	1/2 NPT	1/2 NPSM
1/2-3/4	3A03-08A12	1/2 NPT	3/4NPSM
3/4-1/2	3A03-12A08	3/4NPT	1/2NPSM
3/4-3/4	3A03-12A12	3/4 NPT	3/4 NPSM
1-3/4	3A03-16A12	1 NPT	3/4NPSM
1-1	3A03-16A16	1 NPT	1 NPSM
		<b>Female</b>	<b>Female</b>
1/8-1/8	3A04-02A02	1/8NPT	1/8 NPSM
1/4-1/4	3A04-04A04	1/4 NPT	1/4NPSM
3/8-3/8	3A04-06A06	3/8NPT	3/8NPSM
1/2-1/2	3A04-08A08	1/2 NPT	1/2NPSM
3/4-3/4	3A04-12A12	3/4NPT	3/4NPSM
1-3/4	3A04-16A12	1 NPT	3/4NPSM
1-1	3A04-16A16	1NPT	1 NPSM
		<b>Male</b>	<b>Female</b>
1/8-1/8	3A05-02A02	1/8NPT	1/8NPSM
1/4-1/4	3A05-04A04	1/4NPT	1/4NPSM
3/8-3/8	3A05-06A06	3/8NPT	3/8NPSM
1/2-3/8	3A05-08A06	1/2NPT	3/8 NPSM
1/2-1/2	3A05-08A08	1/2NPT	1/2 NPSM
3/4-1/2	3A05-12A08	3/4 NPT	1/2 NPSM
3/4-3/4	3A05-12A12	3/4 NPT	3/4NPSM
3/4-1	3A05-12A16	3/4 NPT	1NPSM
1-3/4	3A05-16A12	1 NPT	3/4 NPSM
1-1	3A05-16A16	1 NPT	1NPSM



**Female Pipe/  
Female Pipe  
Swivel**

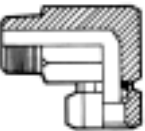

**Male Pipe/90°  
Elbow Female  
Pipe Swivel**

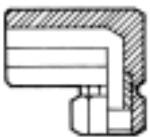

**Female Pipe/90°  
Elbow Female  
Pipe Swivel**



**Male Pipe/45°  
Elbow Female  
Pipe Swivel**

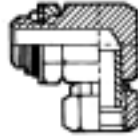

**Straight Thread O-  
Ring/90° Elbow  
Female Pipe Swivel  
(Includes O-Ring)**



**Straight Thread  
O-Ring/45° Elbow/  
Female Pipe Swivel  
(Includes O-Ring)**



**Straight Thread  
O-Ring/Female  
Pipe Swivel  
(Includes O-Ring)**

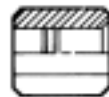

**Female O-Ring  
Boss/Female Pipe**



**Male Pipe/Male  
JIC 37° Flare**



**Female O-Ring Boss**

Size	Part Number	Thread	
		Male	Female
-4-1/4	3A06-04A04	7/16-20	1/4 NPSM
-6-1/4	3A06-06A04	9/16-18	1/4 NPSM
-6-3/8	3A06-06A06	9/16-18	3/8NPSM
-8-3/8	3A06-08A06	3/4-16	3/8 NPSM
-8-1/2	3A06-08A08	3/84-16	1/2 NPSM
-8-3/4	3A06-08A12	3/4-16	3/4 NPSM
-10-1/2	3A06-10A08	7/8-14	1/2 NPSM
-10-3/4	3A06-10A12	7/8-14	3/4NPSM
-12-3/4	3A06-12A12	1-1/16-12	3/4NPSM
		<b>Male</b>	<b>Female</b>
-4-1/4	3A07-04A04	7/16-20	1/4 NPSM
-6-3/8	3A07-06A06	9/16-18	3/8 NPSM
-8-3/8	3A07-08A06	3/4-16	3/8NPSM
-8-1/2	3A07-08A08	3/4-16	1/2 NPSM
-8-3/4	3A07-08A12	3/4-16	3/4NPSM
-10-1/2	3A07-10A08	7/8-14	1/2 NPSM
-12-3/4	3A07-12A12	1-1/16-12	3/4NPSM
		<b>Male</b>	<b>Female</b>
-4-1/4	3A08-04A04	7/16-20	1/4NPSM
-6-1/4	3A08-06A04	9/16-18	1/4NPSM
-6-3/8	3A08-06A06	9/16-18	3/8 NPSM
-8-3/8	3A08-08A06	3/4-16	3/8NPSM
-8-1/2	3A08-08A08	3/4-16	1/2 NPSM
-8-3/4	3A08-08A12	3/4-16	3/4NPSM
-10-3/8	3A08-10A06	7/8-14	3/8 NPSM
-10-1/2	3A08-10A08	7/8-14	1/2 NPSM
-10-3/4	3A08-10A12	7/8-14	3/4NPSM
-12-3/4	3A08-12A12	1-1/16-12	3/4NPSM
-14-3/4	3A08-14A12	1-3/16-12	3/4 NPSM
-16-1	3A08-16A16	1-5/16-12	1NPSM
		<b>Female</b>	<b>Female</b>
-8-3/8	3A12-08A06	3/4-16	3/8 NPT
-8-1/2	3A12-08A08	3/4-16	1/2NPT
-10-3/8	3A12-10A06	7/8-14	3/8NPT
-10-1/2	3A12-10A08	7/8-14	1/2NPT
		<b>Male</b>	<b>Male</b>
1/8-4	3A09-02A04	1/8NPT	7/16-20
1/4-4	3A09-04A04	1/4NPT	7/16-20
1/4-5	3A09-06A05	1/4NPT	1/2-20
1/4-6	3A09-04A06	1/4NPT	9/16-18
3/8-6	3A09-06A06	3/8NPT	9/16-18
3/8-8	3A09-06A08	3/8 NPT	3/4-16
3/8-10	3A09-06A10	3/8 NPT	7/8-14
1/2-6	3A09-08A06	1/2 NPT	9/16-18
1/2-8	3A09-08A08	1/2 NPT	3/4-16
1/2-10	3A09-08A10	1/2 NPT	7/8-14
3/4-10	3A09-12A10	3/4NPT	7/8-14
3/4-12	3A09-12A12	3/4NPT	1-1/16-12
3/4-14	3A09-12A14	3/4NPT	1-3/16-12
3/4-16	3A09-12A16	3/4NPT	1-5/16-12
1-16	3A09-16A16	1NPT	1-5/16-12
		<b>Female</b>	<b>Female</b>
-8-8	3A11-08A08	3/4-16	3/4-16
-10-10	3A11-10A10	7/8-14	7/8-14

# Adapters



**Male Pipe/90° Elbow Male JIC 37° Flare**

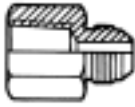

**Female Pipe/Male JIC 37° Flare**



**Male Pipe/Female Pipe**



**Male JIC 37° Flare/Male JIC 37° Flare**



**Male Pipe/Male Pipe**

Size	Part Number	Thread	
		Male	JIC 37° Male
1/4-4	3A16-04A04	1/4NPTF	7/16-20
1/4-6	3A16-04A06	1/4 NPTF	9/16-18
3/8-6	3A16-06A06	3/8 NPTF	9/16-18
1/2-6	3A16-08A06	1/2NPTF	9/16-18
3/8-8	3A16-06A08	3/8NPTF	3/4-16
1/2-8	3A16-08A08	1/2 NPTF	3/4-16
3/4-12	3A16-12A12	3/4NPTF	1-1/16-12
3/4-16	3A16-12A16	3/4 NPTF	1-5/16-12
1-16	3A16-16A16	1 NPTF	1-5/16-12
		Female	Male
1/4-4	3A20-04A04	1/4NPTF	7/16-20
1/4-5	3A20-04A05	1/4 NPTF	1/2-20
1/4-6	3A20-04A06	1/4 NPTF	9/16-18
3/8-6	3A20-06A06	3/8 NPTF	9/16-18
3/8-8	3A20-06A08	3/8NPTF	3/4-16
1/2-8	3A20-08A08	1/2NPTF	3/4-16
3/4-12	3A20-12A12	3/4NPTF	1-1/16-12
1-16	3A20-16A16	1 NPTF	1-5/16-12
		Male	Female
1/2-1/4	3A40-08A04	1/2 NPT	–
1/2-3/8	3A40-08A06	1/2NPT	3/8NPT
3/4-3/8	3A40-12A06	3/4NPT	3/8 NPT
3/4-1/2	3A40-12A08	3/4NPT	1/2NPT
1-1/2	3A40-16A08	1NPT	1/2NPT
1-3/4	3A40-16A12	1NPT	3/4 NPT
		Male	Male
-4-4	3A21-04A04	7/16-20	7/16-20
-5-5	3A21-05A05	1/2-20	1/2-20
-6-6	3A21-06A06	9/16-18	9/16-18
-8-8	3A21-08A08	3/4-16	3/4-16
-10-10	3A21-10A10	7/8-14	7/8-14
-12-12	3A21-12A12	1-1/16-12	1-1/16-12
-14-14	3A21-14A14	1-3/16-12	1-3/16-12
-16-16	3A21-16A16	1-5/16-12	1-5/16-12
		Male	Male
1/8-1/8	3A38-02A02	1/8NPTF	1/8NPTF
1/4-1/4	3A38-04A04	1/4NPTF	1/4NPTF
3/8-3/8	3A38-06A06	3/8NPTF	3/8NPTF
1/2-1/2	3A38-08A08	1/2NPTF	1/2 NPTF
3/4-3/4	3A38-12A12	3/4NPTF	3/4 NPTF
1-1	3A38-16A16	1 NPTF	1 NPTF



**45° Elbow Male**



**Side Tee Male**

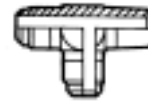

**Run Tee Male**



**Bulkhead Tube Elbow 90° (Nut Included)**



**Bulkhead Tube Elbow 45° (Nut Included)**



**Bulkhead-Tube Union (Nut Included)**



**Straight Connector (Includes O-Ring)**

Size	Part Number	Thread	Pipe NPTF
1/8-4	3A22-02A04	7/16-20	1/8
1/4-6	3A22-04A06	9/16-18	1/4
3/8-8	3A22-06A08	3/4-16	3/8
1/2-10	3A22-08A10	7/8-14	1/2
3/4-12	3A22-12A12	1-1/16-12	3/4
1-16	3A22-16A16	1-5/16-12	1
1/8-4	3A49-02A04	7/16-20	1/8
1/4-6	3A49-04A06	9/16-18	1/4
3/8-8	3A49-06A08	3/4-16	3/8
1/2-10	3A49-08A10	7/8-14	1/2
3/4-12	3A49-12A12	1-1/16-12	3/4
1-16	3A49-16A16	1-5/16-12	1
1/8-4	3A50-02A04	7/16-20	1/8
1/4-6	3A50-04A06	9/16-18	1/4
3/8-8	3A50-06A08	3/4-16	3/8
1/2-10	3A50-08A10	7/8-14	1/2
3/4-12	3A50-12A12	1-1/16-12	3/4
1-16	3A50-16A16	1-5/16-12	1
-4-4	3A52-04A04	7/16-20	–
-6-6	3A52-06A06	9/16-18	–
-8-8	3A52-08A08	3/4-16	–
-10-10	3A52-10A10	7/8-14	–
-12-12	3A52-12A12	1-1/16-12	–
-16-16	3A52-16A16	1-5/16-12	–
-4-4	3A53-04A04	7/16-20	–
-6-6	3A53-06A06	9/16-18	–
-8-8	3A53-08A08	3/4-16	–
-10-10	3A53-10A10	7/8-14	–
-12-12	3A53-12A12	1-1/16-12	–
-16-16	3A53-16A16	1-5/16-12	–
-4-4	3A51-04A04	7/16-20	–
-6-6	3A51-05A05	9/16-8	–
-8-8	3A51-08A08	3/4-16	–
-10-10	3A51-10A10	7/8-14	–
-12-12	3A51-12A12	1-1/16-12	–
-16-16	3A51-16A16	1-5/16-12	–
-4-4	3A17-04A04	7/16-20	–
-6-6	3A17-06A06	9/16-18	–
-8-8	3A17-08A08	3/4-16	–
-10-10	3A17-10A10	7/8-14	–
-12-12	3A17-12A12	1-1/16-12	–
-16-16	3A17-16A16	1-5/16-12	–

### Hose Coupling Swaging Machines and Tools

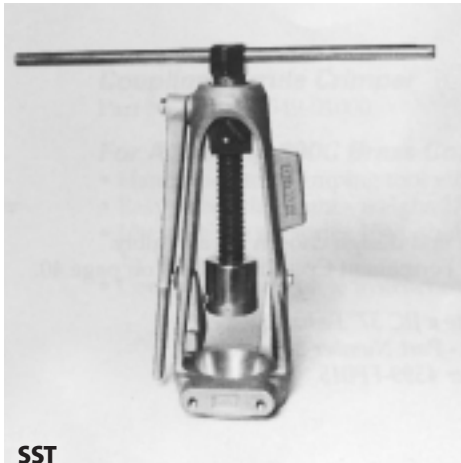

SST

#### Designed to Attach Synflex Permanent Couplings to Synflex Hose

- Synflex swaging equipment produces smooth, uniform coupling surfaces, without raised edges or ridges common in other coupling methods.
- Complete range of coupling swaging pushers and dies, up to -16 size are ordered separately.

#### SST

Part Number: 4530-01002

- Portable hand operated machine for field assembly
- Frame can be attached to bench vise or directly to a table with separate mounting bracket
- Weight: 8 lbs (3.6kg)

#### Carrying Case for Portable Hand Swager SST

Part No: 45J0-04300

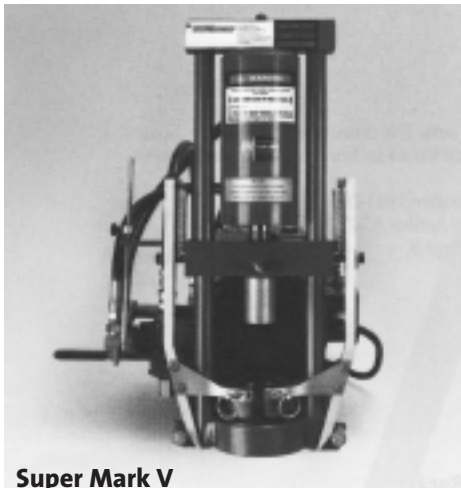

Super Mark V

#### Super Mark V

- Automatic coupling swaging action
- Capable of 10-second assembly cycle time
- Weight: 120 lbs.(54.4kg)

Part Number : 4530-00553

- 1HP, 60HZ, 115/208/203V Single Phase Motor

Part Number : 4530-00556

- 1HP, 50HZ, 240V Single Phase Motor
- CE Mark

#### Mark IX

- Fully automatic; opens dies to release completed coupling assembly
- Fast actuation; capable of 5-second cycle time
- Three power supply options for a broad range of production needs
- Weight: 131 lbs (59.4kg). (option 1&2)

##### Option 1

1HP, 60Hz, 115/208/230V Single Phase Motor; Medium Duty;  
Part Number: 4530-00950

##### Option 2

1HP, 60 Hz, 230/460 V Three Phase Motor; Medium Duty;  
Part Number: 4530-00951

##### Option 3

For Heavy Duty, continuous high speed production assembly, the Mark IX (a) can be equipped with a high capacity power unit (b)

(a) Mark IX swaging machine without standard power supply.  
Part Number: 4530-00954

(b) Commercial duty hydraulic power unit with 5HP three phase 230/460 volt motor, 5 gallon reservoir; 4.1 GPM displacement.  
Part Number: 453C-00020

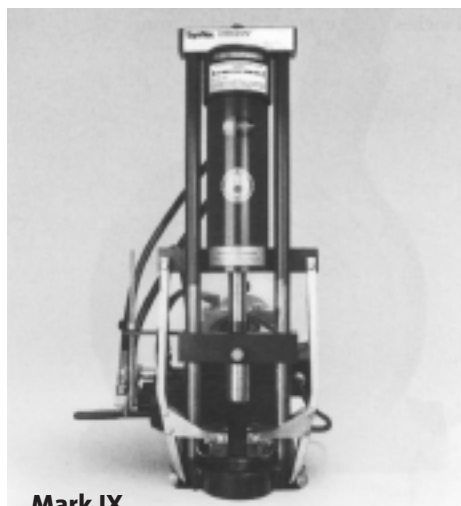

Mark IX

## Pusher and Die Tools for Synflex Swaging Machines



### Pushers

- Pusher selection is based on coupling end design chosen from assembly. Pusher part numbers are listed in the Permanent Couplings Tables on page 7.3.

*Example: To attach a 3/8 inch ID hose to a JIC 37° Female Swivel coupling with a -6 thread size Part Number 3903-06546, page 7.6, use pusher Part Number 4599-FP015*



### Dies

- Swaging dies are applied in paired sets. Die selection is based on hose series and size. Die part numbers are listed in hose specification charts.

*Example: To attach coupling Part Number 3903-06546 to a series 3130 3/8 inch ID hose, die Part Number 4540-306 is selected from the table at the top of page 1.4.*



### Die Pusher Storage Rack

- Rack holds 12 pushers and 8 dies. Welded 16 gauge steel frame can be wall mounted or used on bench top. Rack is 19 inches wide; 22-1/2 inches high; extends 3 inches from mounting surface.

Part Number: 45J0-03401

# Hose Coupling Ferrule Crimper

## Coupling Ferrule Crimper

Part Number: 4549-01000

### For Attaching 390C Brass Coupling to Synflex 3630

- Hand operated crimping tool with removable handle
- Easy to bench mount – weighs 27 lbs.(12kg)
- Use with die set series 4548, sold separately by hose size.
- Comes with complete instructions

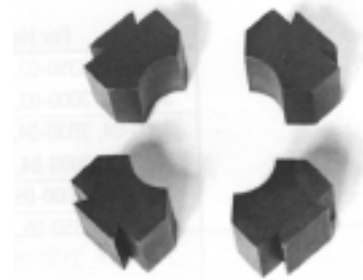

### Dies for Coupling Ferrule Crimper

Die set contains (4) mating segments

Hose I. D. (in)	Synflex Part Number 4548
3 / 16	03750
1 / 4	05000
3 / 8	06000
1 / 2	07500
1 / 4	*

\* Crimp Specification For –12, 3/4" I. D. Hose: Use a power crimper with a flat crimp die that will have a minimum gap between dies when crimped to 1.095 ± .010



**Hose Accessories**

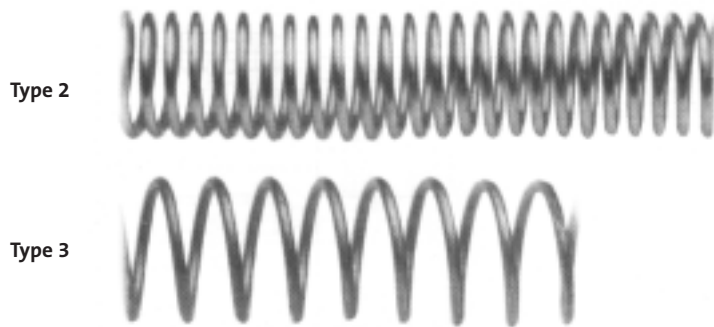

**Overall Spring Guards**

- For assembly abrasion protection and support
- Protects hose from kinking
- Order in multiples of 25-ft (7.6m) lengths

For Hose Part Number	Standard Length ft	Type 2 Part Number	Type 3 Part Number
3800-03, 3R30-03, 3130-03, 3000-03, 31B0-03, 37B0-03, 37AL-03	25	4521-50000	-
3800-04, 3R30-04, 3440-04, 3130-04, 3V10-03, 3000-04, 37AL-04, 30CT-04	25	4521-51000	4521-02000
3000-05	25	4521-84000	4521-03000
3800-06, 3440-06, 34PW-06, 3130-06, 3130-05, 31B0-06, 37B0-06, 37AL-05, 37AL-06, 30CT-05, 30CT-06	25	4521-53000	4521-04000
3800-08, 3R30-08, 3440-08, 34PW-08, 3130-08, 3000-08, 37B0-08, 37AL-08, 30CT-08	25	4521-54000	4521-05000
3000-12	25	4521-55000	-
3000-16	10	4521-56000	-
34PW-10, 3440-10, 3130-12, 37B0-12	25	4521-88000	-
3R80-03, 31B0-04, 37B0-04	25	4521-83000	-
3V10-04, 3130-05	25	4521-84000	-
3R80-06	25	4521-58000	-
3R80-08	25	4521-59000	4521-10000
3R80-12	25	4521-60000	-
3R80-16	10	4521-61000	-
3R80-04, 3000-06, 31B0-05, 37B0-05	25	4521-57000	-

## Hose Accessories

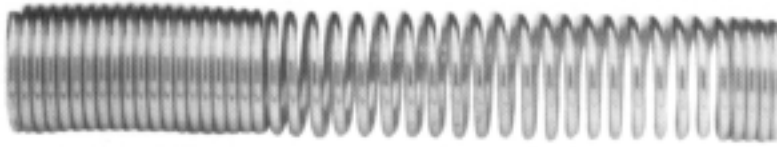

### Hose and Spring Guards

- For fitting-to-hose interface protection
- Made from high-grade spring steel wire.
- Hose guards provide protection against kinking at couplings.
- Spring-type guards hand screw to the coupling shell to form a single unit assembly.

For Hose Part Number	Part Number
3R30-04, 3800-04, 3130-04, 3000-04, 31B0-04, 37B0-04, 37AL-04, 30CT-04	4521-91005
3130-05, 3000-05, 31B0-05, 37B0-05, 37AL-05, 30CT-05	4521-90005
3R30-06, 3R80-04	4521-92005
3R30-03, 3800-03, 3130-03, 3000-03, 37AL-03	4521-AG004
3800-06, 3130-06, 3000-06, 31B0-06, 37B0-06, 37AL-06, 30CT-06	4521-94005
3R80-06	4521-AA005



### Plastic Protective Coil Sleeve

- For fitting-to-hose interface protection
- A convenient and economical way to protect hose and tubing lines.
- Can be installed after hose assembly is made.
- Lightweight
- Order in multiples of 20-ft (6m) lengths.

For Hose Part Number	Part Number
3130-02	4554-04000
3R30-03, 3800-03, 3130-03, 3630-03, 3000-03, 37AL-03	4554-06000
3R30-04, 3130-04, 3630-03, 3000-04, 37AL-04, 30CT-04	4554-07000
3R30-06, 3800-04, 3440-04, 34PW-04, 3130-05, 3R80-03, 3000-05, 37AL-05, 30CT-05	4554-08000
3440-06, 34PW-06, 3130-06, 3R80-04, 3000-06, 37AL-06, 30CT-06	4554-10000
3R30-08, 3800-06, 3130-08, 3R80-06, 3000-08, 37AL-08, 30CT-08	4554-12000
3800-08, 3440-08, 34PW-08, 3R80-08	4554-14000
3130-12, 3R80-12, 3440-10, 34PW-10, 3630-12, 3000-12	4554-16000
3440-12, 34PW-12, 3000-16	4554-19000
3R80-16, 3440-16, 34PW-16	4554-22000

## Hose Accessories



### Vinyl Hose Guards

- For assembly abrasion protection and support
- Use when a non-metallic guard is required. Guard assembly may require the use of lubricant on the hose
- Available in 50-ft (15.2m) lengths
- Note: 4513-05 100-ft (30m) lengths

For Hose Part Number	Part Number	Guard I.D.	Guard O.D.
3R30-03, 34GW-03, 3130-03, 3800-03, 3000-03, 37AL-03, 31B0-03, 37B0-03	4513-03000	7/16	9/16
3R30-04, 3440-04, 34PW-04, 37B0-04 3130-04, 3R80-03, 3000-04, 37AL-04, 30CT-04, 31B0-04,	4513-04000	9/16	13/16
3R30-06, 3440-06, 34PW-06, 3130-06, 3R80-04, 3160-06, 3000-06, 37AL-06, 30CT-06, 31B0-06, 37B0-06	4513-05000	11/16	1-1/16
3R80-06, 3000-08	4513-06000	15/16	1-13/14
3R80-08, 3800-08	4513-10000	15/16	1-5/16
3130-12, 3R80-12	4513-11000	1-3/16	1-11/16



### Molded Black PVC Hose guards

- For assembly abrasion protection and support
- Protects against abrasion and physical abuse when a stiffer, non-metallic guard is preferred
- For hand-held use, keeps hose from kinking at fitting

For Hose Part Number	Part Number	Guard I.D.	Length
		A	L
30CT-04, 3R30-04, 3000-04, 3630-04, 3130-04, 3580-04, 31NO-05, 3R80-03, 3800-04, 37AL-04	45J0-04801	.55	6.0
30CT-06, 3R30-06, 3000-06, 3630-06, 3130-06, 3580-06, 31NO-06, 3R80-04, 3800-06, 37AL-06	45J0-04802	.69	7.0

# Accessories



### Hand-Held Hose Cutter

Part Number 4523-04006  
 • A handy tool for cutting Synflex hose 1/8 inch to 1/2 inch in diameter. Blades are replaceable. Vinyl cushioned grips.

### Replacement Blade

Part Number 4523-04005

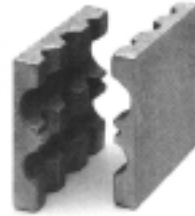

### Vise Blocks

Part Number 4504-00000  
 • For 3/16 inch through 1/2 inch I.D. hose

Part Number 4504-01000  
 • For 3/4 inch and 1 inch I.D. hose. Use in making assemblies.



### Swage Lubricant

Part Number 4545-01001

• A lubricant especially for use in assembly of Synflex reusable and permanently attached stainless steel couplings.



### Insertion Depth Marker

Part Number 45J0-04603



### Clamps

• Plastic – covered clamps to secure hose



### Twin-Line Hose Separation Tool

Part Number 4574-01000

• Designed for separating Twin-Line hose

### Replacement Blades

(set of 10)  
 Part Number 4574-02000

### Dies

Part Number 4574-03000-XXX



### Multi-Line Hose Separation Tool

Part Number: 4573-00000

• Designed for Separation of 3, 4 and 5 line hoses.

### Replacement Blades

Part Number 4573-01000

For Hose Part Number	Part Number	Bolt Hose Size (in)
3130-02	45J0-00201	13/32
3130-03, 3630-03, 3800-03, 3000-03, 37AL-03	45J0-00202	13/32
3130-04, 3630-04, 3800-04, 3000-04, 37AL-04, 30CT-04, 31B0-04, 37B0-04	45J0-00204	13/32
3R80-03, 3130-05, 3000-05, 37AL-05, 30CT-05, 31B0-05, 37B0-05	45J0-00203	13/32
3R80-04	45J0-00205	13/32
3130-06, 3630-06, 3800-06, 3000-06, 37AL-06, 30CT-06, 31B0-06, 37B0-06	45J0-00206	13/32
3R80-06, 3130-08, 3630-08, 3800-08, 3000-08, 37AL-08, 30CT-08, 37B0-08	45J0-00207	13/32
3R80-08	45J0-00208	13/32
3130-12, 3000-12, 37B0-12	45J0-00209	13/32
3R80-12, 3630-12	45J0-00210	17/32
3000-16	45J0-00211	17/32
3R80-16	45J0-00212	17/32